

Link-S - Smart Controller

Lighting Control

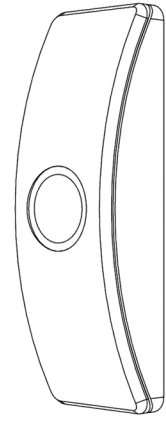

INSTALLATION INSTRUCTIONS

Product Code:
SE795990

IMPORTANT: Please read these instructions before commencing installation and retain for future reference.

Components

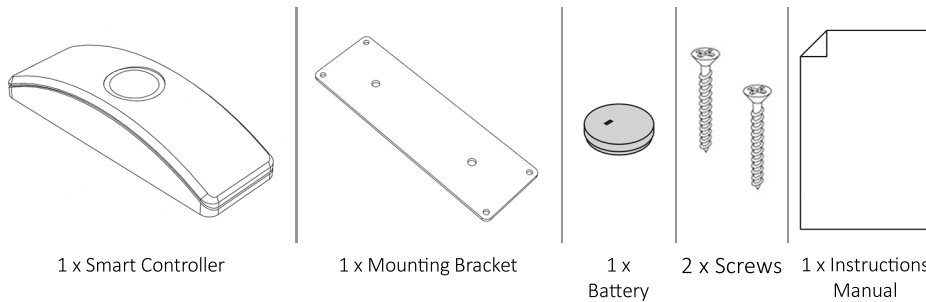

Tools Required

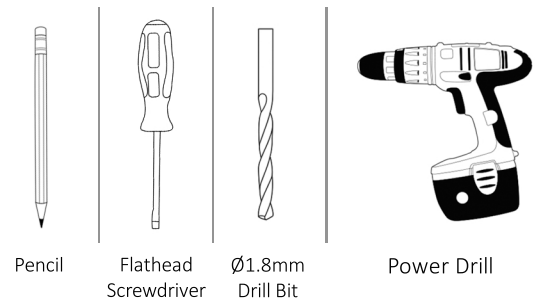

Important Safety Information

Please read these instructions carefully before attempting to install this product. It is advisable to keep these instructions in a safe place for future reference.

- Install on smooth flat surface(s) only.
- This product is IP20 Rated.

These products must not be modified, if any modification are made, it may invalidate the warranty and may render the product unsafe.

Insert The Battery

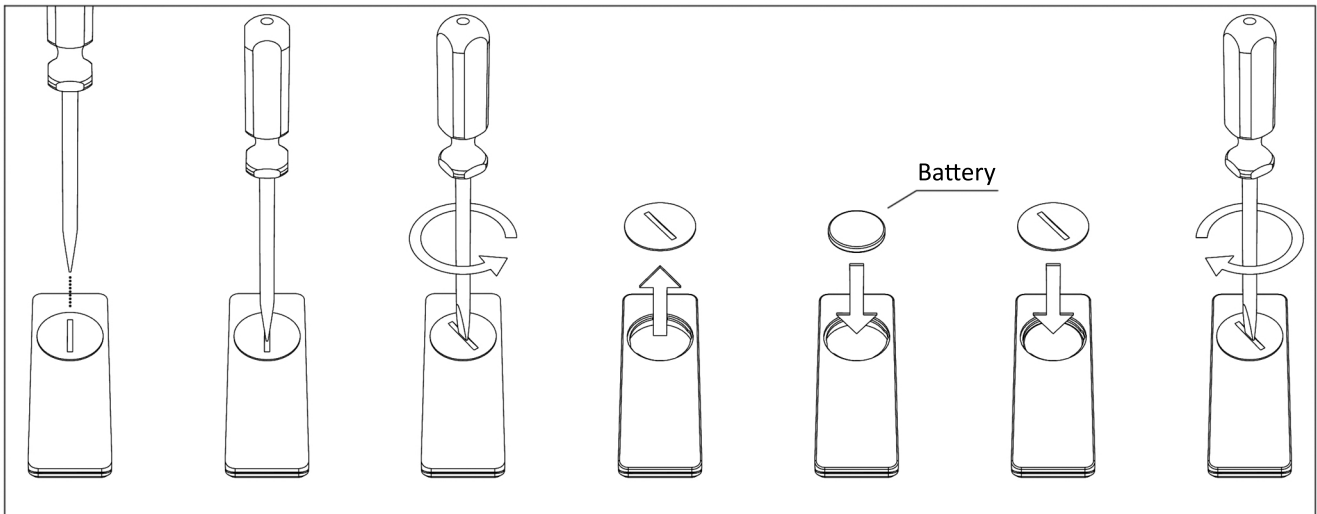

Waste Electrical & Electronic Equipment (WEEE)

The symbol on the product, or on the document accompanying the product, the crossed out wheellie bin symbol, indicates that this product may not be treated as household waste. Instead it shall be handed over to the applicable collection point for the recycling of electrical and electronic waste.



RoHS Compliant ✓ **CE**

Sensio House, Unit 7, Speedwell Road, Whitwood, Castleford, West Yorkshire, WF10 5PY

www.sensio.co.uk

Technical drawings for illustration purposes only, Sensio has the right to change any information without prior notice.

Installation

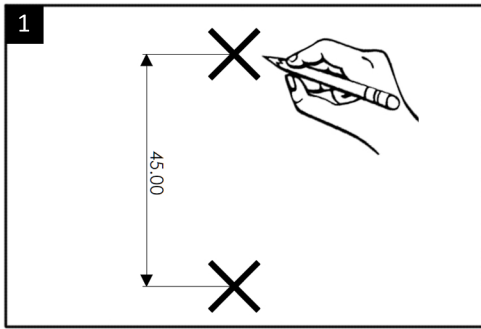

1 Mark out the desired location for the mounting plate and proceed to drill the holes using a $\varnothing 1.8\text{mm}$ drill bit.

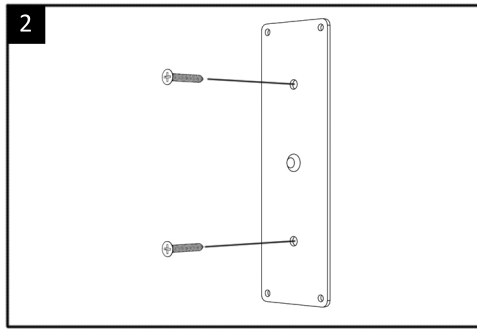

2 Attach the mounting plate to the wall by inserting the screws.

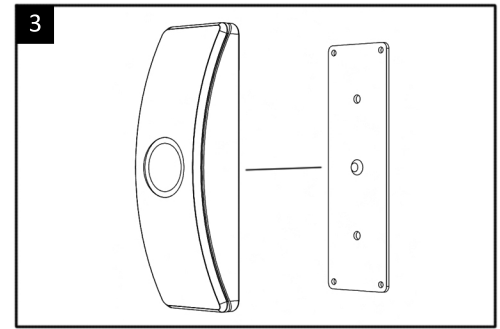

3 Attach the controller to the mounting plate.
Note: The controller is magnetic.

Connect The Smart Controller With A Sensio DuoFlex Receiver

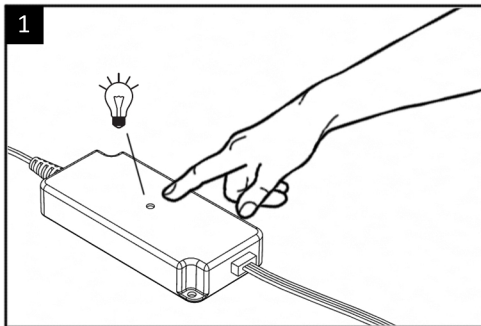

1 Press the pairing button on the receiver. It will light up blue once pressed.

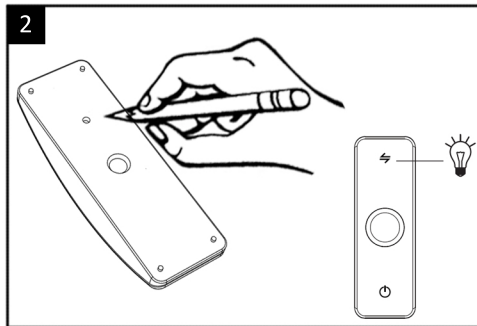

2 Using a narrow item, push the button on the back of the controller. The icon at the top of the controller will light up after the button has been pressed.

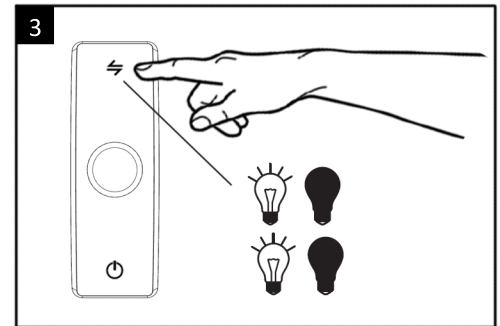

3 Proceed to press the upper half of the controller until the light flashes several times. Once complete, the controller will be paired with the receiver.

Connect The Smart Controller With A Sensio Dimming Receiver

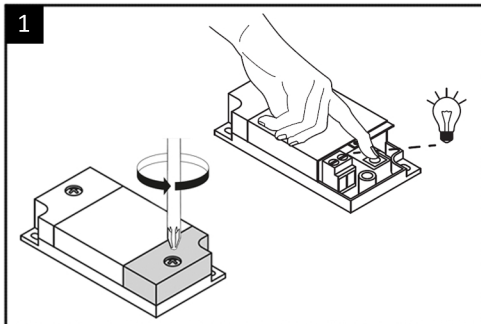

1 Unscrew the end cap to expose the button located underneath and press it. The button will light up blue once pressed.

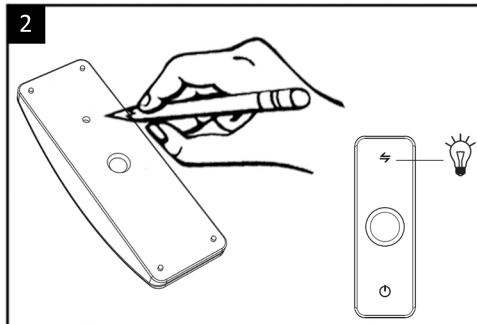

2 Using a narrow object, push the button on the back of the controller. The icon at the top of the remote will light up after the button has been pressed.

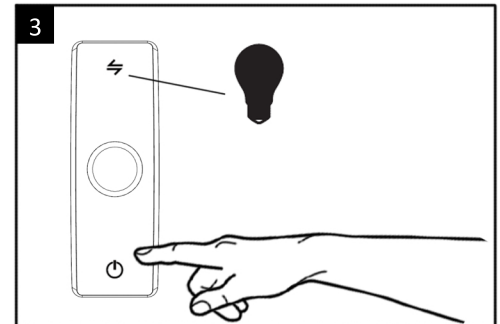

3 Proceed to press the lower half of the controller until the light switches off. Once complete, the controller will be paired with the receiver.

Maintenance & Care

- To keep the finish of this product, wipe over with soft cloth periodically.
- Do not use harsh chemical solvents, this may dis-colour or damage the finish.

Operating With A Duo-flex Receiver

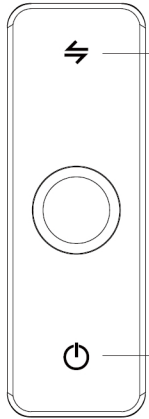

- Adjusting Colour Temperature** (While light is on)
- Short press (1 Sec) to adjust colour temperature in a loop of cool white - natural white - warm white - natural white
 - Long press (>1 Sec) to adjust colour temperature gradually. Colour adjustment stops when cool white or warm white has been reached.
- On/Off**
- Short press (1 Sec) to turn on/off.
 - Long press (>1 Sec) to dim gradually. Dimming stops when the darkest or brightest level has been reached.

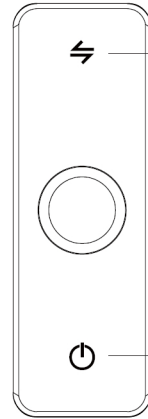

Operating With A Dimming Receiver

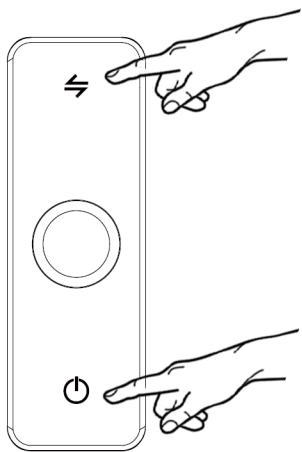

- Dimming** (While light is on)
- Short press (1 Sec) for the darkest setting. Short press again for the lightest setting
 - Long press (>1 Sec) to dim gradually. Dimming stops when the darkest or brightest level has been reached.
- On/Off**
- Short press (1 Sec) to turn on/off.

PIR Function





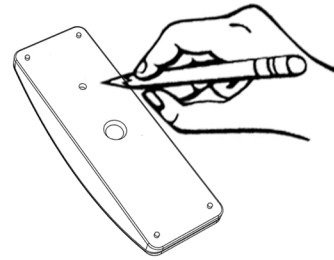

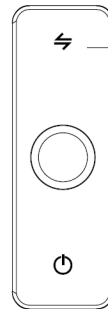

- Turn PIR Sensor On**
Press and hold both buttons simultaneously until the light at the top of the controller flashes five times.
-   x5
- Turn PIR Sensor Off**
Press and hold both buttons simultaneously until the light at the top of the controller flashes once.
- 



- PIR Timer**
Using a narrow object, press the button for (1 Sec) to cycle through the time settings.



-   x 1 Time - PIR sensor will remain on for 16 seconds if no motion is detected.
-   x 2 Time - PIR sensor will remain on for 3 minutes if no motion is detected.
-   x 3 Time - PIR sensor will remain on for 10 minutes if no motion is detected.

Maintenance & Care

- To keep the finish of this product, wipe over with soft cloth periodically.
- Do not use harsh chemical solvents, this may dis-colour or damage the finish.

Technical Information

PIR Sensor Range

Top View

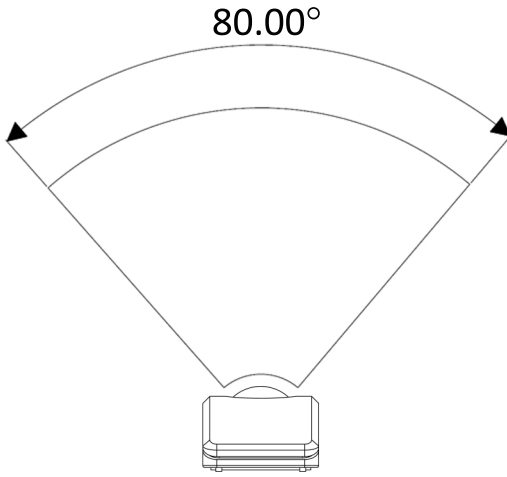

Side View

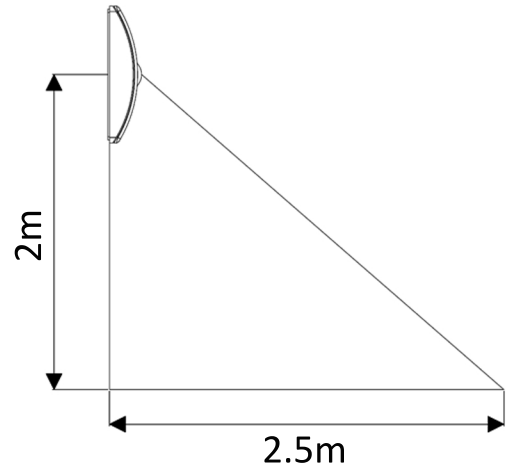

PIR Activation

To activate the PIR sensor, three conditions have to be satisfied at the same time.

1. The PIR function must be turned on.
2. Environmental illuminance <40lux
3. 10 minutes after manually turning off the light by the on/off button on the controller.

Sleep Mode of The PIR Function

PIR Sensor will enter sleep mode if:

1. The PIR function is turned off.
2. Environmental illuminance >150LUX
3. Turning on the light by the On/Off button on the controller or dimming/adjusting colour temperature.

Hysteresis Graph of PIR and Photocell

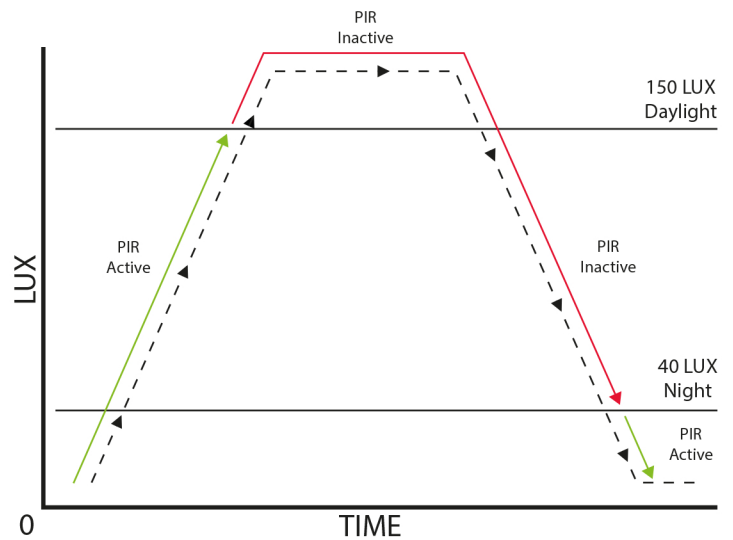

Maintenance & Care

- To keep the finish of this product, wipe over with soft cloth periodically.
- Do not use harsh chemical solvents, this may dis-colour or damage the finish.