

12V

HD 24V

SE40516

LED Swipe/Cabinet Sensor Switch



Specification:

Wattage: 24-48W
Voltage: 12V/24V ■ ■

Dimensions

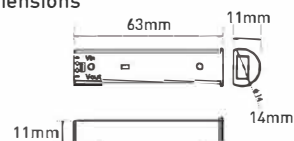

Detection Range: 5cm-10cm
Cable Length: 2.5m with 6 port JB4 connector
Maximum of 5 individual cable connections per sensor block

Bistable

When the target object is in the detecting range less than 1 second, the lamp function will turn the lamp on/off. When the target object is in the detecting range more than one second, the lamp will dim down until the object is out of the detecting range. When the target object is in the detecting range more than 1 second again, the lamp will dim up until the object is out of the detecting range.

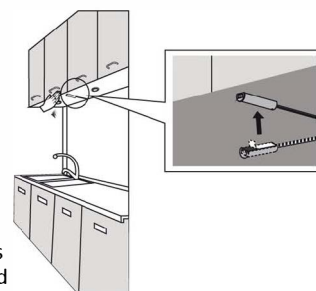

Monostable

1, If mounted inside a cabinet, open the door and the lights turn on.
2, Close the door the lights turn off.

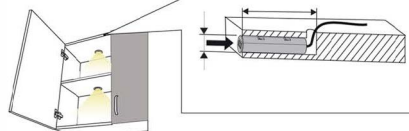

Function Set

1, Connect with the power supply.
2, Push the switch, to change between each of the functions.

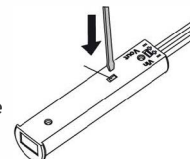

Installation:

Connect the live sensor wire (A) to the drivers distributor block.
Connect the sensors second wire (B) to the 6 way distributor block provided.
All additional lights need to be connected to the sensors remaining 5 ports from the distributor (see wire C). Includes double sided 3M pad.

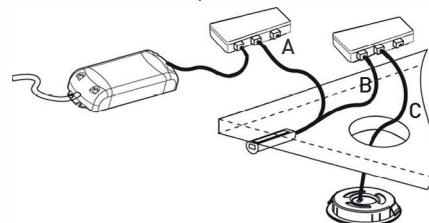

Key Selling Points:

- Can be used with 12V & 24V products (without an integrated sensor)
- Works as an on/off switch for these fittings
- Two functions of the sensor:
 - Mount inside a cabinet – open door to activate light
 - Mount under cabinet – lights are activated when a hand passes before the sensor or dimmed when hand held there for longer
- 5-10cm detection range, so unwanted detection is not a problem

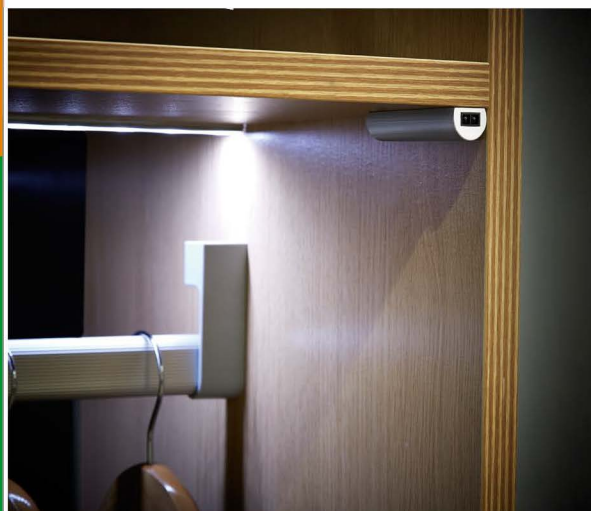

sensio[®]
furniture lighting solutions