

INSTALLATION  
INSTRUCTIONS

1 x TITON  
COB LED  
TRIANGLE LIGHT

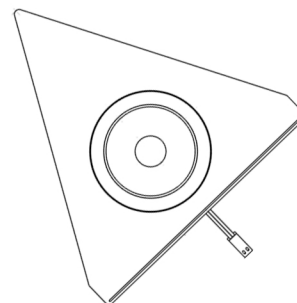

**CODE: SE21390C0/C2/C3 & SE21390W0/W2/W3**

**IMPORTANT:** Please read these instructions before commencing installation and retain for future reference.

**Components**

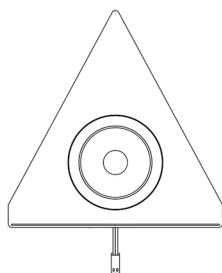

1 x LED Light



2 x Screws

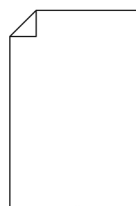

1 x instructions

**Tools required**

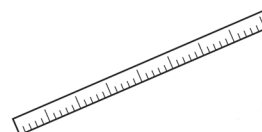

Ruler



Pencil



Screwdriver



Ø8mm



Power Drill

**Important Safety Information**

Please read these instructions carefully before attempting to install this product. It is advisable to keep these instructions in a safe place for future reference.

We recommend that you consult a qualified electrician. All electrical installation must be carried out in accordance with current IEE wiring regulations (BS7671).

These products must not be modified, if any modification are made, it may invalidate the warranty and may render the product unsafe. These LED lights operate low voltage (24V).

Do not wire the individual LED light fittings directly to the mains. This product should be used indoors only.

- If in doubt installation must be carried out by a qualified electrician.
- Install on smooth flat surface(s) only.
- Do not exceed or stretch the cable length of each LED wire.

Rated input	Power	ta
24VDC	3W	-20°C~35°C (-4~95°F)

**Safety Instructions**

1. Before commencing installation or maintenance, isolate the main electrical supply for the appropriate circuit at the fuse board.
2. This product is only suitable for connecting to a 220-240VDC 50Hz supply with use of an appropriate driver.
3. The lights should be mounted onto a secure surface.
4. Position the lights where they will not be exposed to steam or splashes
5. Suitable for furniture lighting.
6. When the lamp expires the fitting must be replaced

**Waste Electrical & Electronic Equipment (WEEE)**

The symbol on the product, or on the document accompanying the product, the crossed out wheellie bin symbol, indicates that this product may not be treated as household waste. Instead it shall be handed over to the applicable collection point for the recycling of electrical and electronic waste.



**RoHS**  
Compliant ✓



## Installation

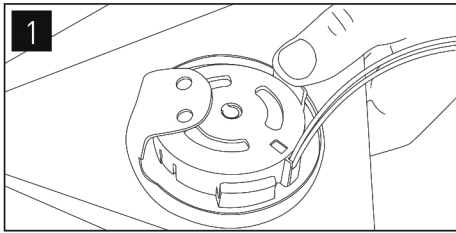

1 If the light fitting is attached to the housing then push on the clips on the LED light to release the unit from the triangular housing.

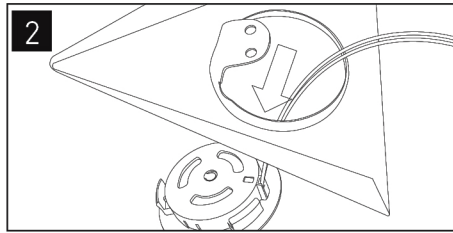

2 Carefully push the LED light fitting through so that the unit and cables are completely free from the triangle housing. You now have two separate parts – the housing and the COB LED light.

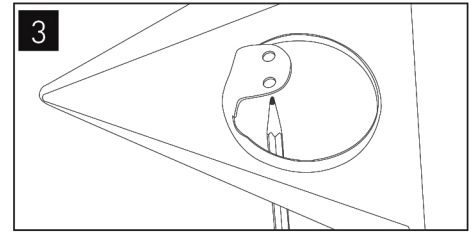

3 Mark the positions of the fixing holes in the desired position underneath the cabinet unit. If needed create an 8mm hole towards the back of the cabinet for the wire to feed through to the driver.

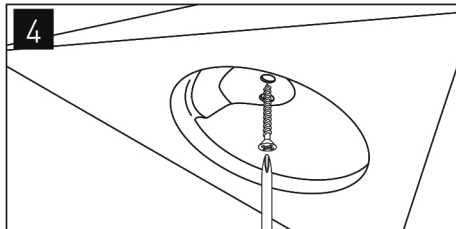

4 Screw the housing bracket to the underside of the cabinet.

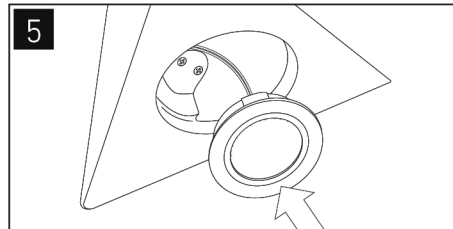

5 When the bracket is secured, re-insert the LED inner unit back into the triangle casing. Push until it clicks into place.

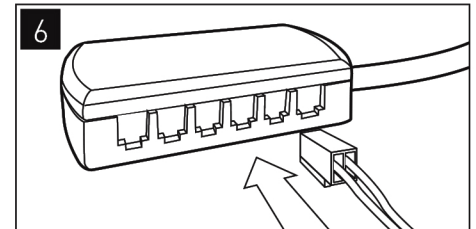

6 Plug the white connector on the end of the cable into the appropriate driver distribution block. Beware not to exceed the wattage - this will be displayed on the driver and on the light fitting it will display the wattage requirement.

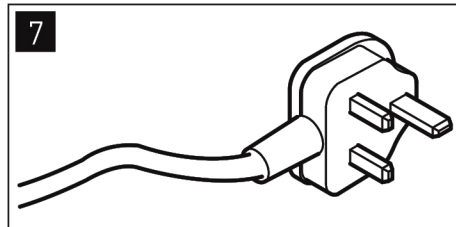

7 Finally wire the LED driver to the mains supply or 13Amp plug top. The power supply can be turned back on.

## Maintenance & Care

- Ensure that the power is disconnected prior to cleaning.
- To keep the finish of this product, wipe over with a soft cloth periodically.
- Do not use harsh chemical solvents, this may dis-colour or damage the finish.
- Clean the socket with a damp cloth and mild detergent, dry immediately.