

INSTALLATION
INSTRUCTIONS

1 x SENSIO SOUND ILLUMINATED LED BLUETOOTH™ SPEAKER

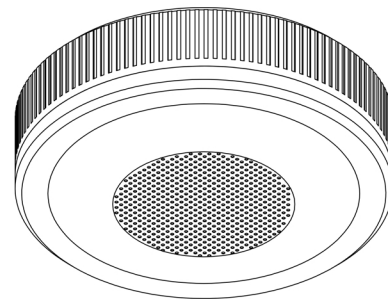

CODE: SE21090C0/SE21090W0

IMPORTANT: Please read these instructions before commencing installation and retain for future reference.

Components

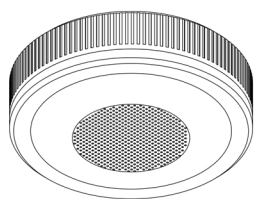

1 x Sensio Sound Speaker

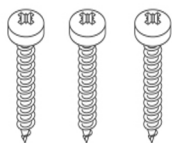

3 x Screws

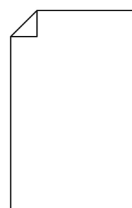

1 x instructions

Tools required



1 x Screw driver

Important Safety Information

Please read these instructions carefully before attempting to install this product. It is advisable to keep these instructions in a safe place for future reference.

We recommend that you consult a qualified electrician. All electrical installation must be carried out in accordance with current IEE wiring regulations (BS7671).

These products must not be modified, if any modification are made, it may invalidate the warranty and may render the product unsafe. These LED lights operate low voltage (12V).

Do not wire the individual LED light fittings directly to the mains. This product should be connected to a driver.

- If in doubt installation must be carried out by a qualified electrician.
- Install on smooth flat surface(s) only.
- Do not exceed or stretch the cable length of each fitting.
- The wattage for each light is 8W. Please use the appropriate driver with this product.
- A maximum of two Sensio Sound Speakers can be linked together to the same driver. Please check the combined wattages of the lights do not exceed the wattage of the driver.
- When using the Bluetooth feature, the maximum distance that the mobile device should be from the speaker is 10 metres.

Safety Instructions

1. Before commencing installation or maintenance, isolate the main electrical supply for the appropriate circuit at the fuse board.
2. This product is only suitable for connecting to a 240V 50Hz supply with use of a driver. Never exceed the total output of the LED driver.
3. The lights should be mounted onto a secure surface.

4. Suitable for furniture lighting.
5. When the lamp expires the fitting must be replaced.
6. Class III safety extra low voltage (SELV).

Waste Electrical & Electronic Equipment (WEEE)

The symbol on the product, or on the document accompanying the product, the crossed out wheellie bin symbol, indicates that this product may not be treated as household waste. Instead it shall be handed over to the applicable collection point for the recycling of electrical and electronic waste.



RoHS
Compliant ✓



Installation

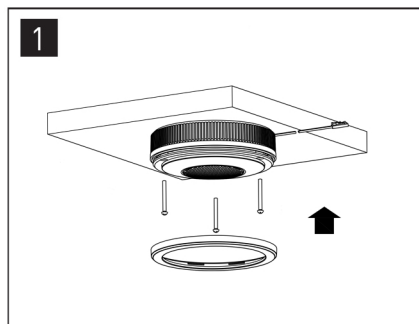

To install the light fitting, first twist off the top casing. There will now be 3 visible screw holes, using the screws provided fix the main body to the mounting surface. The top casing should now be re-attached, hiding the screws.

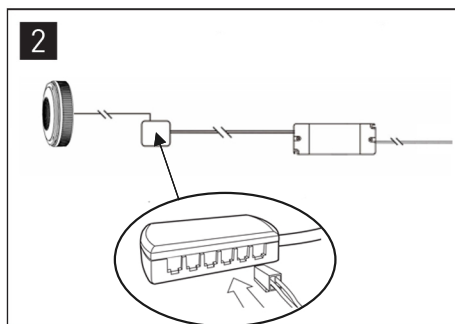

Next take the JB4 connector, which is attached to the light cable, and plug this into your driver distribution block. This block should already be wired to the driver.

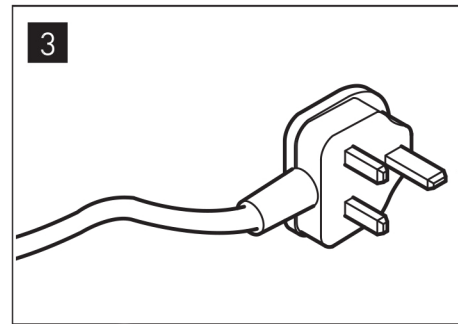

Wire the cable from the driver to the mains supply, or alternatively wire to a 13Amp plug and then connect to the mains supply.



Connect the first light to the driver. There will be a notification tone that shows the light is successfully powered. If using 2 lights, the second light **must be connected to the power within 10 seconds after the first**. A second notification tone will then indicate that the second light has been successfully powered.

If two lights are being used, the lights will then be matched automatically, which will be indicated by another notification tone.

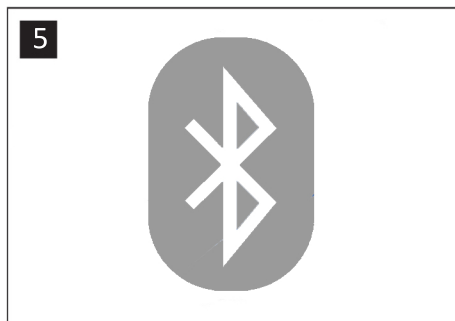

Open the Bluetooth function on the mobile device; you will find a new signal named 'Sensio Sound'. Select this to pair. There will be another notification tone when it is successfully connected.



Open the music player on your mobile phone; you may now select the music you wish to play through the speakers. In the case of connecting two fittings, both speakers will work together.

Operation

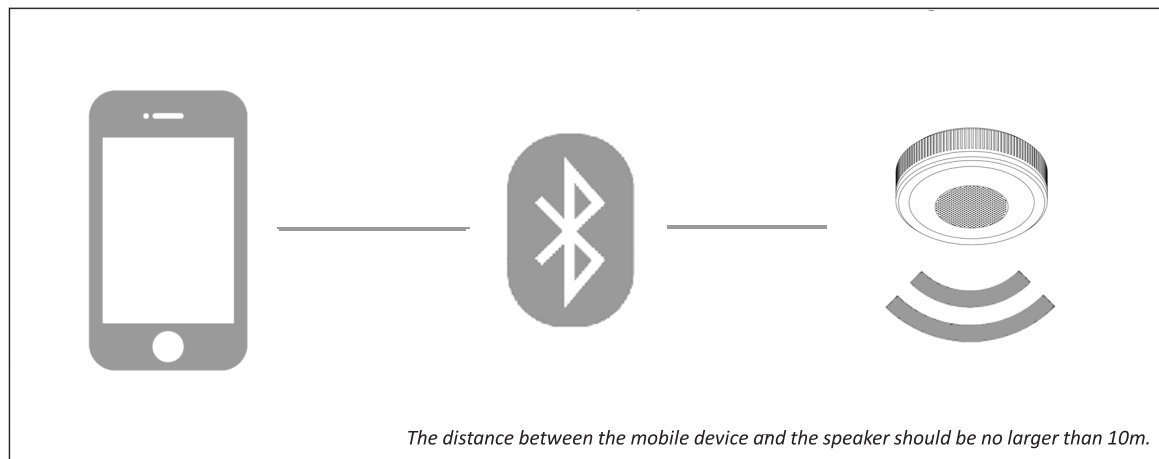

To operate the speaker system, follow stages 5-6 shown above. The music can then be controlled using the connected mobile phone device.

Once a connection is made with a device, in order to use a different mobile device to control the speaker, you will first need to dis-connect the existing device from the Bluetooth speaker. This can be done by turning the Bluetooth on the device off.

Maintenance & Care

- Ensure that the power is disconnected prior to cleaning.
- To keep the finish of this product, wipe over with soft cloth periodically.
- Do not use harsh chemical solvents, this may dis-colour or damage the finish.