



Blum's METABOX programme is a versatile steel drawer and pull-out system with many application options. The quick assembly version saves time and money when putting drawers together.

- Single drawer side system for economical solutions
- Equipped with the BLUMATIC self-closing feature
- Excellent runner action, high side stability, low sag values
- Good organisation options through a flexible gallery system
- 3-dimensional front adjustment
- Tool-free front assembly



Drawer side height N = 54 mm



Drawer side height M = 86 mm



Drawer side height K = 118 mm



Drawer side height H = 150 mm



Screw-on version



Quick assembly version C15

METABOX – pull-out system



- ▶ Basic elements
- ▶▶ Overview

▶ Basic elements

356



Symbol photo

- Drawer
- Inner drawer
- High fronted pull-out

a ▶▶ Accessories



Symbol photo

Side stabilisation	386	POSISTOP	389
Child safety latch	386	ORGA-LINE	390
Anti-tilt device	387	Screw-on	391
Spacers	387	Centre bit	391
METAFILE – file drawer	388	Door buffer	391
Contoured profile	389	Screwdriver	392
Pull-out stop	389		

+ ▶▶ Assembly, removal and adjustment



Symbol photo

Cabinet profile fixing positions	393
Drawer/inner drawer	394
High fronted pull-out	394
Adjustment	396

METABOX

i Pictograph

Item Available Upon Request	Installation height and/or min. space requirement in cabinet
General Information	Height of Drawer Side
Accessories	Dynamic carrying capacity in kg
Drawer	Planning
Inner drawer	Cutting
High fronted pull-out	Assembly
Full extension	Assembly, removal and adjustment
Single extension	
Gallery	
Double gallery	
Single-wall BOXSIDE	

METABOX – pull-out system



► Basic elements

►► Overview – basic elements

Standard cabinet

Basic element		Drawer	Inner drawer
		 320N 330N 358 366	 320N 330N 358 366
		 320M 330M 360 368	 320M 330M 360 368
		 320K 330K 362 370	 320K 330K 362 370
		 320H 330H 364 372	 320H 330H 364 372
Basic element		High fronted pull-out	
		 320M 330M 374 380	 320M 330M 374 380
		 320M 330M 376 382	 320M 330M 376 382
		 320M 330M 378 384	 320M 330M 378 384

320X – 25 kg – single extension
330X – 30 kg – full extension

METABOX – pull-out system

▶ Basic elements



METABOX – pull-out system

► Basic elements

►► Single extension – drawer/inner drawer – N



Product



Description

- Single extension with 54 mm high
- Epoxy coated steel drawer sides
- Drawer sides in cream (RAL 9001) as standard and in grey (RAL 9006) and white upon request
- High impact nylon rollers
- Dyn. load bearing 25 kg
- BLUMATIC self closing feature
- 2-dimensional front adjustment

Space requirement

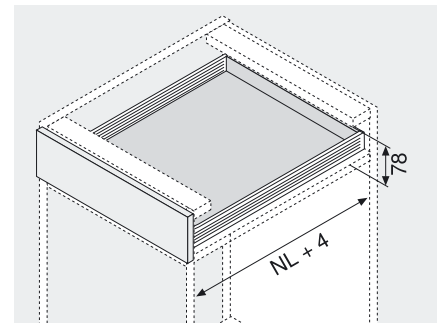



NL Nominal length

Ordering information

1  Cabinet profile drawer side left/right, RAL 9001 cream		
Nominal length NL	Screw-on version	Quick assembly version
270 mm	320N2700C	320N2700C15
350 mm	320N3500C	320N3500C15
400 mm	320N4000C	320N4000C15
450 mm	320N4500C	320N4500C15
500 mm	320N5000C	320N5000C15
550 mm	320N5500C	320N5500C15

Other colours available upon request (white or grey)

2c  Standard front fixing brackets left	
Screw-on version	ZSF.1510
Knock-in version	ZSF.1610
Order left and right	

3  Front fixing for inner drawers	
RAL 9001 cream	ZIF.3010
Nylon	
Order left and right	

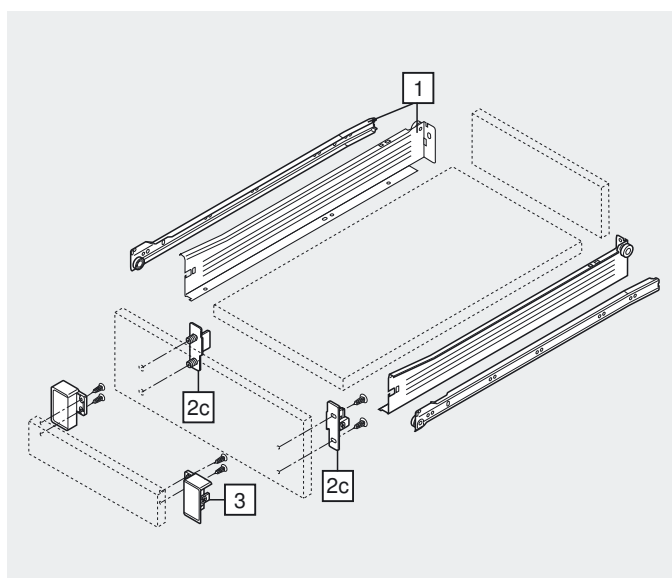

METABOX – pull-out system

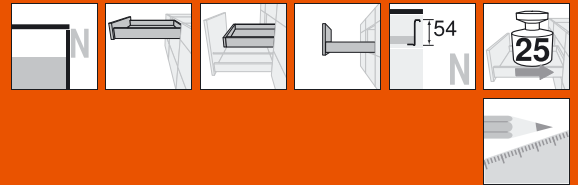

► Basic elements

►► Single extension – drawer/inner drawer – N

Planning

Space requirements in cabinet	Installation dimensions for screw-on front	Drilling dimensions for knock-in or EXPANDO front	Back installation dimensions
* + 3 mm for inner drawer	FA Front overlay Drawer Inner drawer	Drawer	

Cabinet profile screw positions

Nominal length NL (mm)

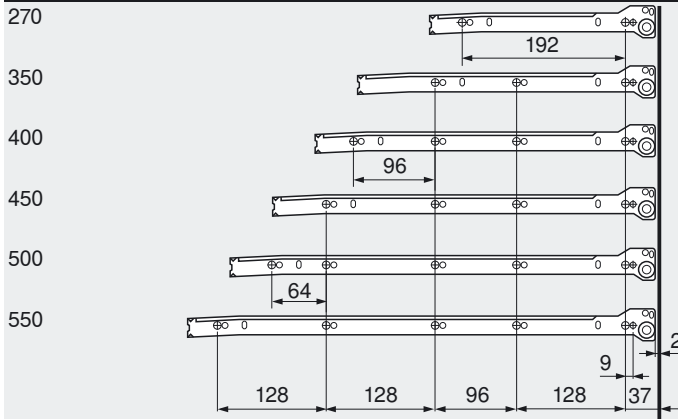

Min. internal cabinet depth = nominal length NL + 4 mm

Cabinet profile fixing positions

393

Cutting dimensions for 16 mm chipboard

	Back 39 mm
	Base Drawer NL - 2 mm Inner drawer NL - 18 mm
	Front Inner drawer 61 mm

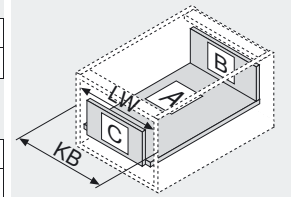

KB Cabinet width
LW Internal cabinet width
NL Nominal length

Base assembly for quick assembly version

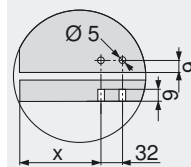

	X (mm)
Drawer	69
Inner drawer	53

Page instructions

Overview – METABOX	356
Accessories	386
Assembly and adjustment	394
Assembly devices	556
More technical details	658

METABOX – pull-out system

► Basic elements

►► Single extension – drawer/inner drawer – M

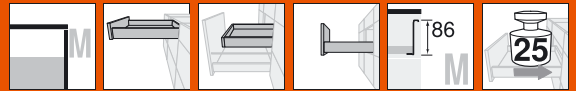

Product



Description

- Single extension with 86 mm high
- Epoxy coated steel drawer sides
- Drawer sides in cream (RAL 9001) as standard and in grey (RAL 9006) and white upon request
- High impact nylon rollers
- Dyn. load bearing 25 kg
- BLUMATIC self closing feature
- 2-dimensional front adjustment

Space requirement

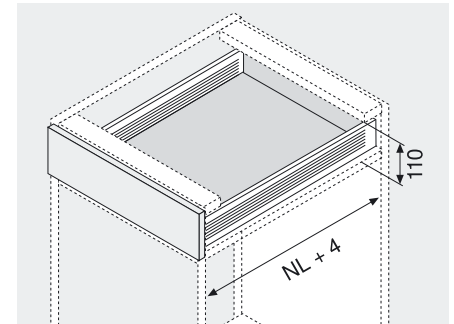

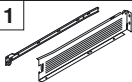

NL Nominal length

Ordering information

1  Cabinet profile drawer side left/right, RAL 9001 cream		
Nominal length NL	Screw-on version	Quick assembly version
270 mm	320M2700C	320M2700C15
350 mm	320M3500C	320M3500C15
400 mm	320M4000C	320M4000C15
450 mm	320M4500C	320M4500C15
500 mm	320M5000C	320M5000C15
550 mm	320M5500C	320M5500C15

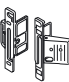
Other colours available upon request (white or grey)

2a  CLIP-front fixing brackets	
Screw-on version	ZSF.1200
Knock-in version	ZSF.1300
EXPANDO-version	ZSF.130E
Order left and right	

2b  Cover caps for 2a	
RAL 9001 cream	ZAA.3700
Nylon	
Order left and right	

Alternative to 2a

2c  Standard front fixing brackets left	
Screw-on version	ZSF.1700
Knock-in version	ZSF.1800
Order left and right	

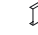
2d  Cover caps for 2c		
RAL 9001 cream	2 x	ZAA.3500
Nylon		

3  Front fixing for inner drawers	
RAL 9001 cream	ZIF.3000
Nylon	
Order left and right	

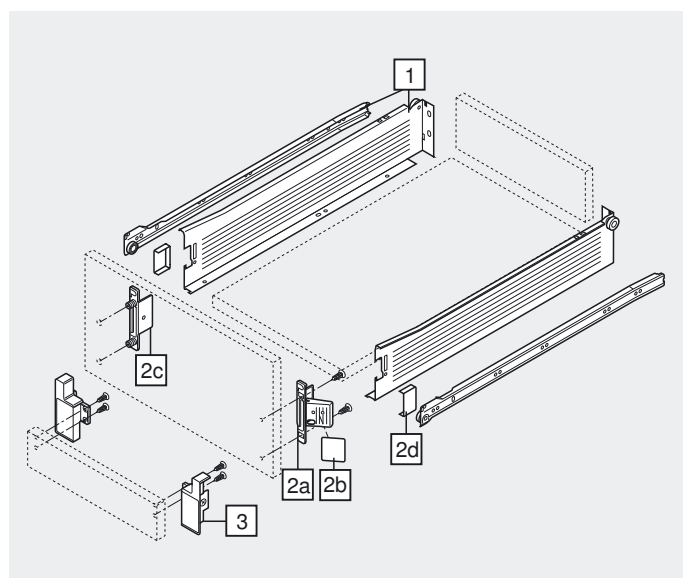

METABOX – pull-out system

► Basic elements

►► Single extension – drawer/inner drawer – M

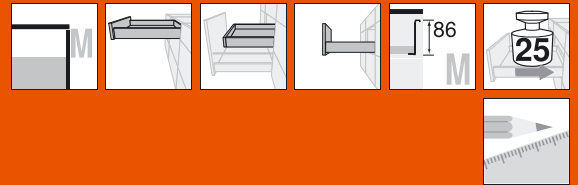

Planning

Space requirements in cabinet	Installation dimensions for screw-on front	Drilling dimensions for knock-in or EXPANDO front	Back installation dimensions
* + 3 mm for inner drawer	FA Front overlay Drawer Inner drawer	Drawer	

Cabinet profile screw positions

Nominal length NL (mm)

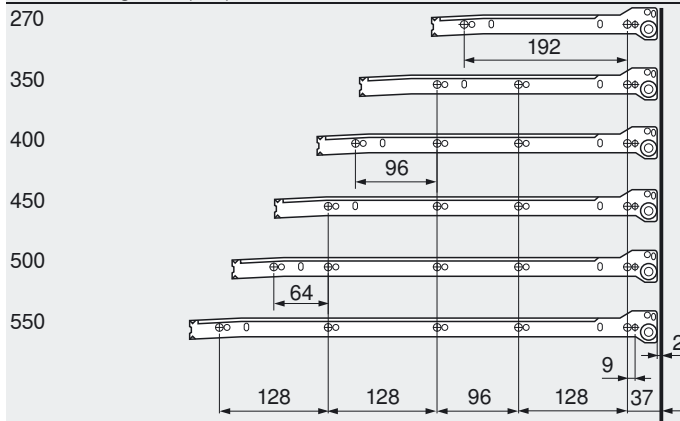

Min. internal cabinet depth = nominal length NL + 4 mm

Cabinet profile fixing positions

393

Cutting dimensions for 16 mm chipboard

	Back 71 mm
	Base Drawer NL - 2 mm Inner drawer NL - 18 mm
	Front Inner drawer 61 mm

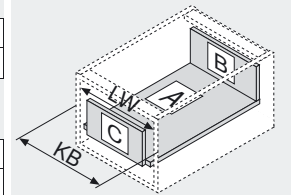

KB Cabinet width
LW Internal cabinet width
NL Nominal length

Base assembly for quick assembly version

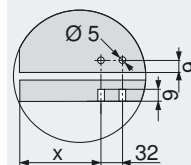

	X (mm)
Drawer	69
Inner drawer	53

Page instructions

Overview – METABOX	356
Accessories	386
Assembly and adjustment	394
Assembly devices	556
More technical details	658

METABOX – pull-out system

► Basic elements

►► Single extension – drawer/inner drawer – K

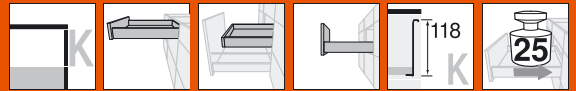

Product



Description

- Single extension with 118 mm high
- Epoxy coated steel drawer sides
- Drawer sides in cream (RAL 9001) as standard and in grey (RAL 9006) and white upon request
- High impact nylon rollers
- Dyn. load bearing 25 kg
- BLUMATIC self closing feature
- 2-dimensional front adjustment

Space requirement

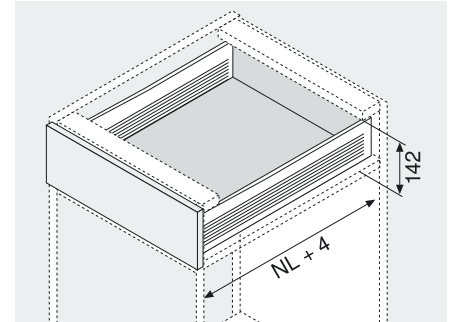

NL Nominal length

Ordering information

1	Cabinet profile drawer side left/right, RAL 9001 cream	
Nominal length NL	Screw-on version	Quick assembly version
350 mm	320K3500C	320K3500C15
400 mm	320K4000C	320K4000C15
450 mm	320K4500C	320K4500C15
500 mm	320K5000C	320K5000C15
550 mm	320K5500C	320K5500C15

Other colours available upon request (white or grey)

2a	CLIP-front fixing brackets	
	Screw-on version	ZSF.1200
	Knock-in version	ZSF.1300
	EXPANDO-version	ZSF.130E
Order left and right		

2b	Cover caps for 2a	
	RAL 9001 cream	ZAA.3700
	Nylon	
	Order left and right	

Alternative to 2a

2c	Standard front fixing brackets left	
	Screw-on version	ZSF.1700
	Knock-in version	ZSF.1800
	Order left and right	

2d	Cover caps for 2c	
	RAL 9001 cream	2 x ZAA.3500
	Nylon	

3	Front fixing for inner drawers	
	RAL 9001 cream	ZIF.3030
	Nylon	
	Order left and right	

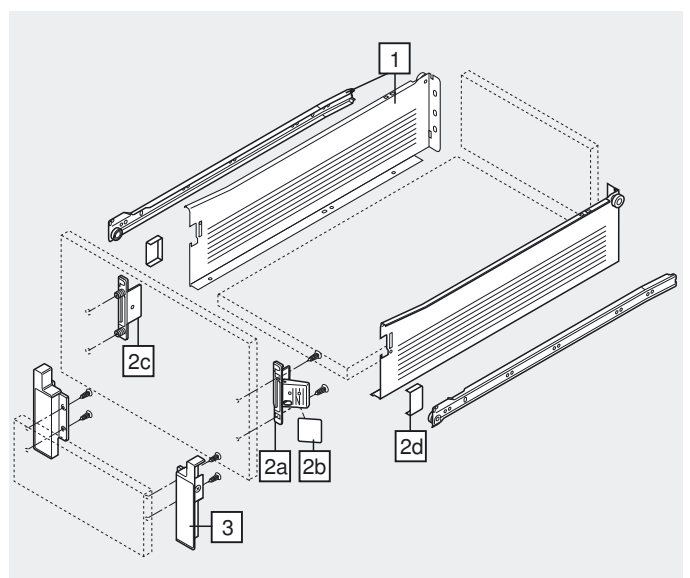

METABOX – pull-out system

► Basic elements

►► Single extension – drawer/inner drawer – K

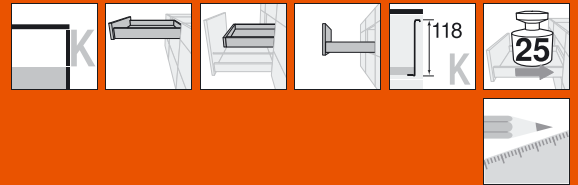

Planning

Space requirements in cabinet	Installation dimensions for screw-on front	Drilling dimensions for knock-in or EXPANDO front	Back installation dimensions
* + 3 mm for inner drawer	FA Front overlay Drawer Inner drawer	Drawer	

Cabinet profile screw positions

Nominal length NL (mm)

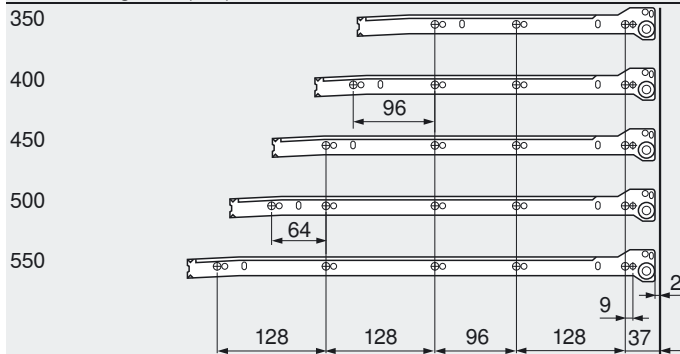

Min. internal cabinet depth = nominal length NL + 4 mm

Cabinet profile fixing positions

393

Cutting dimensions for 16 mm chipboard

	Back 103 mm
	Base Drawer NL - 2 mm Inner drawer NL - 18 mm
	Front Inner drawer 93 mm

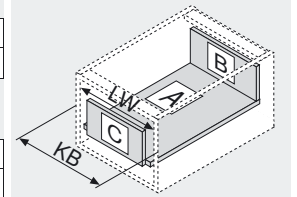

KB Cabinet width
LW Internal cabinet width
NL Nominal length

Base assembly for quick assembly version

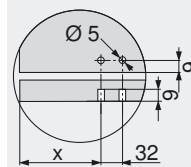

	X (mm)
Drawer	69
Inner drawer	53

Page instructions

Overview – METABOX	356
Accessories	386
Assembly and adjustment	394
Assembly devices	556
More technical details	658

METABOX – pull-out system

► Basic elements

►► Single extension – drawer/inner drawer – H

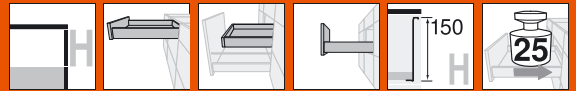

Product



Description

- Single extension with 150 mm high
- Epoxy coated steel drawer sides
- Drawer sides in cream (RAL 9001) as standard and in grey (RAL 9006) and white upon request
- High impact nylon rollers
- Dyn. load bearing 25 kg
- BLUMATIC self closing feature
- 2-dimensional front adjustment

Space requirement

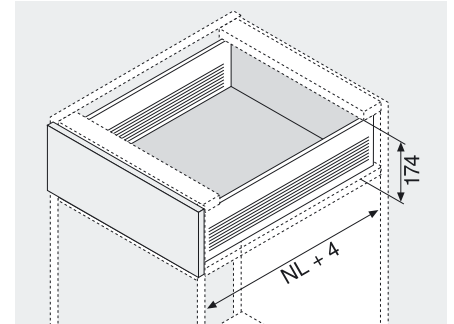

NL Nominal length

Ordering information

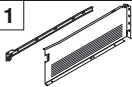
1 		
Cabinet profile drawer side left/right, RAL 9001 cream		
Nominal length NL	Screw-on version	Quick assembly version
350 mm	320H3500C	320H3500C15
400 mm	320H4000C	320H4000C15
450 mm	320H4500C	320H4500C15
500 mm	320H5000C	320H5000C15
550 mm	320H5500C	320H5500C15

Other colours available upon request (white or grey)

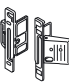
2a 	
CLIP-front fixing brackets	
Screw-on version	ZSF.1200
Knock-in version	ZSF.1300
EXPANDO-version	ZSF.130E
Order left and right	

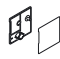
2b 	
Cover caps for 2a	
RAL 9001 cream	ZAA.3700
Nylon	
Order left and right	

Alternative to 2a

2c 	
Standard front fixing brackets left	
Screw-on version	ZSF.1700
Knock-in version	ZSF.1800
Order left and right	

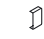
2d 	
Cover caps for 2c	
RAL 9001 cream	2 x ZAA.3500
Nylon	

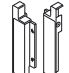
3 	
Front fixing for inner drawers	
RAL 9001 cream	ZIF.3050
Nylon	
Order left and right	

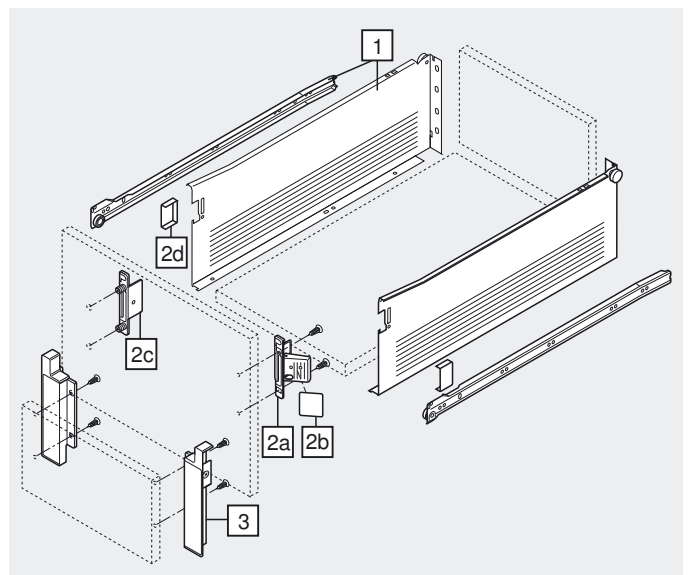

METABOX – pull-out system

► Basic elements

►► Single extension – drawer/inner drawer – H

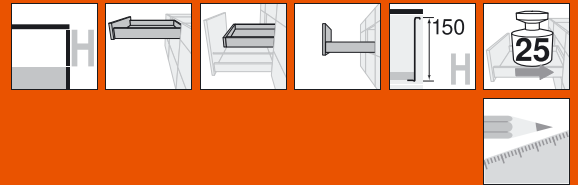

Planning

Space requirements in cabinet	Installation dimensions for screw-on front	Drilling dimensions for knock-in or EXPANDO front	Back installation dimensions
* + 3 mm for inner drawer	FA Front overlay Drawer Inner drawer	Drawer	

Cabinet profile screw positions

Nominal length NL (mm)

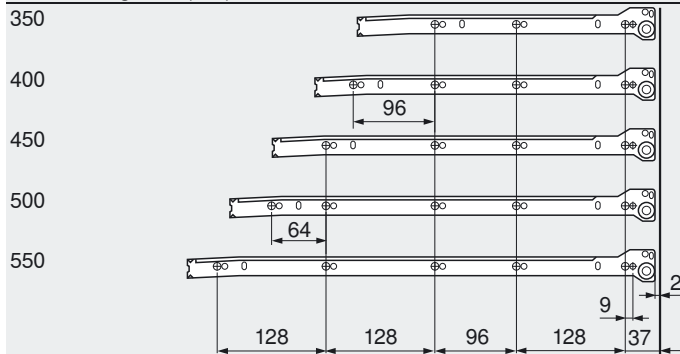

Min. internal cabinet depth = nominal length NL + 4 mm

Cabinet profile fixing positions

393

Cutting dimensions for 16 mm chipboard

	Back 135 mm
	Base Drawer NL - 2 mm Inner drawer NL - 18 mm
	Front Inner drawer 125 mm

LW - 31 mm (for Back and Base)
LW - 64 mm (for Front)

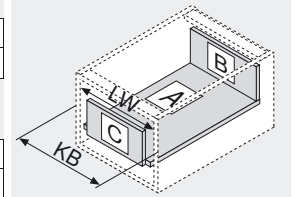

KB Cabinet width
LW Internal cabinet width
NL Nominal length

Base assembly for quick assembly version

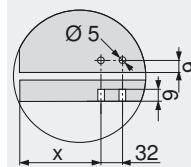

	X (mm)
Drawer	69
Inner drawer	53

Page instructions

Overview – METABOX	356
Accessories	386
Assembly and adjustment	394
Assembly devices	556
More technical details	658

METABOX – pull-out system

► Basic elements

►► Full extension – drawer/inner drawer – N

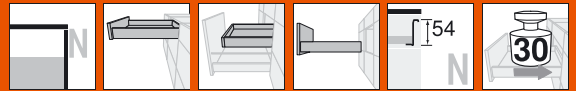

Product



Description

- Full extension with 54 mm high drawer sides
- Epoxy coated steel drawer sides
- Drawer sides in cream (RAL 9001) as standard and in grey (RAL 9006) and white upon request
- High impact nylon rollers
- Dyn. load bearing 30 kg
- BLUMATIC self closing feature
- 2-dimensional front adjustment

Space requirement

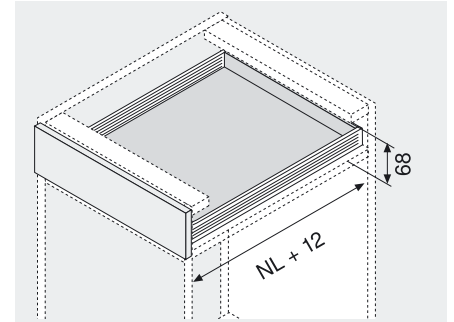



NL Nominal length

Ordering information

 Cabinet profile, centre profile and drawer side left/right, RAL 9001 cream		
Nominal length NL	Screw-on version	Quick assembly version
270 mm	330N270PC	330N270PC15
350 mm	330N350PC	330N350PC15
400 mm	330N400PC	330N400PC15
450 mm	330N450PC	330N450PC15
500 mm	330N500PC	330N500PC15
550 mm	330N550PC	330N550PC15

Other colours available upon request (white or grey)

 2c Standard front fixing brackets left	
Screw-on version	ZSF.1510
Knock-in version	ZSF.1610
Order left and right	

 3 Front fixing for inner drawers	
RAL 9001 cream	ZIF.3010
Nylon	
Order left and right	

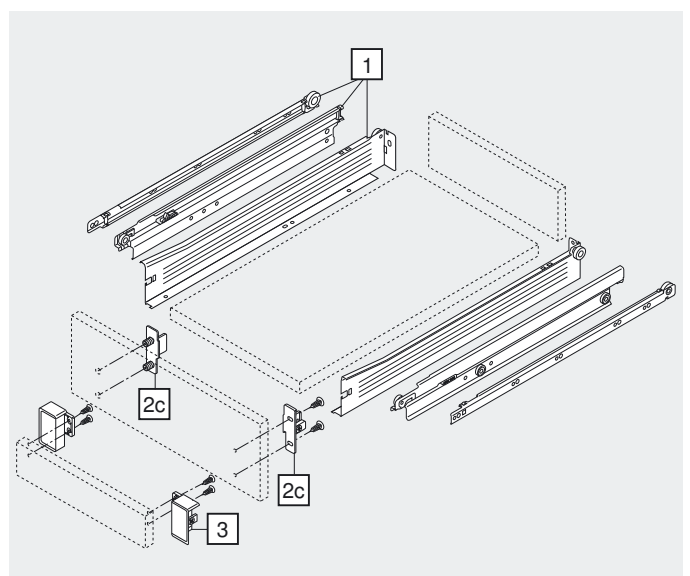

METABOX – pull-out system

► Basic elements

►► Full extension – drawer/inner drawer – N

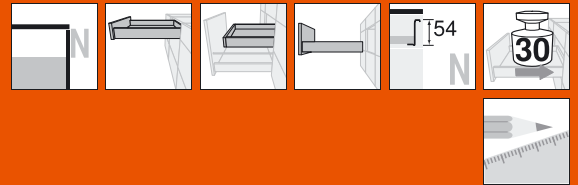

Planning

Space requirements in cabinet	Installation dimensions for screw-on front	Drilling dimensions for knock-in or EXPANDO front	Back installation dimensions
* + 3 mm for inner drawer	FA Front overlay Drawer Inner drawer	Drawer	

Cabinet profile screw positions

Nominal length NL (mm)

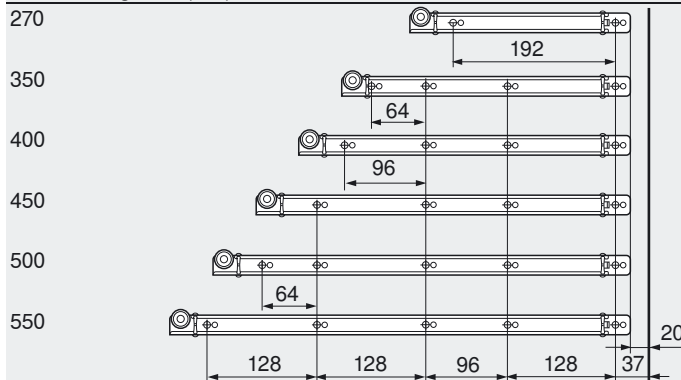

Min. internal cabinet depth = nominal length NL + 12 mm

Over extension = 8 mm

Cabinet profile fixing positions

393

Cutting dimensions for 16 mm chipboard

	Back 39 mm
	Base Drawer NL - 2 mm Inner drawer NL - 18 mm
	Front Inner drawer 61 mm

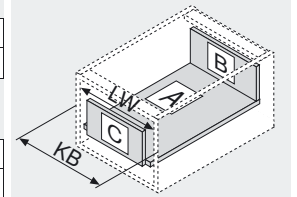

KB Cabinet width
LW Internal cabinet width
NL Nominal length

Base assembly for quick assembly version

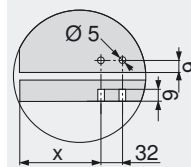

	X (mm)
Drawer	69
Inner drawer	53

Page instructions

Overview – METABOX	356
Accessories	386
Assembly and adjustment	394
Assembly devices	556
More technical details	658

METABOX – pull-out system

► Basic elements

►► Full extension – drawer/inner drawer – M

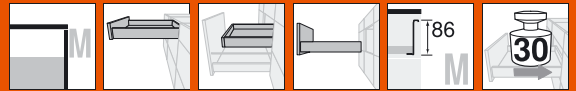

Product



Description

- Full extension with 86 mm high drawer sides
- Epoxy coated steel drawer sides
- Drawer sides in cream (RAL 9001) as standard and in grey (RAL 9006) and white upon request
- High impact nylon rollers
- Dyn. load bearing 30 kg
- BLUMATIC self closing feature
- 2-dimensional front adjustment

Space requirement

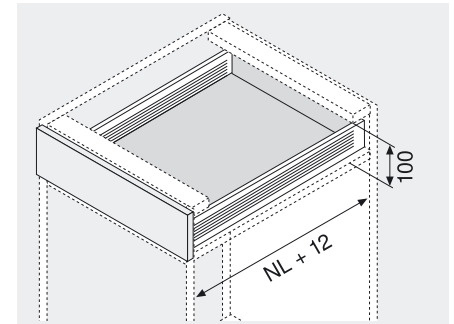

NL Nominal length

Ordering information

1	Cabinet profile, centre profile and drawer side left/right, RAL 9001 cream	
Nominal length NL	Screw-on version	Quick assembly version
270 mm	330M270PC	330M270PC15
350 mm	330M350PC	330M350PC15
400 mm	330M400PC	330M400PC15
450 mm	330M450PC	330M450PC15
500 mm	330M500PC	330M500PC15
550 mm	330M550PC	330M550PC15

Other colours available upon request (white or grey)

2a	CLIP-front fixing brackets	
	Screw-on version	ZSF.1200
	Knock-in version	ZSF.1300
	EXPANDO-version	ZSF.130E
	Order left and right	

2b	Cover caps for 2a	
	RAL 9001 cream	ZAA.3700
	Nylon	
	Order left and right	

Alternative to 2a

2c	Standard front fixing brackets left	
	Screw-on version	ZSF.1700
	Knock-in version	ZSF.1800
	Order left and right	

2d	Cover caps for 2c	
	RAL 9001 cream	2 x ZAA.3500
	Nylon	

3	Front fixing for inner drawers	
	RAL 9001 cream	ZIF.3000
	Nylon	
	Order left and right	

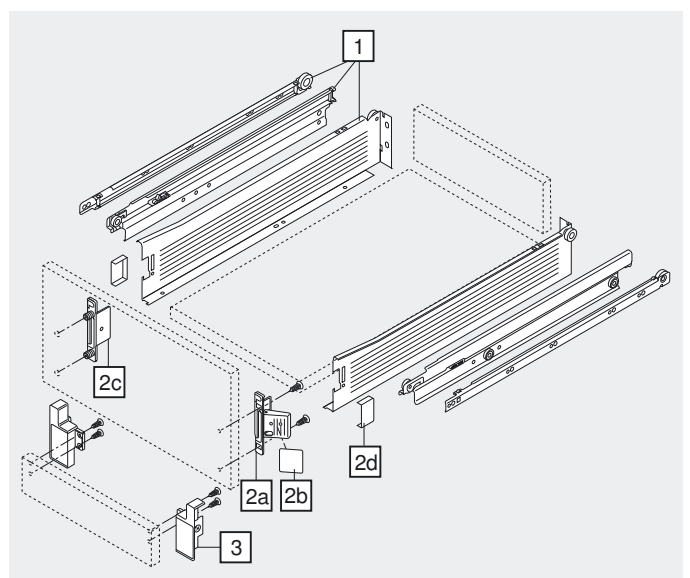

METABOX – pull-out system

► Basic elements

►► Full extension – drawer/inner drawer – M

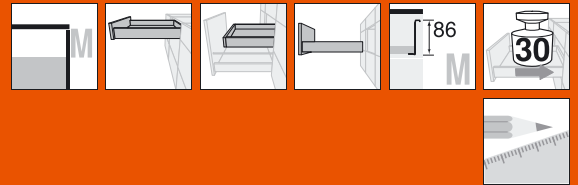

Planning

Space requirements in cabinet	Installation dimensions for screw-on front	Drilling dimensions for knock-in or EXPANDO front	Back installation dimensions
* + 3 mm for inner drawer	FA Front overlay Drawer Inner drawer	Drawer	

Cabinet profile screw positions

Nominal length NL (mm)

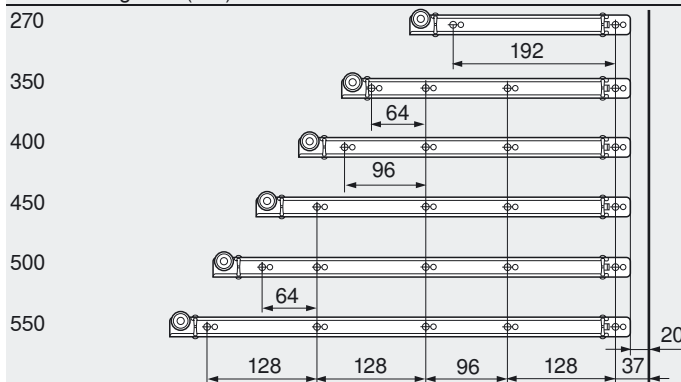

Min. internal cabinet depth = nominal length NL + 12 mm

Over extension = 8 mm

Cabinet profile fixing positions

393

Cutting dimensions for 16 mm chipboard

	Back 71 mm
	Base Drawer NL - 2 mm Inner drawer NL - 18 mm
	Front Inner drawer 61 mm

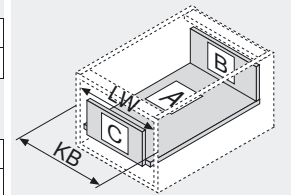

KB Cabinet width
LW Internal cabinet width
NL Nominal length

Base assembly for quick assembly version

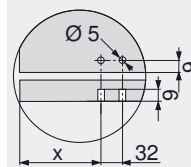

	X (mm)
Drawer	69
Inner drawer	53

Page instructions

Overview – METABOX	356
Accessories	386
Assembly and adjustment	394
Assembly devices	556
More technical details	658

METABOX – pull-out system

► Basic elements

►► Full extension – drawer/inner drawer – K

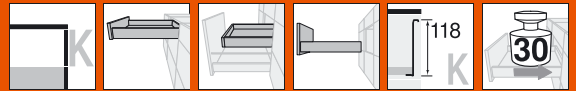

Product



Description

- Full extension with 118 mm high drawer sides
- Epoxy coated steel drawer sides
- Drawer sides in cream (RAL 9001) as standard and in grey (RAL 9006) and white upon request
- High impact nylon rollers
- Dyn. load bearing 30 kg
- BLUMATIC self closing feature
- 2-dimensional front adjustment

Space requirement

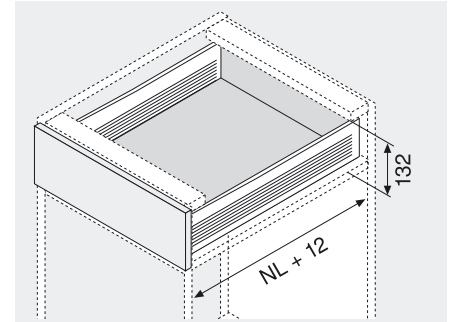

NL Nominal length

Ordering information

Nominal length NL	Cabinet profile, centre profile and drawer side left/right, RAL 9001 cream	
	Screw-on version	Quick assembly version
350 mm	330K350PC	330K350PC15
400 mm	330K400PC	330K400PC15
450 mm	330K450PC	330K450PC15
500 mm	330K500PC	330K500PC15
550 mm	330K550PC	330K550PC15

Other colours available upon request (white or grey)

2a	CLIP-front fixing brackets	
	Screw-on version	ZSF.1200
	Knock-in version	ZSF.1300
	EXPANDO-version	ZSF.130E
	Order left and right	

2b	Cover caps for 2a	
	RAL 9001 cream	ZAA.3700
	Nylon	
	Order left and right	

Alternative to 2a

2c	Standard front fixing brackets left	
	Screw-on version	ZSF.1700
	Knock-in version	ZSF.1800
	Order left and right	

2d	Cover caps for 2c	
	RAL 9001 cream	2 x ZAA.3500
	Nylon	

3	Front fixing for inner drawers	
	RAL 9001 cream	ZIF.3030
	Nylon	
	Order left and right	

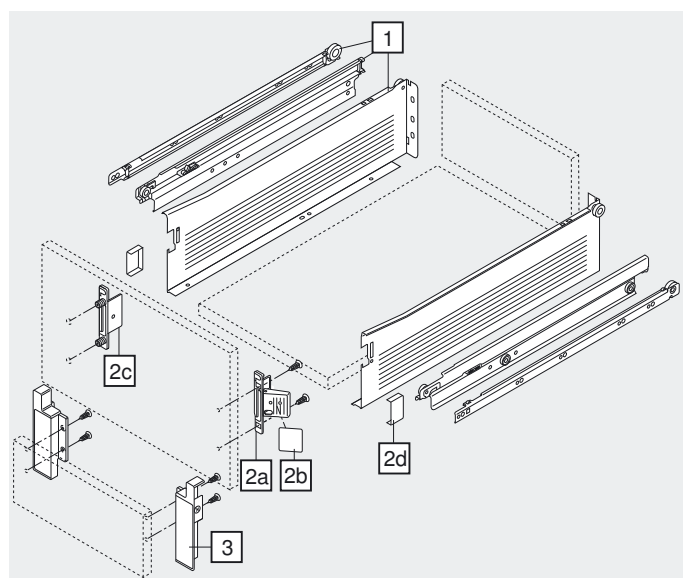

METABOX – pull-out system

► Basic elements

►► Full extension – drawer/inner drawer – K

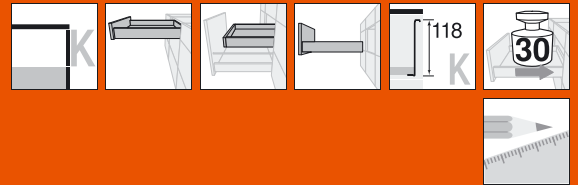

Planning

Space requirements in cabinet	Installation dimensions for screw-on front	Drilling dimensions for knock-in or EXPANDO front	Back installation dimensions
* + 3 mm for inner drawer	FA Front overlay Drawer Inner drawer	Drawer	

Cabinet profile screw positions

Nominal length NL (mm)

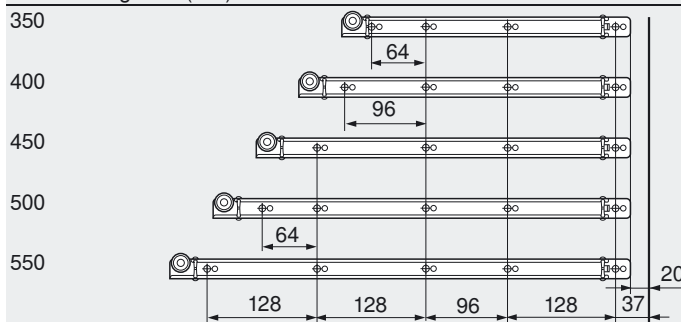

Min. internal cabinet depth = nominal length NL + 12 mm

Over extension = 8 mm

Cabinet profile fixing positions

393

Cutting dimensions for 16 mm chipboard

	Back 103 mm
	Base Drawer NL - 2 mm Inner drawer NL - 18 mm
	Front Inner drawer 93 mm

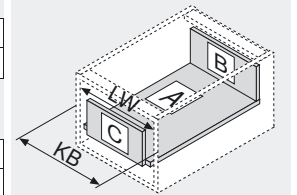

KB Cabinet width
LW Internal cabinet width
NL Nominal length

Base assembly for quick assembly version

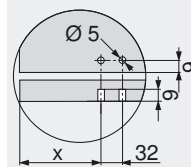

	X (mm)
Drawer	69
Inner drawer	53

Page instructions

Overview – METABOX	356
Accessories	386
Assembly and adjustment	394
Assembly devices	556
More technical details	658

METABOX – pull-out system

► Basic elements

►► Full extension – drawer/inner drawer – H

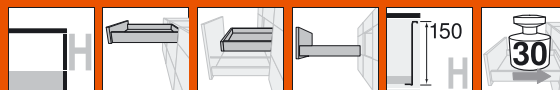

Product



Description

- Full extension with 150 mm high drawer sides
- Epoxy coated steel drawer sides
- Drawer sides in cream (RAL 9001) as standard and in grey (RAL 9006) and white upon request
- High impact nylon rollers
- Dyn. load bearing 30 kg
- BLUMATIC self closing feature
- 2-dimensional front adjustment

Space requirement

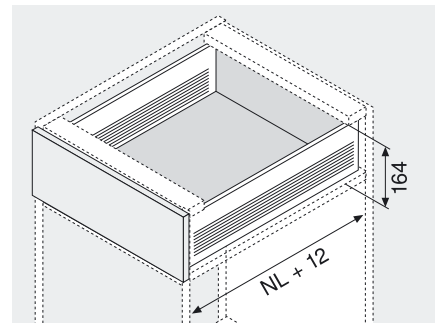

NL Nominal length

Ordering information

Nominal length NL	Cabinet profile, centre profile and drawer side left/right, RAL 9001 cream	
	Screw-on version	Quick assembly version
350 mm	330H350PC	330H350PC15
400 mm	330H400PC	330H400PC15
450 mm	330H450PC	330H450PC15
500 mm	330H500PC	330H500PC15
550 mm	330H550PC	330H550PC15

Other colours available upon request (white or grey)

2a	CLIP-front fixing brackets	
	Screw-on version	ZSF.1200
	Knock-in version	ZSF.1300
	EXPANDO-version	ZSF.130E
	Order left and right	

2b	Cover caps for 2a	
	RAL 9001 cream	ZAA.3700
	Nylon	
	Order left and right	

Alternative to 2a

2c	Standard front fixing brackets left	
	Screw-on version	ZSF.1700
	Knock-in version	ZSF.1800
	Order left and right	

2d	Cover caps for 2c	
	RAL 9001 cream	2 x ZAA.3500
	Nylon	

3	Front fixing for inner drawers	
	RAL 9001 cream	ZIF.3050
	Nylon	
	Order left and right	

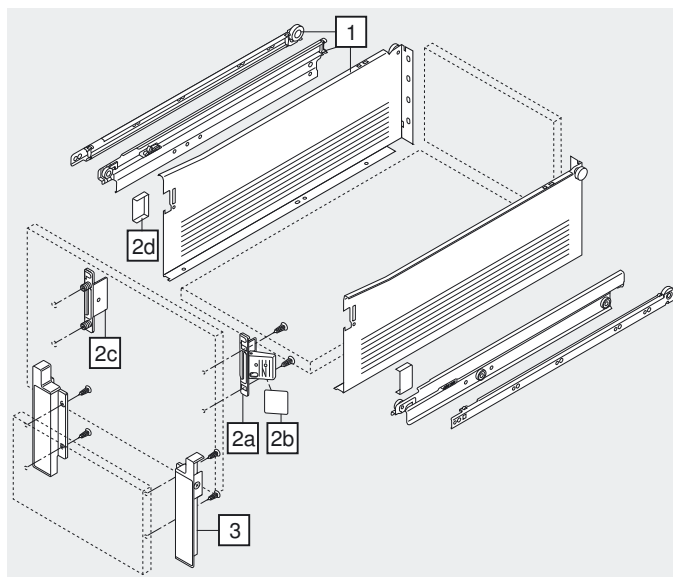

METABOX – pull-out system

► Basic elements

►► Full extension – drawer/inner drawer – H

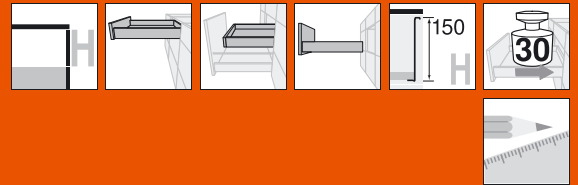

Planning

Space requirements in cabinet	Installation dimensions for screw-on front	Drilling dimensions for knock-in or EXPANDO front	Back installation dimensions
* + 3 mm for inner drawer	FA Front overlay Drawer Inner drawer	Drawer	

Cabinet profile screw positions

Nominal length NL (mm)

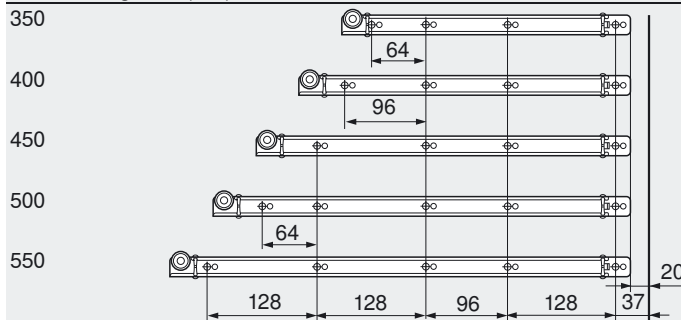

Min. internal cabinet depth = nominal length NL + 12 mm

Over extension = 8 mm

Cabinet profile fixing positions

393

Cutting dimensions for 16 mm chipboard

	Back 135 mm
	Base Drawer NL - 2 mm Inner drawer NL - 18 mm
	Front Inner drawer 125 mm

LW - 31 mm (for Back and Base)
LW - 64 mm (for Front)

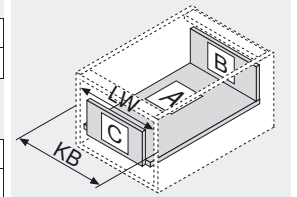

KB Cabinet width
LW Internal cabinet width
NL Nominal length

Base assembly for quick assembly version

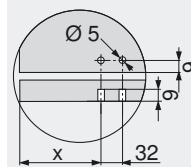

	X (mm)
Drawer	69
Inner drawer	53

Page instructions

Overview – METABOX	356
Accessories	386
Assembly and adjustment	394
Assembly devices	556
More technical details	658

METABOX – pull-out system

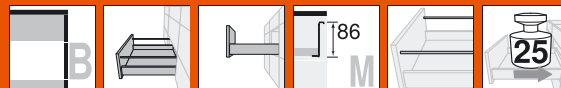

► Basic elements

►► Single extension – high fronted pull-out – gallery – B

Product



Description

- Single extension with 86 mm high
- Epoxy coated steel drawer sides
- Drawer sides in cream (RAL 9001) as standard and in grey (RAL 9006) and white upon request
- High impact nylon rollers
- Dyn. load bearing 25 kg
- BLUMATIC self closing feature
- 3-dimensional front adjustment
- Tool free assembly of gallery system (INSERTA/CLIP)

Space requirement

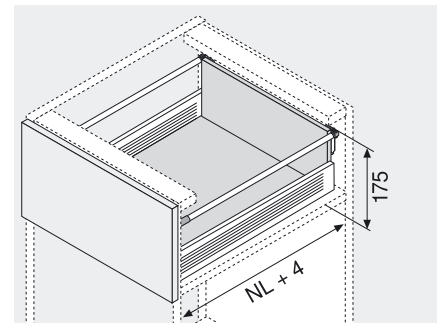

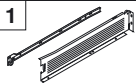
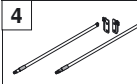

NL Nominal length

Ordering information

1  Cabinet profile drawer side left/right, RAL 9001 cream			4  Longside gallery rails with back fixing left/right		
Nominal length NL	Screw-on version	Quick assembly version	Nominal length NL	RAL 9001 cream	
350 mm	320M3500C	320M3500C15	350 mm	ZRE.321S.ID	
400 mm	320M4000C	320M4000C15	400 mm	ZRE.371S.ID	
450 mm	320M4500C	320M4500C15	450 mm	ZRE.421S.ID	
500 mm	320M5000C	320M5000C15	500 mm	ZRE.471S.ID	
550 mm	320M5500C	320M5500C15	550 mm	ZRE.521S.ID	

Other colours available upon request (white or grey)

2a 	CLIP-front fixing brackets	
	Screw-on version	ZSF.1200
	Knock-in version	ZSF.1300
	EXPANDO-version	ZSF.130E
	Order left and right	

2b 	Cover caps for 2a	
	RAL 9001 cream	ZAA.3700
	Nylon	
	Order left and right	

Alternative to 2a

2c 	Standard front fixing brackets left	
	Screw-on version	ZSF.1700
	Knock-in version	ZSF.1800
	Order left and right	

2d 	Cover caps for 2c		
	RAL 9001 cream	2 x	ZAA.3500
	Nylon		

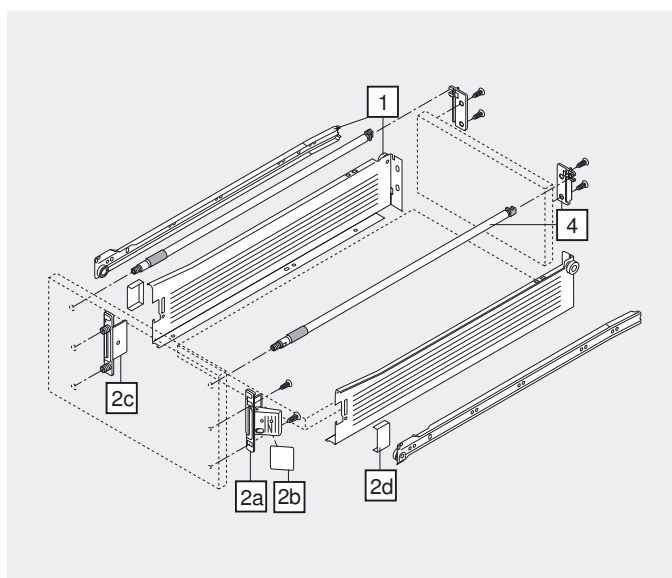

METABOX – pull-out system

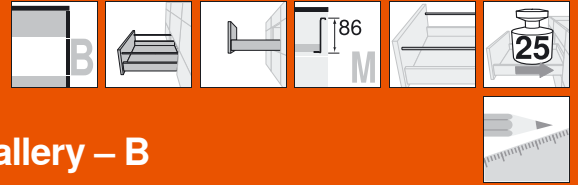

► Basic elements

►► Single extension – high fronted pull-out – gallery – B

Planning

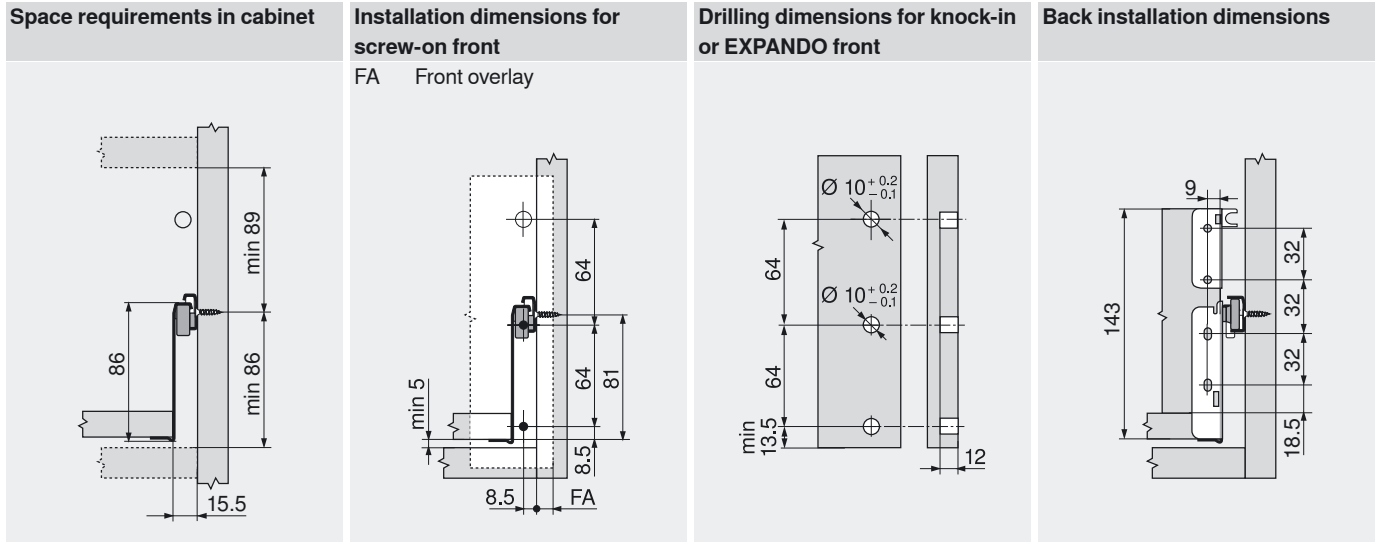

Cabinet profile screw positions

Nominal length NL (mm)

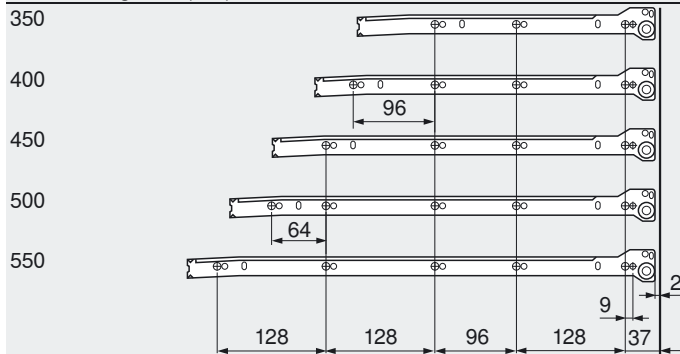

Min. internal cabinet depth = nominal length NL + 4 mm

Cabinet profile fixing positions

393

Cutting dimensions for 16 mm chipboard

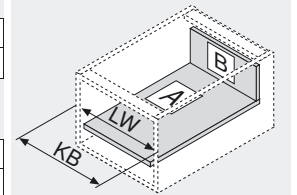
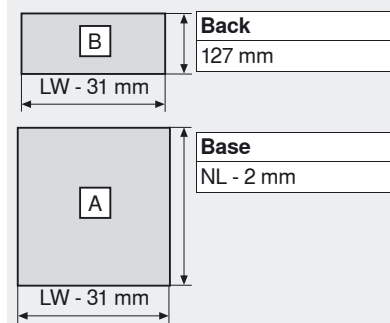

KB Cabinet width
LW Internal cabinet width
NL Nominal length

Base assembly for quick assembly version

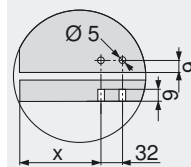

	X (mm)
High fronted pull-out	69

Page instructions

Overview – METABOX	356
Accessories	386
ORGA-LINE-accessories	390
Assembly and adjustment	394
Assembly devices	556
More technical details	658

METABOX – pull-out system

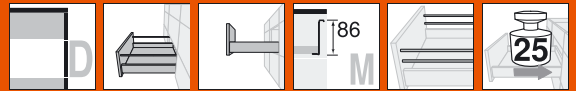

► Basic elements

►► Single extension – high fronted pull-out – double gallery – D

Product



Description

- Single extension with 86 mm high
- Epoxy coated steel drawer sides
- Drawer sides in cream (RAL 9001) as standard and in grey (RAL 9006) and white upon request
- High impact nylon rollers
- Dyn. load bearing 25 kg
- BLUMATIC self closing feature
- 3-dimensional front adjustment
- Tool free assembly of gallery system (INSERTA/CLIP)

Space requirement

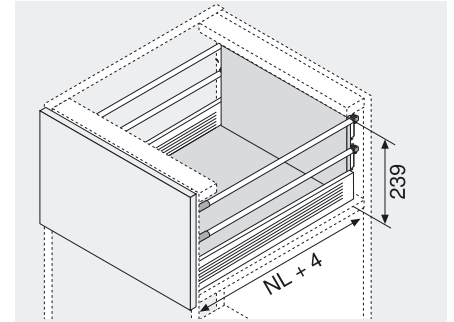

NL Nominal length

Ordering information

1 Cabinet profile drawer side left/right, RAL 9001 cream			4 Longside gallery rails with back fixing left/right		
Nominal length NL	Screw-on version	Quick assembly version	Nominal length NL		RAL 9001 cream
350 mm	320M3500C	320M3500C15	350 mm	2 x	ZRE.321S.ID
400 mm	320M4000C	320M4000C15	400 mm	2 x	ZRE.371S.ID
450 mm	320M4500C	320M4500C15	450 mm	2 x	ZRE.421S.ID
500 mm	320M5000C	320M5000C15	500 mm	2 x	ZRE.471S.ID
550 mm	320M5500C	320M5500C15	550 mm	2 x	ZRE.521S.ID

Other colours available upon request (white or grey)

2a	CLIP-front fixing brackets	
	Screw-on version	ZSF.1200
	Knock-in version	ZSF.1300
	EXPANDO-version	ZSF.130E
Order left and right		

2b	Cover caps for 2a	
	RAL 9001 cream	ZAA.3700
	Nylon	
Order left and right		

Alternative to 2a

2c	Standard front fixing brackets left	
	Screw-on version	ZSF.1700
	Knock-in version	ZSF.1800
Order left and right		

2d	Cover caps for 2c	
	RAL 9001 cream	2 x ZAA.3500
	Nylon	

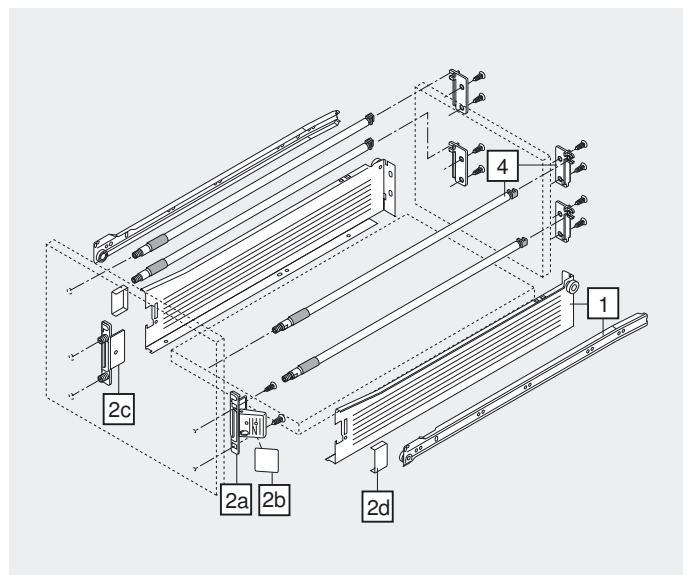

METABOX – pull-out system

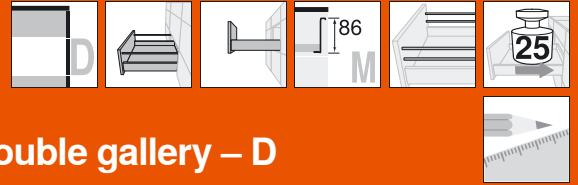

► Basic elements

►► Single extension – high fronted pull-out – double gallery – D

Planning

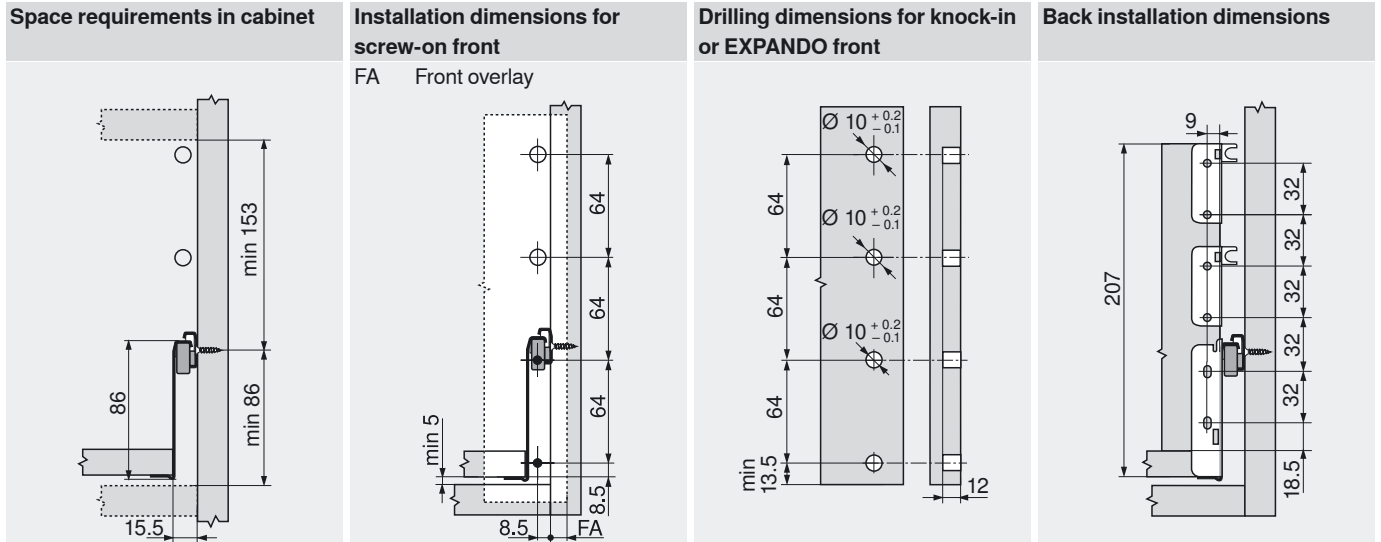

Cabinet profile screw positions

Nominal length NL (mm)

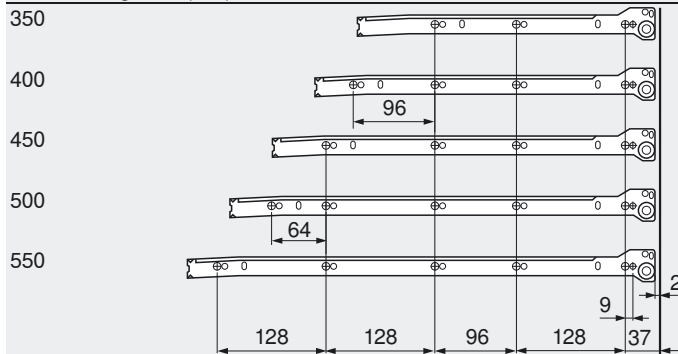

Min. internal cabinet depth = nominal length NL + 4 mm

Cabinet profile fixing positions

393

Cutting dimensions for 16 mm chipboard

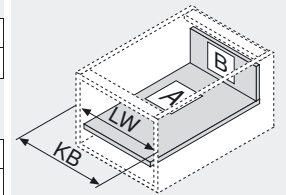
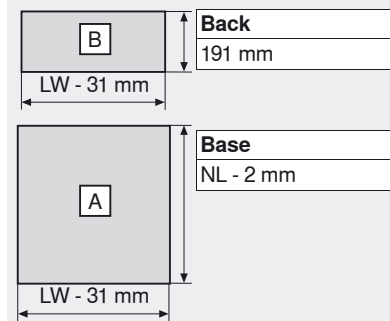

KB Cabinet width
LW Internal cabinet width
NL Nominal length

Base assembly for quick assembly version

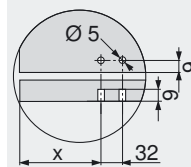

	X (mm)
High fronted pull-out	69

Page instructions

Overview – METABOX	356
Accessories	386
ORGA-LINE-accessories	390
Assembly and adjustment	394
Assembly devices	556
More technical details	658

METABOX – pull-out system

► Basic elements

►► Single extension – high fronted pull-out – BOXSIDE – D



Product



Description

- Single extension with 86 mm high
- Epoxy coated steel drawer sides
- Drawer sides in cream (RAL 9001) as standard and in grey (RAL 9006) and white upon request
- High impact nylon rollers
- Dyn. load bearing 25 kg
- BLUMATIC self closing feature
- 3-dimensional front adjustment
- Tool free assembly of gallery system (INSERTA/CLIP)

Space requirement

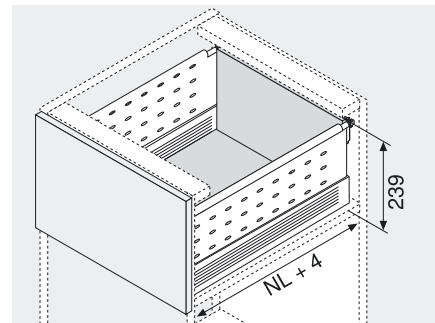

NL Nominal length

Ordering information

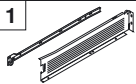
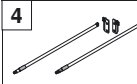
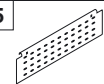
1 			4 			5 		
Nominal length NL	Screw-on version	Quick assembly version	Nominal length NL	RAL 9001 cream		Nominal length NL		RAL 9001 cream
400 mm	320M4000C	320M4000C15	400 mm	ZRE.371S.ID		400 mm	2 x	Z36H367SE01
450 mm	320M4500C	320M4500C15	450 mm	ZRE.421S.ID		450 mm	2 x	Z36H417SE01
500 mm	320M5000C	320M5000C15	500 mm	ZRE.471S.ID		500 mm	2 x	Z36H467SE01
550 mm	320M5500C	320M5500C15	550 mm	ZRE.521S.ID		550 mm	2 x	Z36H517SE01

2a 	CLIP-front fixing brackets	
	Screw-on version	ZSF.1200
	Knock-in version	ZSF.1300
	EXPANDO-version	ZSF.130E
	Order left and right	

2b 	Cover caps for 2a	
	RAL 9001 cream	ZAA.3700
	Nylon	
	Order left and right	

Alternative to 2a

2c 	Standard front fixing brackets left	
	Screw-on version	ZSF.1700
	Knock-in version	ZSF.1800
	Order left and right	

2d 	Cover caps for 2c		
	RAL 9001 cream	2 x	ZAA.3500
	Nylon		

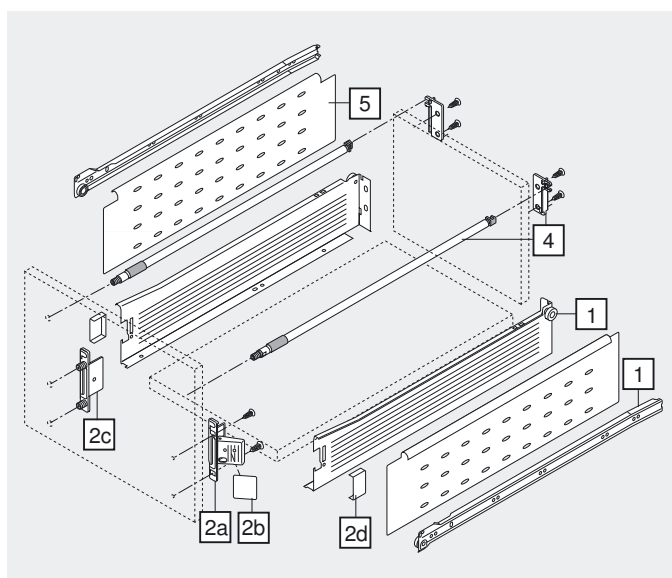

METABOX – pull-out system

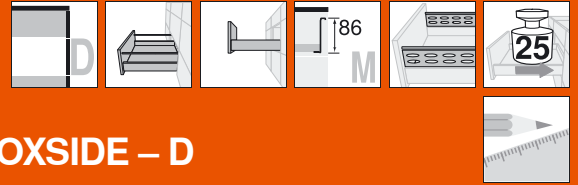

► Basic elements

►► Single extension – high fronted pull-out – BOXSIDE – D

Planning

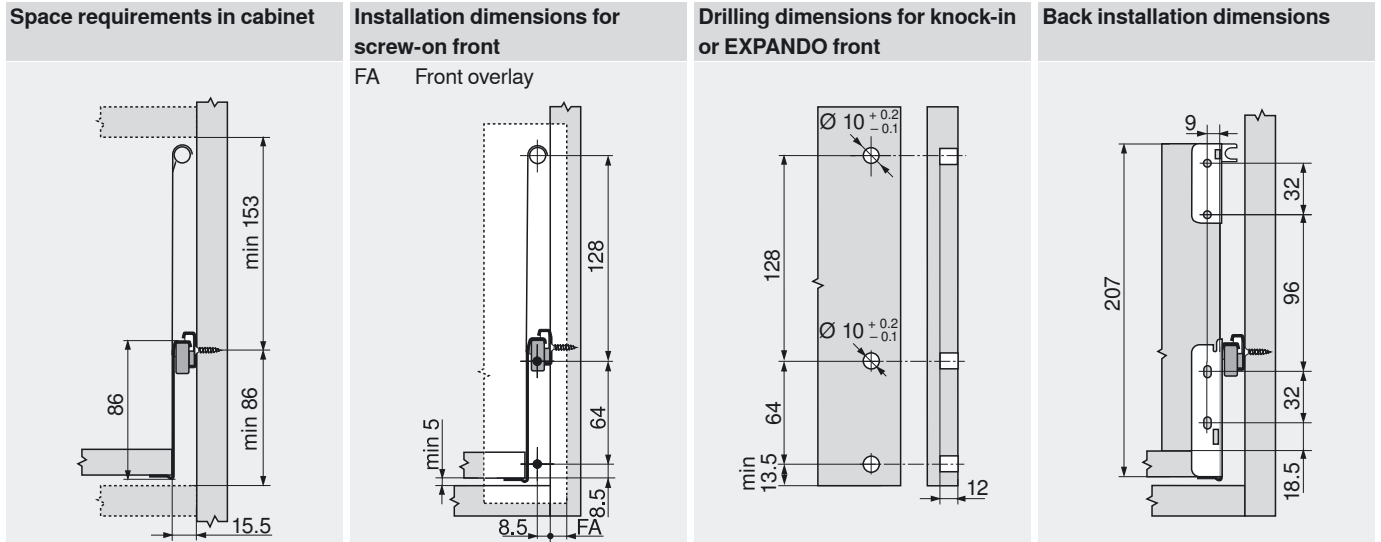

Cabinet profile screw positions

Nominal length NL (mm)

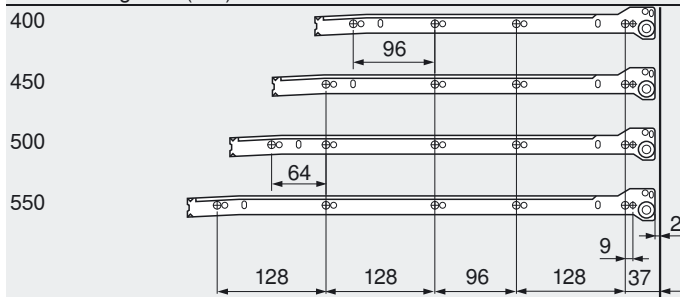

Min. internal cabinet depth = nominal length NL + 4 mm

Cabinet profile fixing positions

393

Cutting dimensions for 16 mm chipboard

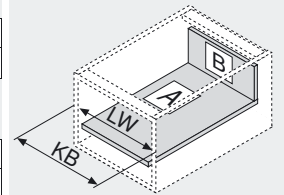
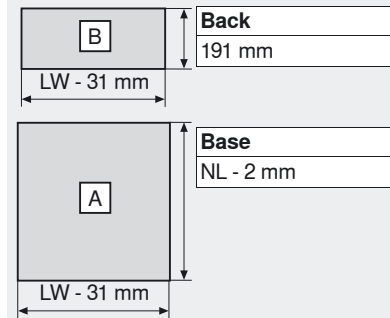

KB Cabinet width
LW Internal cabinet width
NL Nominal length

Base assembly for quick assembly version

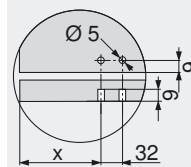

	X (mm)
High fronted pull-out	69

Page instructions

Overview – METABOX	356
Accessories	386
ORGA-LINE-accessories	390
Assembly and adjustment	394
Assembly devices	556
More technical details	658

METABOX – pull-out system

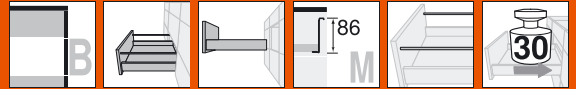

► Basic elements

►► Full extension – high fronted pull-out – gallery – B

Product



Description

- Full extension with 86 mm high drawer sides
- Epoxy coated steel drawer sides
- Drawer sides in cream (RAL 9001) as standard and in grey (RAL 9006) and white upon request
- High impact nylon rollers
- Dyn. load bearing 30 kg
- BLUMATIC self closing feature
- 3-dimensional front adjustment
- Tool free assembly of gallery system (INSERTA/CLIP)

Space requirement

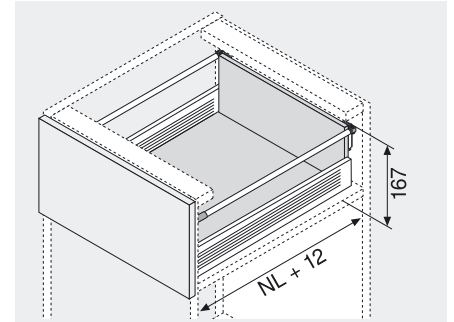

NL Nominal length

Ordering information

1	Cabinet profile, centre profile and drawer side left/right, RAL 9001 cream	
	Nominal length NL	Quick assembly version
	350 mm	330M350PC
	400 mm	330M400PC
	450 mm	330M450PC
	500 mm	330M500PC
	550 mm	330M550PC

4	Longside gallery rails with back fixing left/right	
	Nominal length NL	RAL 9001 cream
	350 mm	ZRE.321S.ID
	400 mm	ZRE.371S.ID
	450 mm	ZRE.421S.ID
	500 mm	ZRE.471S.ID
	550 mm	ZRE.521S.ID

Other colours available upon request (white or grey)

2a	CLIP-front fixing brackets	
	Screw-on version	ZSF.1200
	Knock-in version	ZSF.1300
	EXPANDO-version	ZSF.130E
	Order left and right	

2b	Cover caps for 2a	
	RAL 9001 cream	ZAA.3700
	Nylon	
	Order left and right	

Alternative to 2a

2c	Standard front fixing brackets left	
	Screw-on version	ZSF.1700
	Knock-in version	ZSF.1800
	Order left and right	

2d	Cover caps for 2c	
	RAL 9001 cream	2 x ZAA.3500
	Nylon	

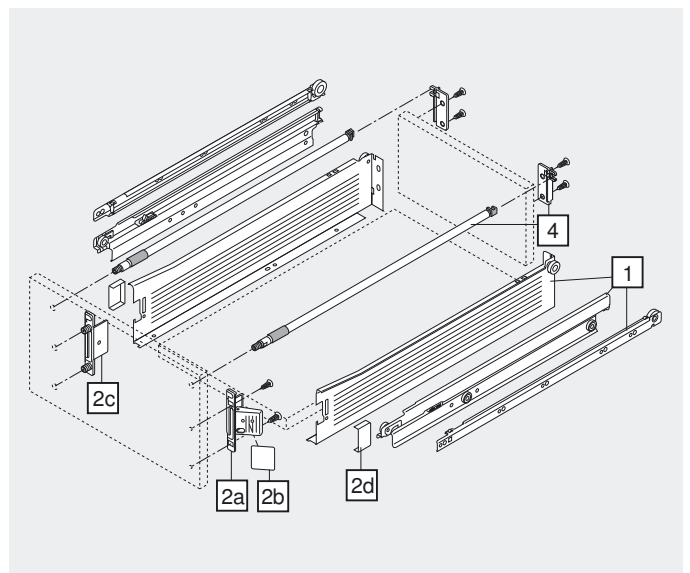

METABOX – pull-out system

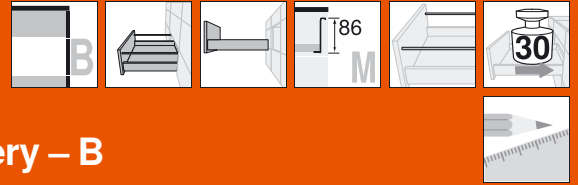

► Basic elements

►► Full extension – high fronted pull-out – gallery – B

Planning

Space requirements in cabinet	Installation dimensions for screw-on front FA Front overlay	Drilling dimensions for knock-in or EXPANDO front	Back installation dimensions

Cabinet profile screw positions

Nominal length NL (mm)

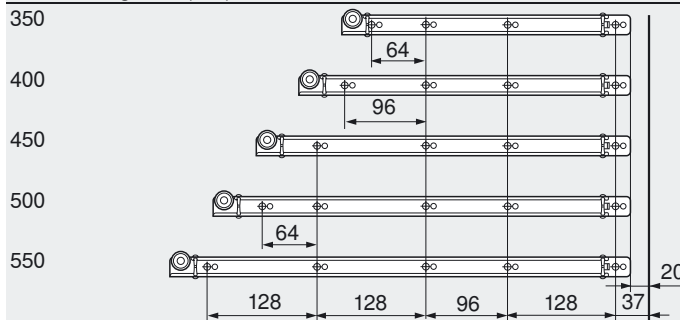

Min. internal cabinet depth = nominal length NL + 12 mm

Over extension = 8 mm

Cabinet profile fixing positions

393

Cutting dimensions for 16 mm chipboard

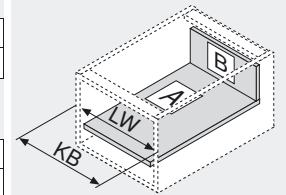
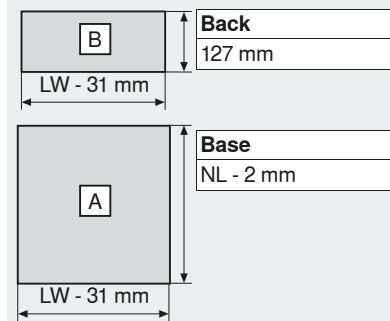

KB Cabinet width
LW Internal cabinet width
NL Nominal length

Base assembly for quick assembly version

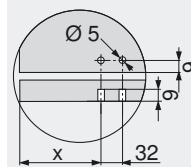

	X (mm)
High fronted pull-out	69

Page instructions

Overview – METABOX	356
Accessories	386
ORGA-LINE-accessories	390
Assembly and adjustment	394
Assembly devices	556
More technical details	658

METABOX – pull-out system

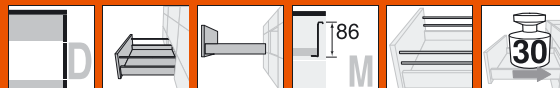

► Basic elements

►► Full extension – high fronted pull-out – double gallery – D

Product



Description

- Full extension with 86 mm high drawer sides
- Epoxy coated steel drawer sides
- Drawer sides in cream (RAL 9001) as standard and in grey (RAL 9006) and white upon request
- High impact nylon rollers
- Dyn. load bearing 30 kg
- BLUMATIC self closing feature
- 3-dimensional front adjustment
- Tool free assembly of gallery system (INSERTA/CLIP)

Space requirement

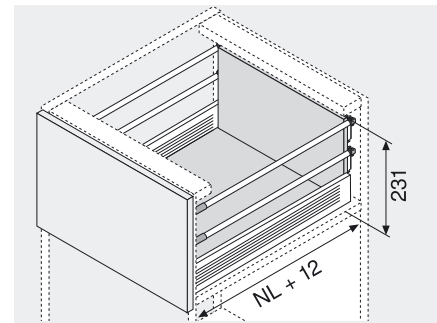

NL Nominal length

Ordering information

1	Cabinet profile, centre profile and drawer side left/right, RAL 9001 cream	
	Nominal length NL	Quick assembly version
	350 mm	330M350PC 330M350PC15
	400 mm	330M400PC 330M400PC15
	450 mm	330M450PC 330M450PC15
	500 mm	330M500PC 330M500PC15
	550 mm	330M550PC 330M550PC15

4	Longside gallery rails with back fixing left/right	
	Nominal length NL	RAL 9001 cream
	350 mm 2 x	ZRE.321S.ID
	400 mm 2 x	ZRE.371S.ID
	450 mm 2 x	ZRE.421S.ID
	500 mm 2 x	ZRE.471S.ID
	550 mm 2 x	ZRE.521S.ID

Other colours available upon request (white or grey)

2a	CLIP-front fixing brackets	
	Screw-on version	ZSF.1200
	Knock-in version	ZSF.1300
	EXPANDO-version	ZSF.130E
	Order left and right	

2b	Cover caps for 2a	
	RAL 9001 cream	ZAA.3700
	Nylon	
	Order left and right	

Alternative to 2a

2c	Standard front fixing brackets left	
	Screw-on version	ZSF.1700
	Knock-in version	ZSF.1800
	Order left and right	

2d	Cover caps for 2c	
	RAL 9001 cream 2 x	ZAA.3500
	Nylon	

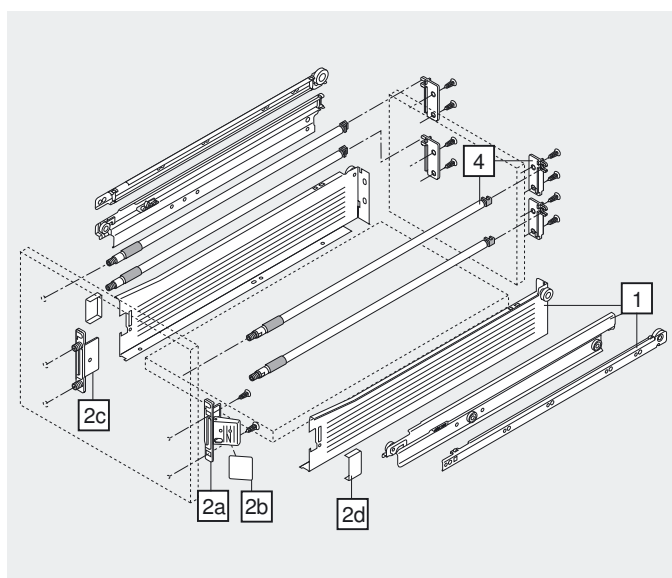

METABOX – pull-out system

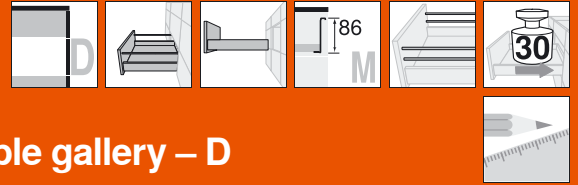

► Basic elements

►► Full extension – high fronted pull-out – double gallery – D

Planning

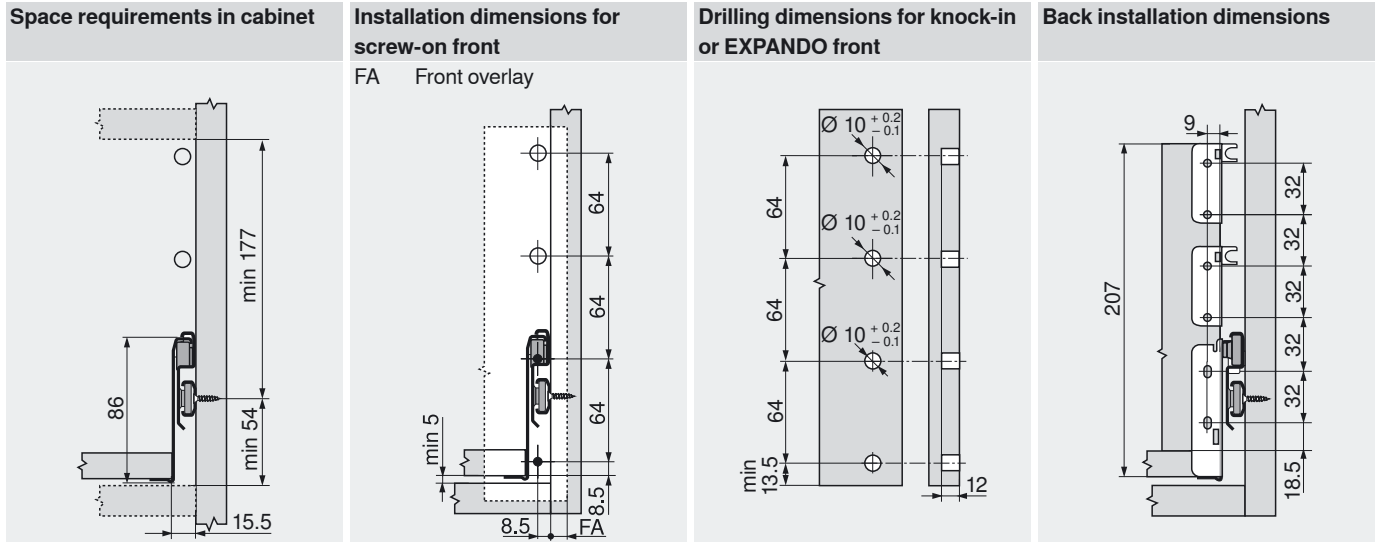

Cabinet profile screw positions

Nominal length NL (mm)

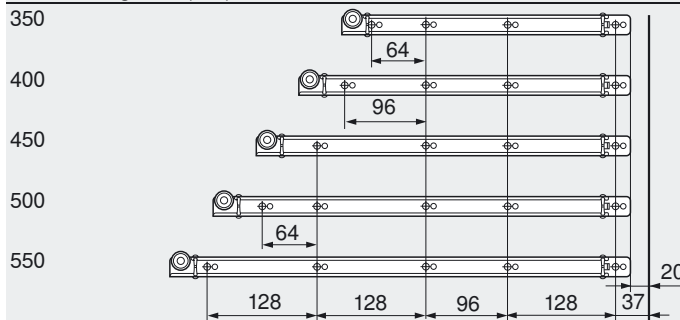

Min. internal cabinet depth = nominal length NL + 12 mm

Over extension = 8 mm

Cabinet profile fixing positions

393

Cutting dimensions for 16 mm chipboard

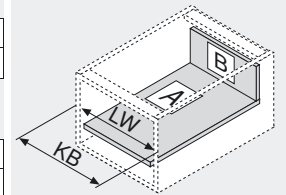
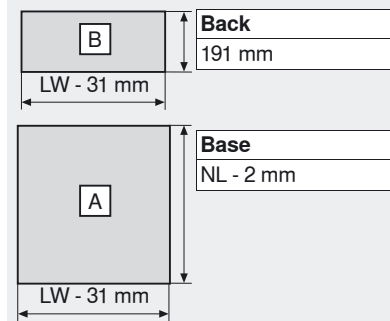

KB Cabinet width
LW Internal cabinet width
NL Nominal length

Base assembly for quick assembly version

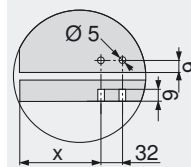

	X (mm)
High fronted pull-out	69

Page instructions

Overview – METABOX	356
Accessories	386
ORGA-LINE-accessories	390
Assembly and adjustment	394
Assembly devices	556
More technical details	658

METABOX – pull-out system

► Basic elements

►► Full extension – high fronted pull-out – BOXSIDE – D

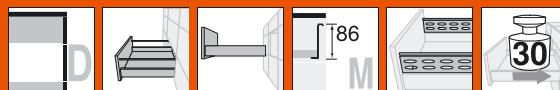

Product



Description

- Full extension with 86 mm high drawer sides
- Epoxy coated steel drawer sides
- Drawer sides in cream (RAL 9001) as standard and in grey (RAL 9006) and white upon request
- High impact nylon rollers
- Dyn. load bearing 30 kg
- BLUMATIC self closing feature
- 3-dimensional front adjustment
- Tool free assembly of gallery system (INSERTA/CLIP)

Space requirement

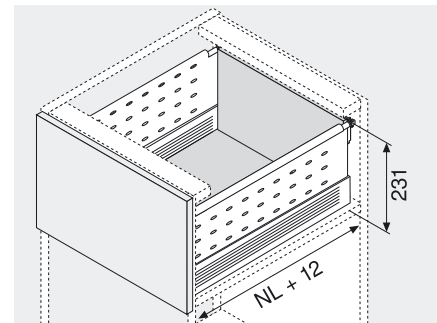

NL Nominal length

Ordering information

1	Cabinet profile, centre profile and drawer side left/right, RAL 9001 cream	
	Nominal length NL	Quick assembly version
	Screw-on version	330M400PC15
400 mm		330M400PC15
450 mm		330M450PC15
500 mm		330M500PC15
550 mm		330M550PC15

4	Longside gallery rails with back fixing left/right	
	Nominal length NL	RAL 9001 cream
400 mm		ZRE.371S.ID
450 mm		ZRE.421S.ID
500 mm		ZRE.471S.ID
550 mm		ZRE.521S.ID

5	Single-wall BOXSIDE	
	Nominal length NL	RAL 9001 cream
400 mm	2 x	Z36H367SE01
450 mm	2 x	Z36H417SE01
500 mm	2 x	Z36H467SE01
550 mm	2 x	Z36H517SE01

2a	CLIP-front fixing brackets	
	Screw-on version	ZSF.1200
	Knock-in version	ZSF.1300
	EXPANDO-version	ZSF.130E
	Order left and right	

2b	Cover caps for 2a	
	RAL 9001 cream	ZAA.3700
	Nylon	
	Order left and right	

Alternative to 2a		
2c	Standard front fixing brackets left	
	Screw-on version	ZSF.1700
	Knock-in version	ZSF.1800
	Order left and right	

2d	Cover caps for 2c	
	RAL 9001 cream	2 x ZAA.3500
	Nylon	

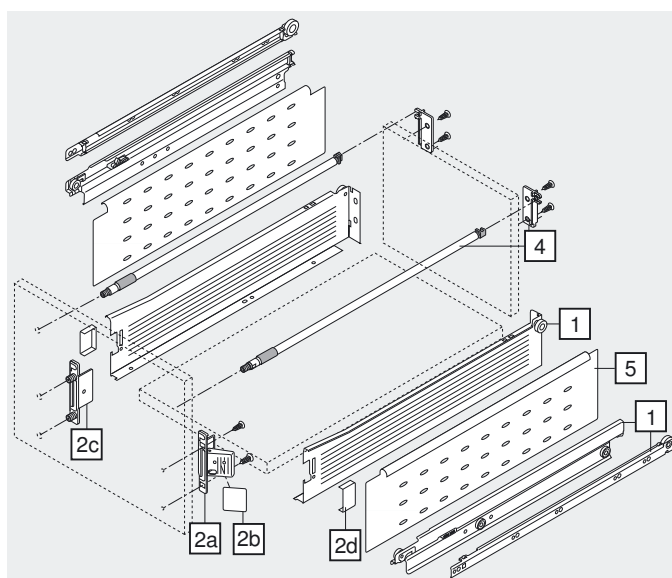

METABOX – pull-out system

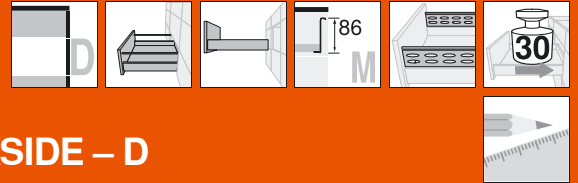

► Basic elements

►► Full extension – high fronted pull-out – BOXSIDE – D

Planning

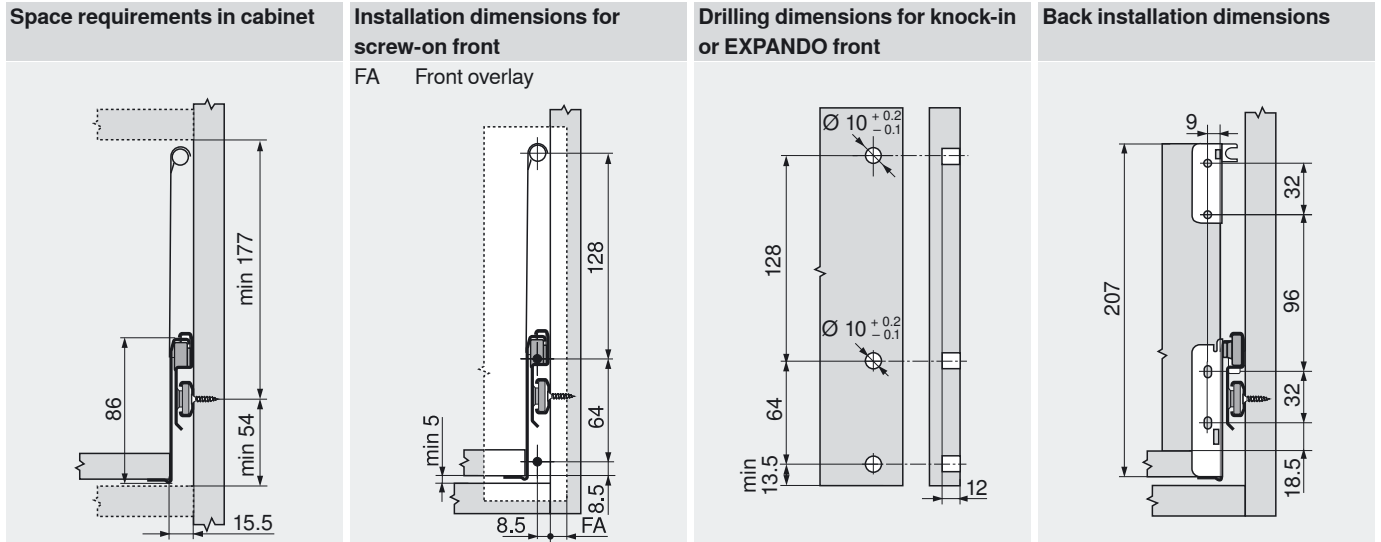

Cabinet profile screw positions

Nominal length NL (mm)

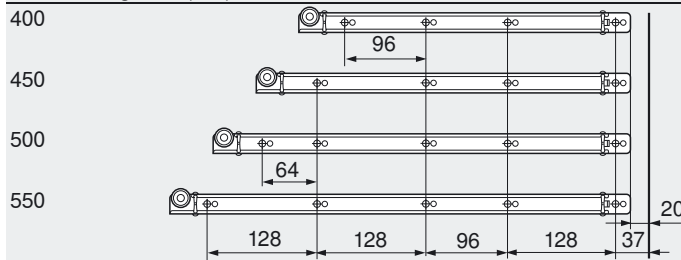

Min. internal cabinet depth = nominal length NL + 12 mm

Over extension = 8 mm

Cabinet profile fixing positions

393

Cutting dimensions for 16 mm chipboard

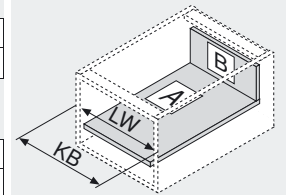
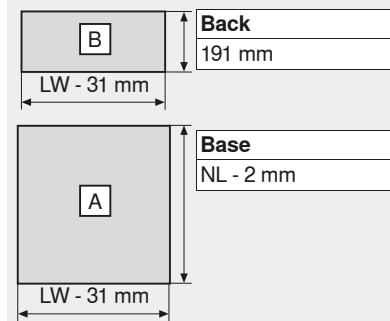

KB Cabinet width
LW Internal cabinet width
NL Nominal length

Base assembly for quick assembly version

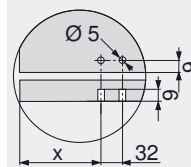

	X (mm)
High fronted pull-out	69

Page instructions

Overview – METABOX	356
Accessories	386
ORGA-LINE-accessories	390
Assembly and adjustment	394
Assembly devices	556
More technical details	658

METABOX – pull-out system



- ▶ Basic elements
- ▶▶ Accessories

Side stabilisation

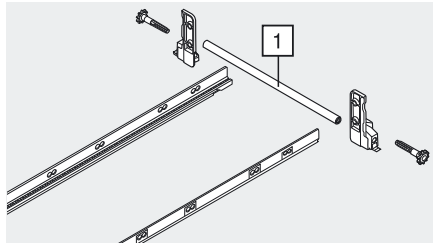
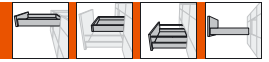

- For full extension with wooden back
- Additional stabilisation for extra wide drawers and high fronted pull-outs

Nominal length	Part no.
450 mm	ZST.450MH
500 mm	ZST.500MH
550 mm	ZST.550MH

Page instructions

Cabinet profile fixing positions

393

1 Cutting

Internal cabinet width LW - 86 mm

Space requirements in cabinet

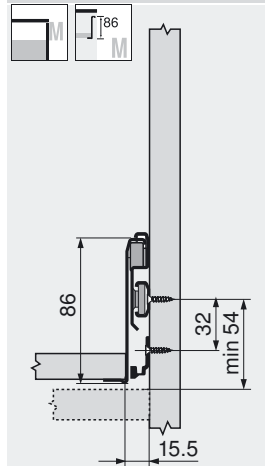

Space requirements in cabinet

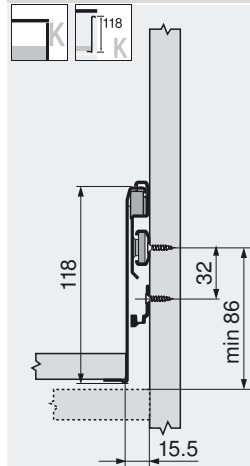

Space requirements in cabinet

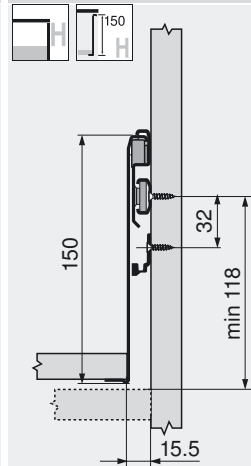

Installation dimensions height M, K and H

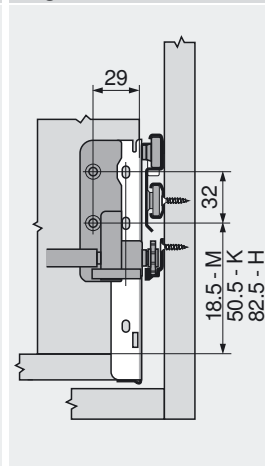

Assembly

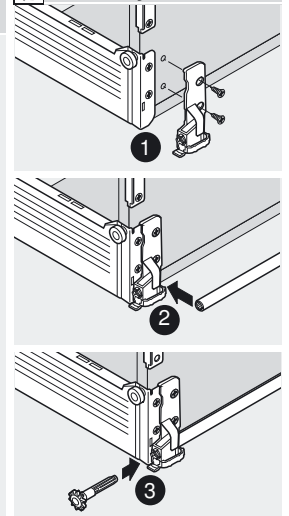

METABOX

Child safety latch 320/330

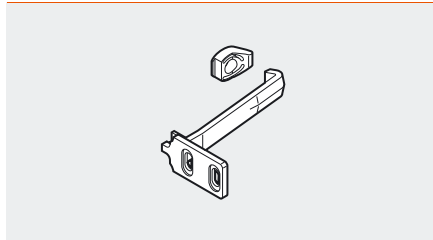
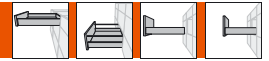

- Made of high impact natural coloured nylon
- To prevent small children from opening the drawer

Nylon	Part no.
natural	295.5500

Cabinet installation dimensions 320

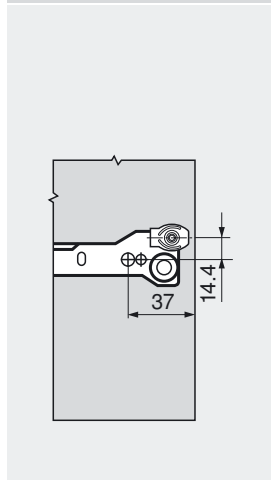

Front installation dimensions 320

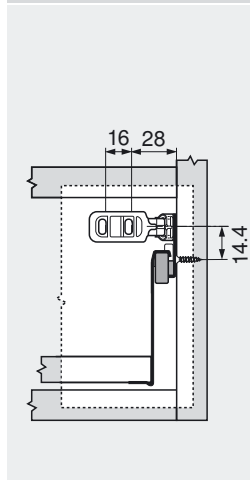

Cabinet installation dimensions 330

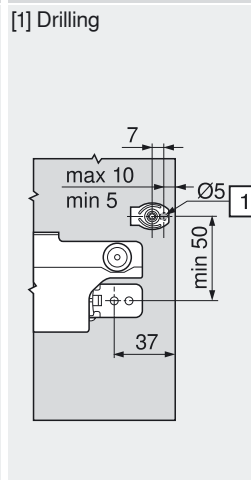

Front installation dimensions 330

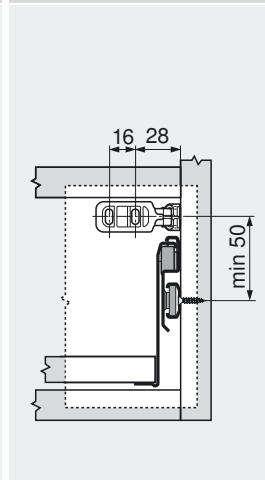

Assembly

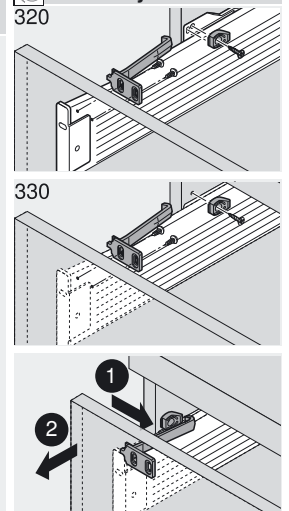

METABOX – pull-out system

a

- ▶ Basic elements
- ▶▶ Accessories

Anti-tilt device

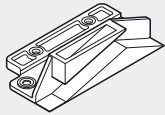

- For central locking of all pull-outs
- In combination with locking systems
- For locking bar systems (suitable for single and full extension drawers)
- If one drawer is open, the others are locked (pull-out lock)
- Please read locking system manufacturer's instructions

Nylon	Part no.
RAL 9001 cream	295.5300

320

320	A	B
N	56	48.5
M	88	80.5
K	120	112.5
H	152	144.5

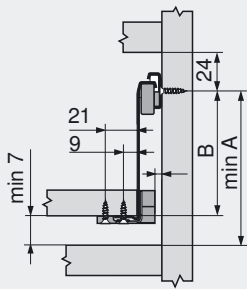

330

330	A	B
M	56	48.5
K	88	80.5
H	120	112.5

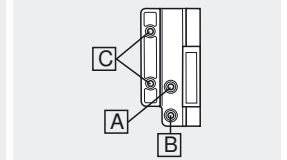
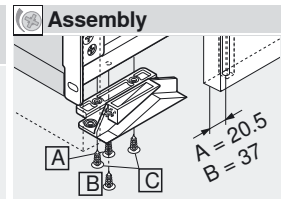
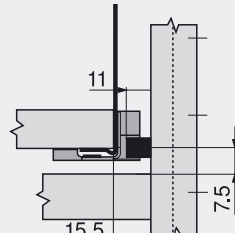
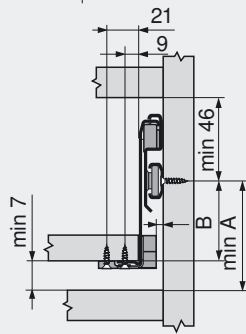

Spacers

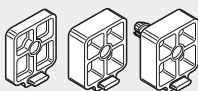

- For inner drawers with single extensions
- Made of high impact nylon RAL 9001 cream
- To space drawers beyond the door protrusion
- Stacking possible (up to 24 mm)
- Screw fixing with version available for pre-drilled Ø 5 mm holes

Spacing	Part no.
4 mm	320M0048
8 mm	320M0088
8 mm with dowel Ø 5 mm	320M0188

Spacer combinations

The number of fixing points required depends on the length of the cabinet profile:

- Up to 450 mm min. 2 fixing points
- Up to 550 mm min. 3 fixing points
- Up to 650 mm min. 4 fixing points

Hinge	Spacer/fixing	Spacers/quantity and part no.		
170°	8 mm		1 x	320M0088
	Ø 4 x 20 mm		1 x	320M0188
100° / 107° / 120°	12 mm	1 x	+	1 x 320M0048
	Ø 4 x 25 mm	1 x	+	1 x 320M0048
Profile/thick door	16 mm		2 x	320M0088
	Ø 4 x 30 mm	1 x	+	1 x 320M0088
Maximum spacing	24 mm		3 x	320M0088
	Ø 4 x 40 mm	1 x	+	2 x 320M0088

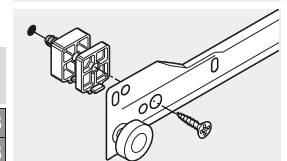
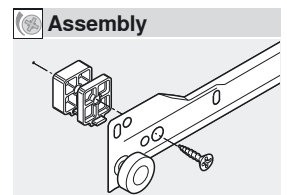

METABOX – pull-out system



- ▶ Basic elements
- ▶▶ Accessories

METAFILE – file drawer

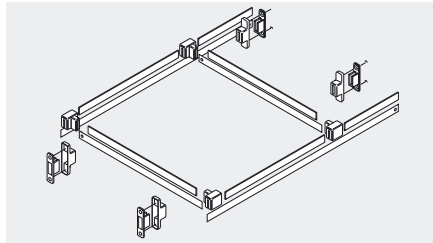
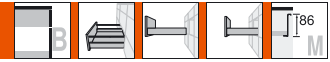

- For METABOX high fronted pull-out basic element, height B with gallery – 25 und 30 kg
- For nominal lengths 450 to 550 mm
- For cabinet widths 275 to 600 mm

Steel/nylon	Part no.
RAL 9001 cream	ZRM.5500

Page instructions	
Basic element	
25 kg B height – single extension	374
30 kg B height – full extension	380

METABOX

Space requirements in cabinet	Installation dimensions for screw-on front	Front drilling dimensions	Back installation dimensions	Assembly
	<p>FA Front overlay</p>	<p>EXPANDO/knock-in assembly</p>		
	<p>FA Front overlay</p>	<p>EXPANDO/knock-in assembly</p>		

DIN-A4 cutting dimensions across

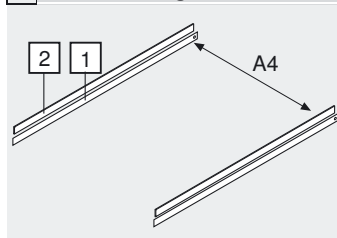

Min. internal width = 376 mm

- [1] Nominal length - 28 mm
- [2] Nominal length - 53 mm

DIN-A4 cutting dimensions lengthwise

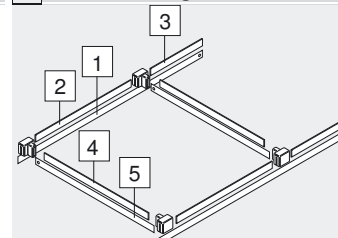

Min. nominal length = 500 mm

- [1] Nominal length - 28 mm
- [2] 305 mm
- [3] Nominal length - 406 mm
- [4] Internal cabinet width - 82 mm
- [5] Internal cabinet width - 59 mm

METABOX – pull-out system

a

- ▶ Basic elements
- ▶▶ Accessories

Contoured profile

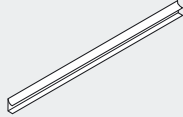

- Screw-on version
- For 16 mm base
- Nylon, RAL 9001 cream

Cutting dim. for 16 mm chipboard

Standard drawer
NL - 2 mm
Inner drawer
NL - 18 mm

For cutting to size, 1200 mm	Part no.
RAL 9001 cream	ZSD.1200S

Cutting
Nominal length NL - 18 mm

Pull-out stop 320



- Made of high impact natural coloured nylon
- To prevent accidental removal of drawer specially for cutlery or machine/appliance pull-outs

Assembly

Nylon	Part no.
natural	320M0009.01

Pull-out stop 330



- Made of high impact nylon
- To prevent accidental removal of drawer specially for cutlery or machine/appliance pull-outs

Assembly

Nylon	Part no.
orange	330.0029

POSISTOP 320

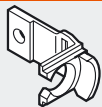

- Stop in runner system
- Made of high impact natural coloured nylon
- Developed to relieve pressure on the drawer front
- For single extension only
- Produces either a 1.5 or 3 mm gap
- Symmetrical

Assembly

Gap	Part no.
1.5 mm	298.3210.01
3 mm	298.3230.01

POSISTOP 330

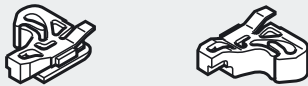

- Stop in runner system
- Made of high impact natural coloured nylon
- Developed to relieve pressure on the drawer front
- For full extensions only
- Produces a 1.5 mm gap

Assembly

Left and right	Part no.
natural	330.0028

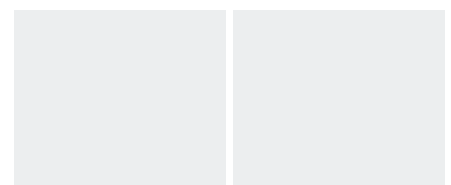
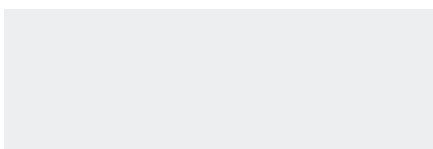

METABOX

METABOX – pull-out system

a

► Basic elements

►► Accessories – ORGA-LINE

Cross gallery rails for cutting to size

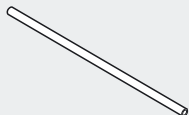

- Cross gallery rails for cutting to size
- Material: aluminium

For cutting to size, 1104 mm	Part no.
RAL 9001 cream	ZRG.1104U

Cutting
Internal cabinet width LW - 65 mm
For cabinet width KB 1200 mm already cut to size!

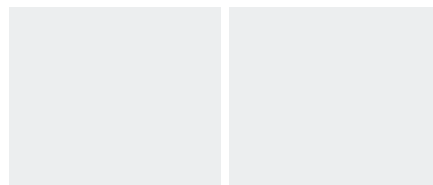

Gallery connector



- Clip-on to gallery
- Connects the cross gallery with BOXSIDE
- Material: nylon/steel

Nylon/steel	Part no.
RAL 9001 cream	ZRU.10B1E

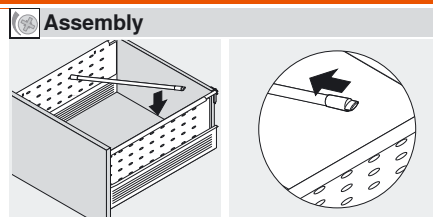

Cross gallery rails for cutting to size

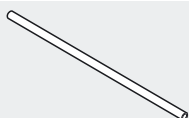

- Cross gallery rails for cutting to size
- Material: aluminium

For cutting to size, 1104 mm	Part no.
RAL 9001 cream	ZRG.1104U

Cutting
Internal cabinet width LW - 58 mm
For cabinet width KB 1200 mm already cut to size!

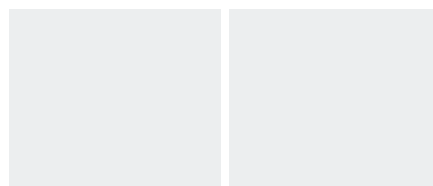

Cross gallery connector



- Cross gallery connector made of high impact nylon for two gallery rails
- Slide-on connection of gallery to gallery fixing
- Insertion and screw-on fixing

Nylon	Part no.
RAL 9001 cream	ZRU.00Z0

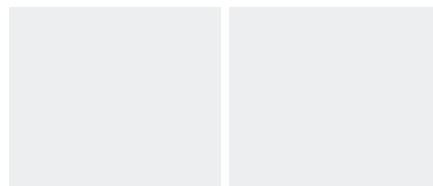

Lateral divider



- Gallery division
- Material: nylon
- Clip-on fixing to gallery

Nylon	Part no.
RAL 9001 cream	ZRU.00F0

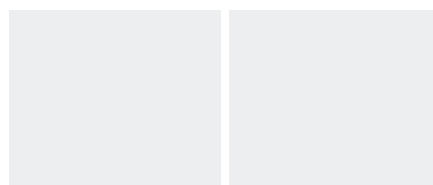
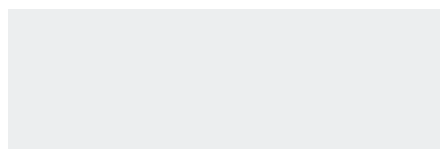
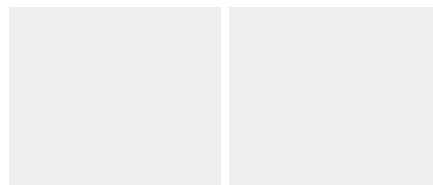

METABOX

METABOX – pull-out system

a

► Basic elements

►► Accessories

Chipboard screws

Ø 3.5 mm

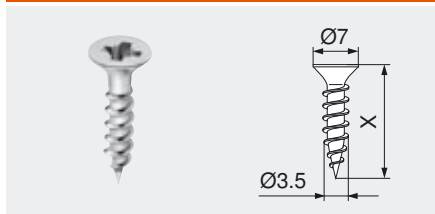

- Nickel plated
- Ø 3.5 mm

Length (X)	Part no.
15 mm	609.1500
17 mm	609.1700

System screws

Ø 6.0 mm

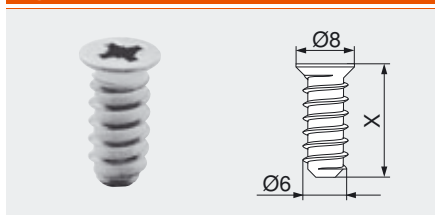

- Nickel plated
- Ø 6 mm
- Drilling diameter 5 mm

Length (X)	Part no.
10 mm	661.1000.HG
11.5 mm	661.1150.HG
13 mm	661.1300.HG
14.5 mm	661.1450.HG
20 mm	661.2000.HG

Special system screws

Ø 6.0 mm



- Nickel plated
- Ø 6 mm
- Drilling diameter 5 mm

Length (X)	Part no.
11.5 mm	662.1150.HG
13 mm	662.1300.HG
14.5 mm	662.1450.HG

Centre bit

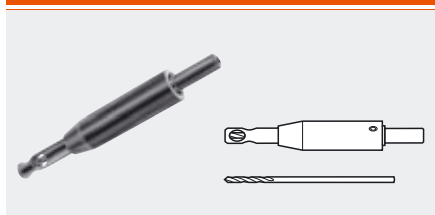

- Hardened
- Ø 2.7 mm, length 70 mm
- To pre-drill for Ø 3.5 mm chipboard screws
- Drilling depth up to 8 mm

	Part no.
Centre bit	M01.ZZ03
Drill bit	M01.ZZB3

Stick-on door buffer

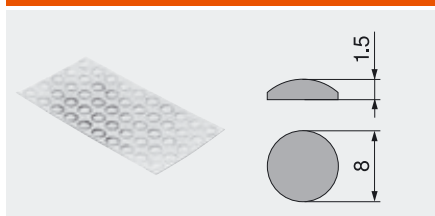

- For noise reduction

Nylon	Part no.
natural	993.710

8 mm Ø door buffer

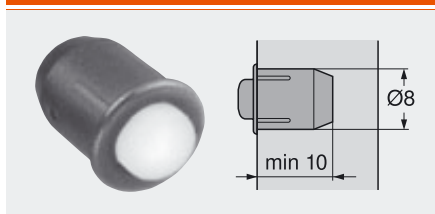

- For noise reduction
- Gap 2 mm
- Two-part

Nylon	Part no.
RAL 9006 white aluminium	993.706

METABOX

METABOX – pull-out system

a

▶ Basic elements

▶▶ Accessories

Phillips screwdriver



- PZ (Pozi) size 2
- Blade length 100 mm
- Overall length 200 mm
- Orange handle with Blum logo

Nylon/steel	Part no.
orange	303.756.1

Slotted screwdriver



- Slotted, size 1.0 x 5.5 mm
- Blade length 125 mm
- Overall length 225 mm
- Orange handle with Blum logo

Nylon/steel	Part no.
orange	314.928.1

METABOX

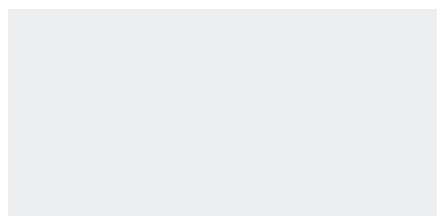
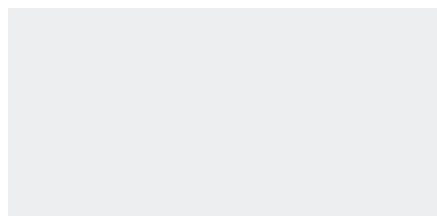
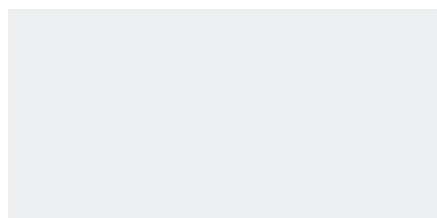
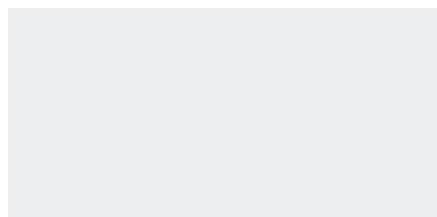

METABOX – pull-out system



► Basic elements

►► Cabinet profile fixing positions

Cabinet profile 320 – 25 kg

Fixing onto cabinet

- A Chipboard screws
Ø 4 x 15 mm
- B Chipboard screws
Part no. 661.145
- C Chipboard screws
Ø 3.5 x 15 mm
For high fronted pull-out

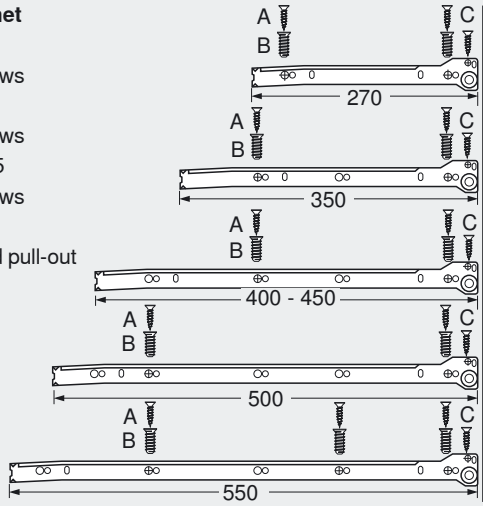

Cabinet profile 330 – 30 kg

Fixing onto cabinet

- A Chipboard screws
Ø 4 x 15 mm
- B Chipboard screws
Part no. 661.145

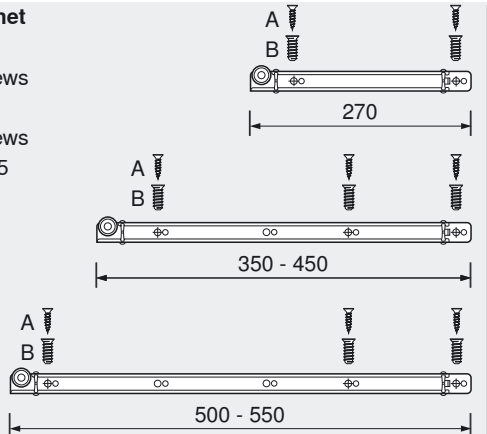

ZST – lateral stabiliser

Nominal length NL (mm)

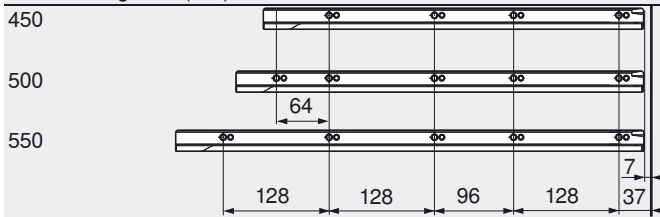

Min. internal cabinet depth = nominal length NL + 25 mm

METABOX – pull-out system



► Basic elements

►► Assembly, removal and adjustment

Drawer 320/330 N

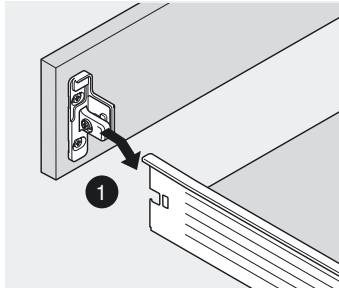

ZSF.1510/1610 Assembly

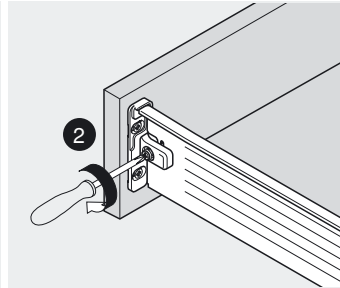

Assembly

Inner drawer 320/330 N

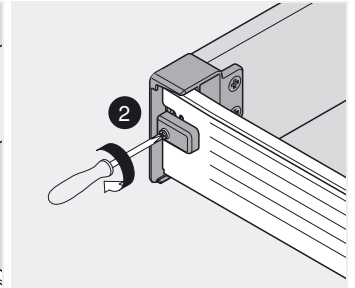
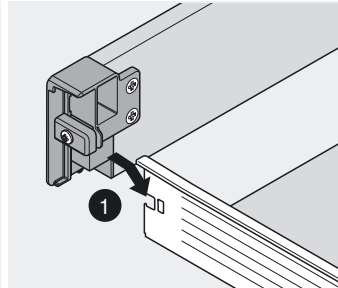

Drawer 320/330 M/K/H

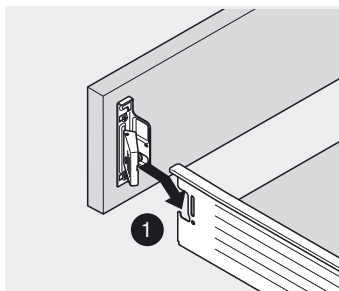

ZSF.1200/1300/130E Assembly

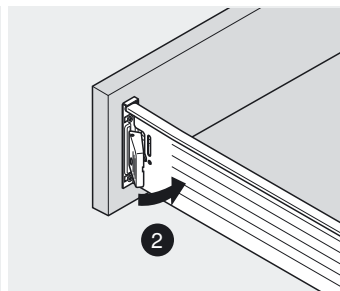

ZSF.1700/1800 Assembly

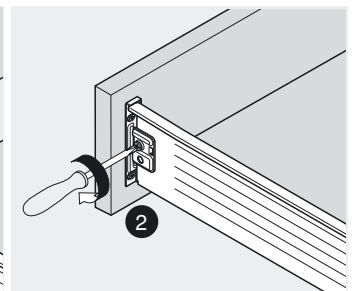
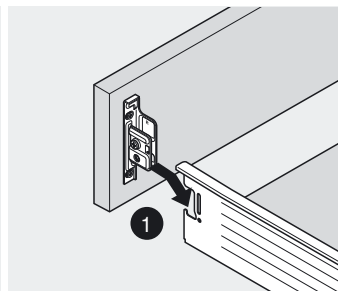

Inner drawer 320/330 M/K/H

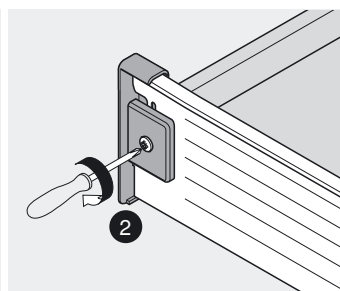
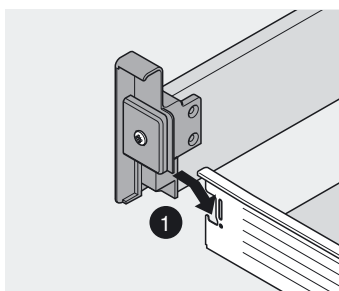

Assembly

High fronted pull-out

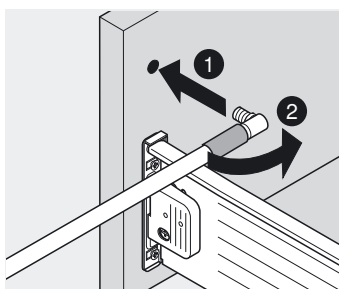

Front assembly

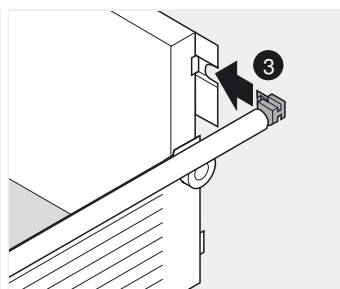

Back assembly

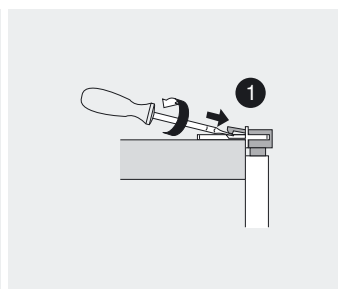

Back removal

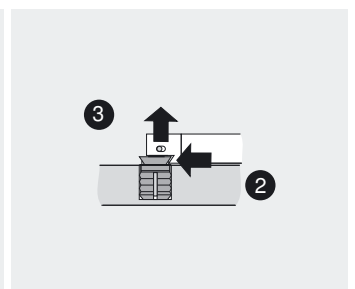

Front removal

METABOX – pull-out system



► Basic elements

►► Assembly, removal and adjustment

Drawer – wooden back

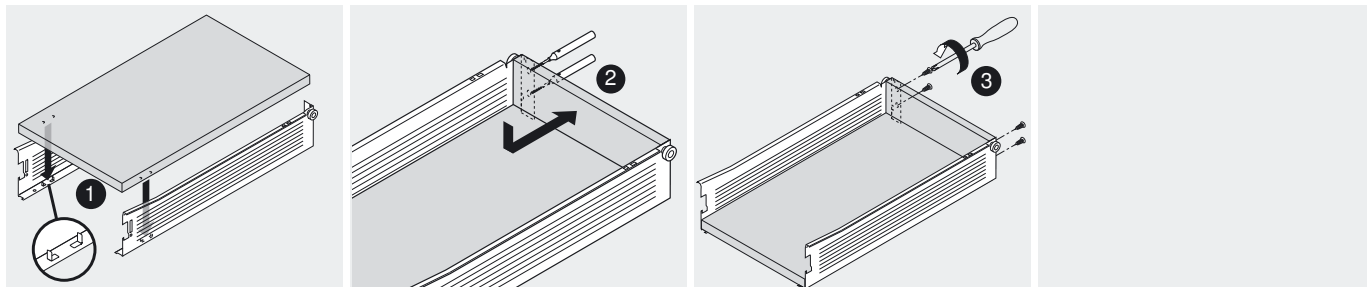

Drawer insertion and removal

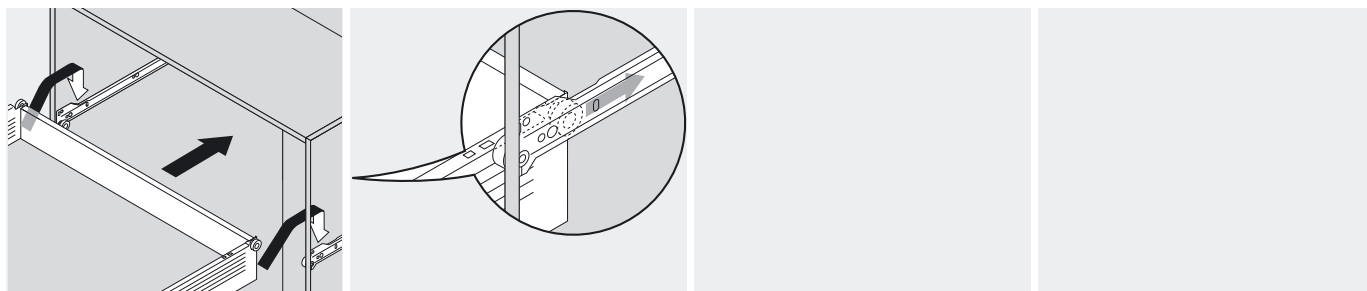

320

Drawer insertion and removal

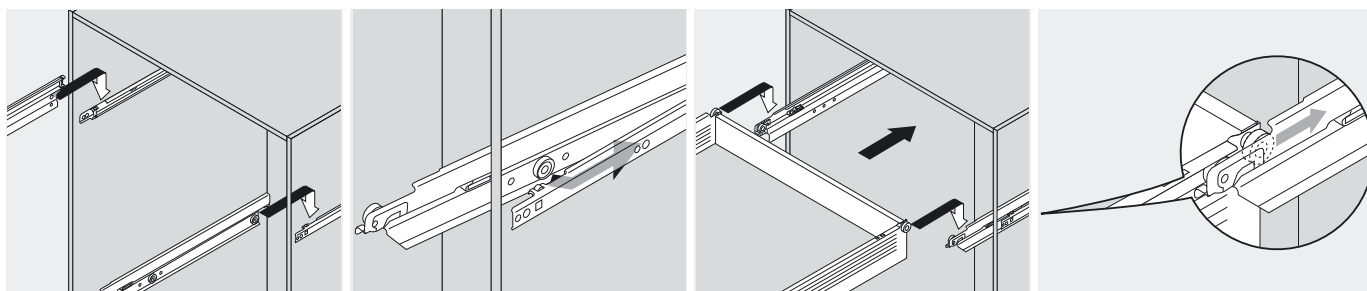

330

METABOX

METABOX – pull-out system



► Basic elements

►► Assembly, removal and adjustment

Side adjustment

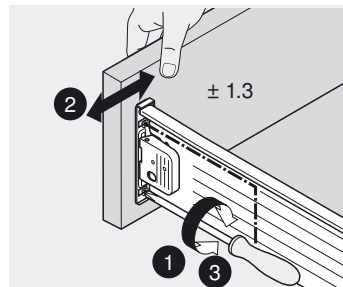

ZSF.1200/1300/130E

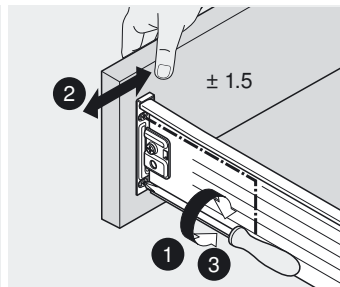

ZSF.1700/1800

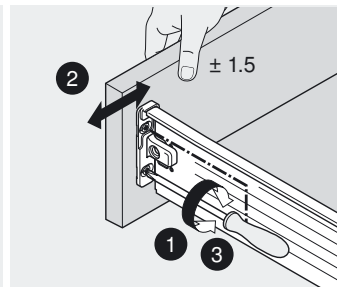

ZSF.1510/1610

Tilt adjustment

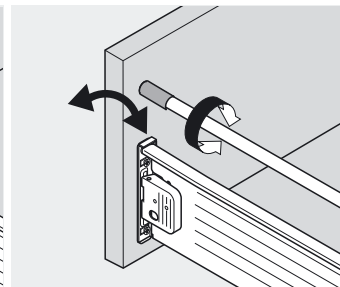

ZSF.1200/1300/130E/1700

Height adjustment

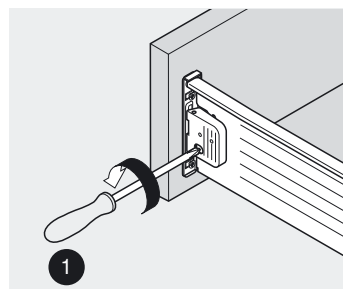

ZSF.1200/1300/130E

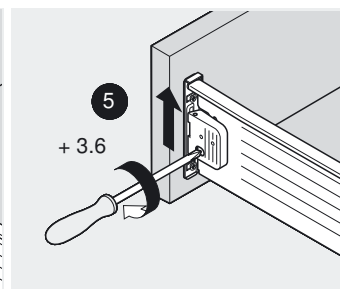
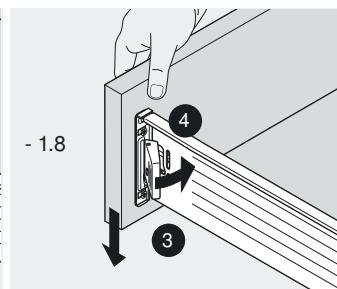
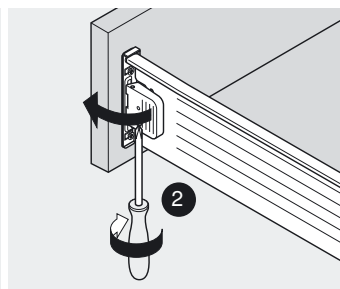

METABOX

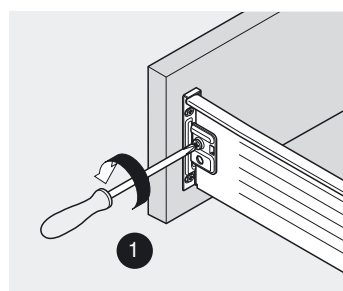

ZSF.1700/1800

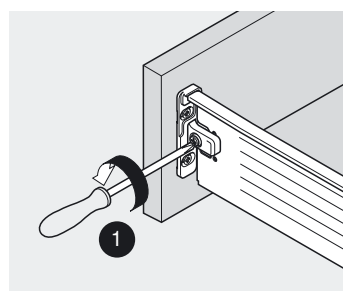
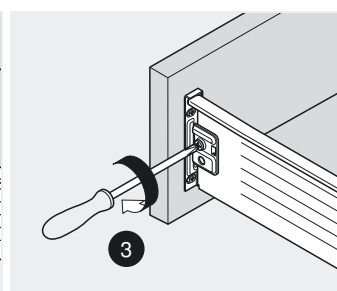
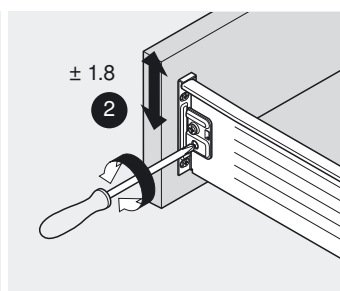

ZSF.1510/1610

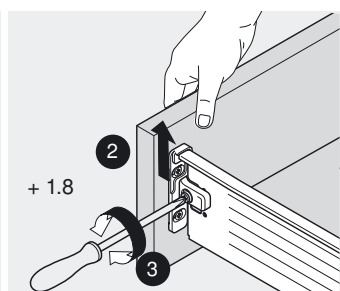

METABOX – pull-out system

► Basic elements



METABOX