

Runner systems



- ▶ TANDEM
- ▶▶ TANDEM 19 mm – locking device feature – full extension

TANDEM plus BLUMOTION 560F | 566F

Webcode
DQHL6M



- Runner for wooden drawers with a panel thickness of 17–19 mm
- Concealed **TANDEM** full extension with integrated **BLUMOTION** for silent and effortless closing action
- Suitable for use with **SERVO-DRIVE** – the electrical opening support system
- Low-friction cylindrical rollers ensure a feather-light glide
- Tool-free height adjustment via a locking device
- Tool-free integrated front tilt adjustment
- Built-in width and depth tolerance compensation

Space requirement

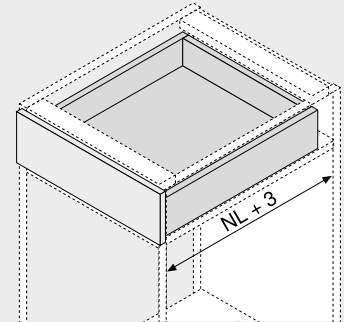

NL Nominal length

Order information

1		Runners left/right	
Nominal length NL (mm)	Dynamic carrying capacity (kg)		
	30	50	
250	560F2500B		
270	560F2700B		
300	560F3000B		
350	560F3500B		
400	560F4000B		
450	560F4500B	566F4500B	
500	560F5000B	566F5000B	
550	560F5500B	566F5500B	
600	560F6000B	566F6000B	
650		566F6500B	
700		566F7000B	
750		566F7500B	

3		Locking device left/right	
Colour	Material	Part no.	
Orange	Nylon/zinc	T51.1700.04	

Order left/right

Accessories

4		Front adjuster	
Colour	Material	Part no.	
Natural	Nylon	295.1000	

5		POSISTOP	
Colour	Material	Part no.	
RAL 7037 dust grey	Nylon	298.5500	

Depth stop

Drawer

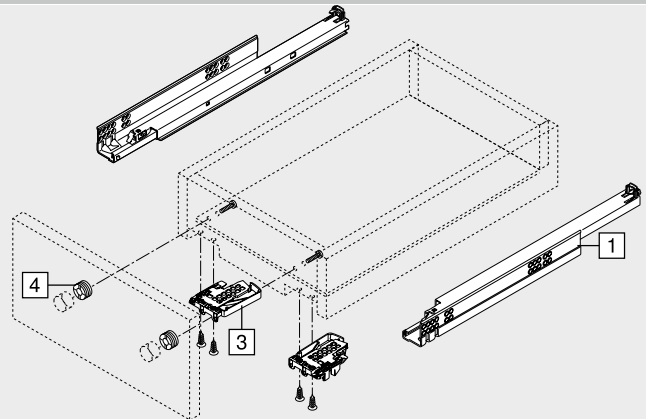

Inner drawer

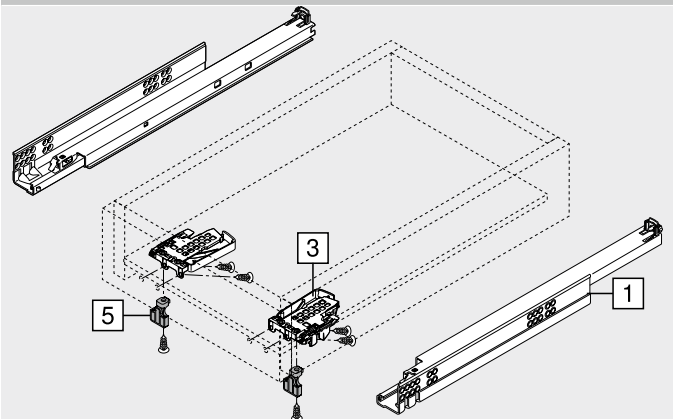

TANDEM plus BLUMOTION 560F | 566F

Webcode
DQHL6M

Planning

Space requirement in cabinet	Drawer inner drawer	Drawer	Inner drawer
	<p>SKW Internal drawer width LW Internal cabinet width</p>	<p>SKL Drawer length NL Nominal length</p>	<p>ISKL Inner drawer length SKL Drawer length NL Nominal length X Front thickness * Additional +2 mm with POSISTOP</p>

Hole spacing – runners

Nominal length NL (mm)	Hole spacing diagram
250 270	
300 350	
400	
450	
500 550	
600	
650 700 750	

* Hole only at 566F (50 kg)

Drawer assembly

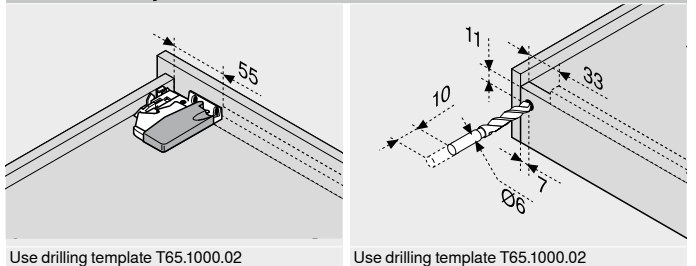

Use drilling template T65.1000.02

Use drilling template T65.1000.02

Page instructions

Overview – TANDEM	409	TANDEM 19 mm
Overview – SERVO-DRIVE for MOVENTO TANDEM	455	
CABLOXX	552	Short-URL
Accessories	444	www.blum.com/i011
Attachment of runners	452	
Overview – assembly devices	561	
More technical details	662	



Assembly, removal and adjustment

Short-URL
www.blum.com/a420



Runner systems



- ▶ TANDEM
- ▶▶ TANDEM 19 mm – locking device feature – full extension

TANDEM plus 560F

Webcode
DQHLVY



- Runner for wooden drawers with a panel thickness of 17–19 mm
- Concealed **TANDEM** full extension with integrated **BLUMATIC** self-insertion technology
- Suitable for use with **TIP-ON** – the mechanical opening support system
- Low-friction cylindrical rollers ensure a feather-light glide
- Tool-free height adjustment via a locking device
- Tool-free integrated front tilt adjustment
- Built-in width and depth tolerance compensation

Space requirement

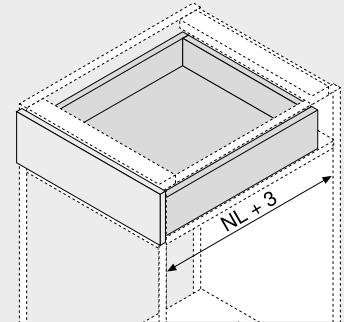

NL Nominal length

Order information

1	Runners left/right	
Nominal length	Dynamic carrying capacity (kg)	
NL (mm)	30	
250	560F2500C	
270	560F2700C	
300	560F3000C	
350	560F3500C	
400	560F4000C	
450	560F4500C	
500	560F5000C	
550	560F5500C	
600	560F6000C	

The output path can vary depending on the load or the adjustment!

3	Locking device left/right		
	Colour	Material	Part no.
	Orange	Nylon/zinc	T51.1700.04

Order left/right

Accessories

4	Front adjuster		
	Colour	Material	Part no.
	Natural	Nylon	295.1000

6a	TIP-ON left/right	
	Dynamic carrying capacity (kg)	Part no.
	30	T55.7150S

Only suitable for TANDEM plus

6b	TIP-ON synchronisation pinion set		
	Colour	Version	Part no.
	RAL 7037 dust grey	Semicircular	T55.000R

6c	TIP-ON synchronisation linkage		
	Cabinet width KB (mm)	Version	Part no.
	Up to 1200	Semicircular	T55.882W

For cutting to size
Starting with cabinet width KB 600 mm
Cutting Internal cabinet width LW – 284 mm

Alternative to 6b | 6c

6d	TIP-ON synchronisation pinion set and shaft		
	Cabinet width KB (mm)	Version	Part no.
	Up to 1400	Round	T55.1089ZR

For cutting to size
Cutting Internal cabinet width LW – 284 mm

Drawer

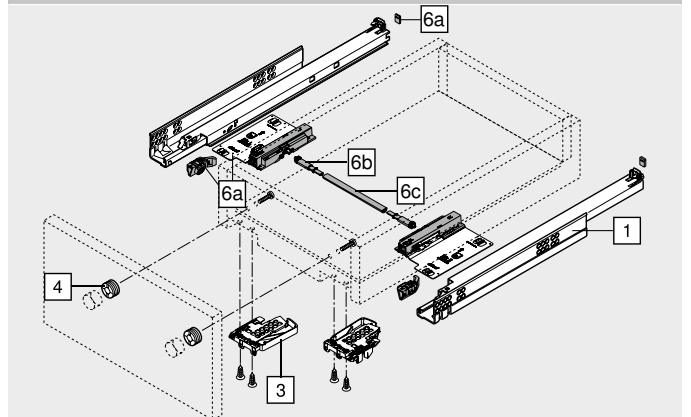

TANDEM plus 560F

Webcode
 DQHLYV

Planning

Space requirement in cabinet	Drawer inner drawer	Drawer	Inner drawer
* +1 mm with TIP-ON	SKW Internal drawer width LW Internal cabinet width	SKL Drawer length NL Nominal length	ISKL Inner drawer length SKL Drawer length NL Nominal length X Front thickness * Additional +4 mm with TIP-ON

Hole spacing – runners

Nominal length NL (mm)	Hole spacing diagram
250 270	
300 350	
400	
450	
500 550	
600	

Drawer assembly

Use drilling template T65.1000.02	Use drilling template T65.1000.02 * 85 mm with TIP-ON

Trigger range

Example for 560F – 30 kg, nominal length NL 500 mm, four sided drawer, with synchronisation

Page instructions

Overview – TANDEM	409	TANDEM 19 mm
CABLOXX	552	
Accessories	444	
Attachment of runners	452	Short-URL
Overview – assembly devices	561	www.blum.com/i011
More technical details	662	



Assembly, removal and adjustment

Short-URL	www.blum.com/a420
-----------	--





- ▶ TANDEM
- ▶▶ TANDEM 19 mm – locking device feature – single extension

TANDEM BLUMOTION 550F

Webcode
DQHMLA



- Runner for wooden drawers with a panel thickness of 17–19 mm
- Concealed **TANDEM** single extension with soft end stop when opening and integrated **BLUMOTION** for silent and effortless closing
- Suitable for use with **SERVO-DRIVE** – the electrical opening support system
- Low-friction cylindrical rollers ensure a feather-light glide
- Tool-free height adjustment via a locking device
- Built-in width and depth tolerance compensation

Space requirement

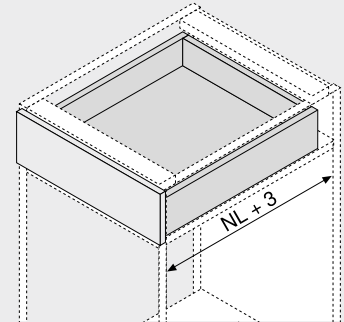

NL Nominal length

Order information

1	Runners left/right	
Nominal length NL (mm)	Dynamic carrying capacity (kg)	
270	550F2700B	
300	550F3000B	
350	550F3500B	
400	550F4000B	
450	550F4500B	
500	550F5000B	
550	550F5500B	
600	550F6000B	
650	550F6500B	

3	Locking device left/right		
	Colour	Material	Part no.
	Orange	Nylon/zinc	T51.1700.04
Order left/right			

Accessories

4	Front adjuster		
	Colour	Material	Part no.
	Natural	Nylon	295.1000

5	POSISTOP		
	Colour	Material	Part no.
	RAL 7037 dust grey	Nylon	298.5500
Depth stop			

Drawer

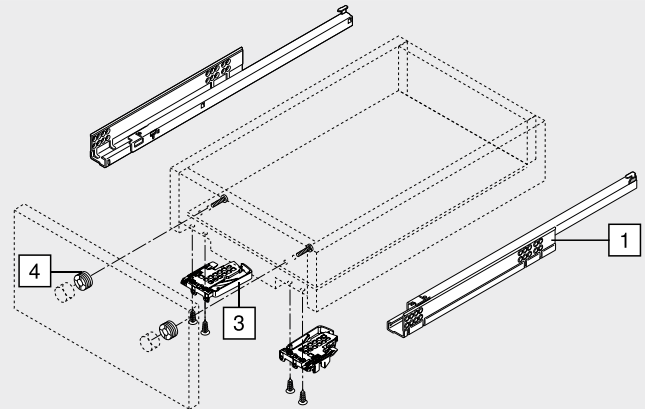

Inner drawer

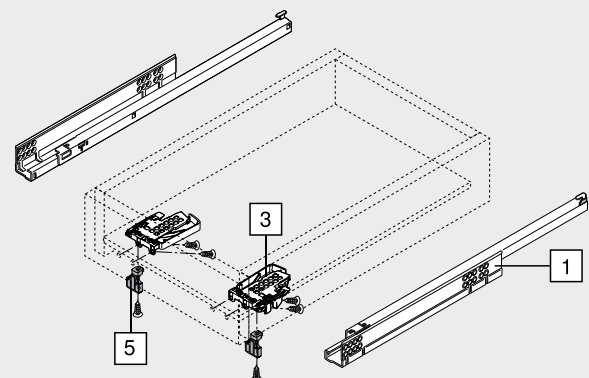

TANDEM BLUMOTION 550F

Webcode
 DQHMLA

Planning

Space requirement in cabinet	Drawer inner drawer	Drawer	Inner drawer
A 3 mm distance to interchange with full extension	SKW Internal drawer width LW Internal cabinet width	SKL Drawer length NL Nominal length	ISKL Inner drawer length SKL Drawer length NL Nominal length X Front thickness * Additional +2 mm with POSISTOP

Hole spacing – runners

Nominal length NL (mm)

270	
300 350 400 450	
500 550	
600	
650	

Drawer assembly

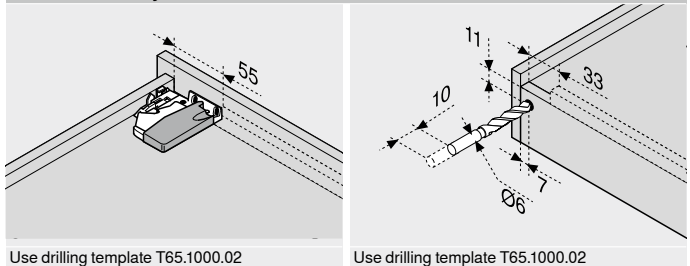

Use drilling template T65.1000.02

Use drilling template T65.1000.02

Page instructions

Overview – TANDEM	409	TANDEM 19 mm
Overview – SERVO-DRIVE for MOVENTO TANDEM	455	
CABLOXX	552	Short-URL
Accessories	444	www.blum.com/i011
Attachment of runners	452	
Overview – assembly devices	561	
More technical details	662	



Assembly, removal and adjustment

Short-URL	www.blum.com/a420
-----------	--



Runner systems



- ▶ TANDEM
- ▶▶ TANDEM 19 mm – locking device feature – single extension

TANDEM 550F

Webcode

DQHNAM



- Runner for wooden drawers with a panel thickness of **17–19 mm**
- Concealed **TANDEM** single extension with soft end stop when opening and integrated **BLUMATIC** self-insertion technology
- Suitable for use with **TIP-ON** – the mechanical opening support system
- Low-friction cylindrical rollers ensure a feather-light glide
- Tool-free height adjustment via a locking device
- Built-in width and depth tolerance compensation

Space requirement

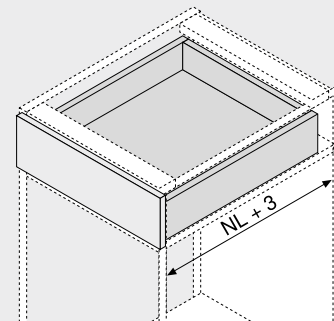

NL Nominal length

Order information

1		Runners left/right
Nominal length NL (mm)	Dynamic carrying capacity (kg)	
270	550F2700	
300	550F3000	
350	550F3500	
400	550F4000	
450	550F4500	
500	550F5000	
550	550F5500	
600	550F6000	
650	550F6500	

The output path can vary depending on the load or the adjustment!

3		Locking device left/right
Colour	Material	Part no.
Orange	Nylon/zinc	T51.1700.04

Order left/right

Accessories

4		Front adjuster
Colour	Material	Part no.
Natural	Nylon	295.1000

6a		TIP-ON left/right
Dynamic carrying capacity (kg)	Part no.	
30	T55.1150S	

Only suitable for TANDEM

6b		TIP-ON synchronisation pinion set
Colour	Version	Part no.
RAL 7037 dust grey	Semicircular	T55.000R

6c		TIP-ON synchronisation linkage
Cabinet width KB (mm)	Version	Part no.
Up to 1200	Semicircular	T55.882W

For cutting to size

Starting with cabinet width KB 600 mm

Cutting Internal cabinet width LW – 284 mm

Drawer

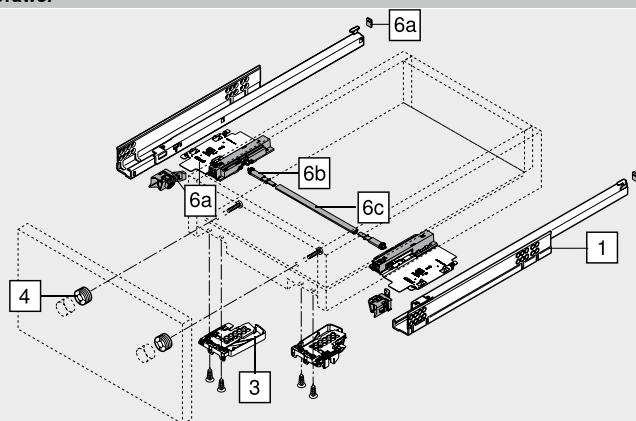



TANDEM 550F

Webcode
 DQHNAM

Planning

Space requirement in cabinet

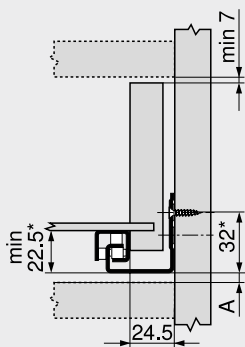

A 5 mm distance to interchange with full extension
 * +1 mm with TIP-ON

Drawer | inner drawer

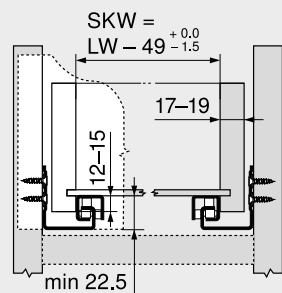

SKW Internal drawer width
 LW Internal cabinet width

Drawer

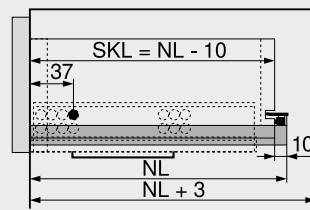

SKL Drawer length
 NL Nominal length

Inner drawer

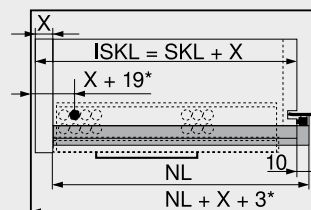

ISKL Inner drawer length
 SKL Drawer length
 NL Nominal length
 X Front thickness
 * Additional +4 mm with TIP-ON

Hole spacing – runners

Nominal length NL (mm)

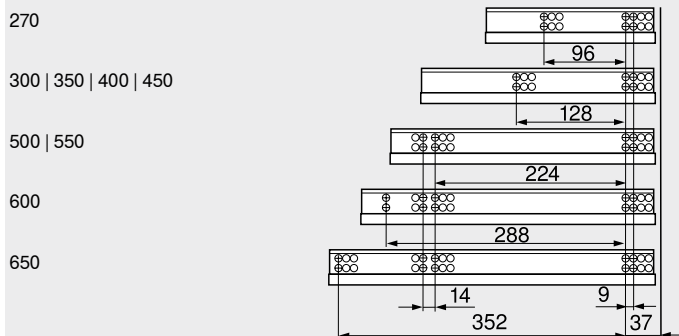

Drawer assembly

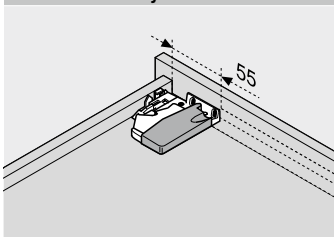

Use drilling template T65.1000.02

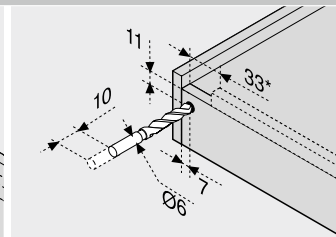

Use drilling template T65.1000.02
 * 85 mm with TIP-ON

Trigger range

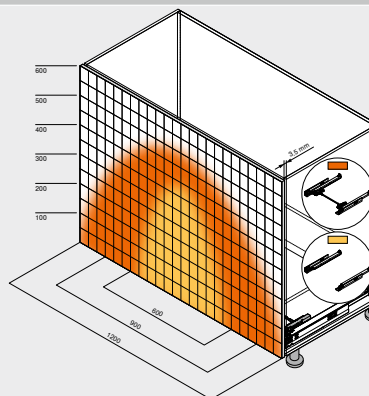

Example for 560F – 30 kg, nominal length NL 500 mm, four sided drawer, with synchronisation

Page instructions

Overview – TANDEM	409	TANDEM 19 mm
Accessories	444	
Attachment of runners	452	
CABLOXX	552	Short-URL
Overview – assembly devices	561	www.blum.com/i011
More technical details	662	



Assembly, removal and adjustment

Short-URL
www.blum.com/a420





- ▶ **TANDEM**
- ▶▶ **TANDEM 19 mm – hook and peg variant – full extension**

TANDEM plus BLUMOTION 561F

Webcode

DQHNZY







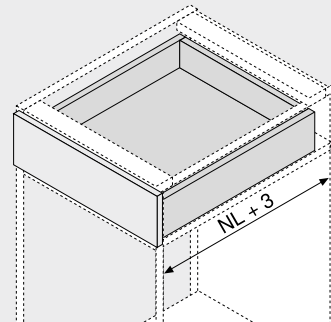



- Runner for wooden drawers with a panel thickness of **17–19 mm**
- Concealed **TANDEM** full extension with integrated **BLUMOTION** for silent and effortless closing action
- Suitable for use with **SERVO-DRIVE** – the electrical opening support system
- Low-friction cylindrical rollers ensure a feather-light glide
- Lift-off stop and height adjustment integrated into runner system
- Tool-free integrated front tilt adjustment

Space requirement



NL Nominal length

Order information

1		Runners left/right	
Nominal length NL (mm)		Dynamic carrying capacity (kg)	
260		561F2601B	
310		561F3101B	
360		561F3601B	
410		561F4101B	
460		561F4601B	
510		561F5101B	
560		561F5601B	

Accessories

4		Front adjuster	
	Colour	Material	Part no.
	Natural	Nylon	295.1000

Drawer

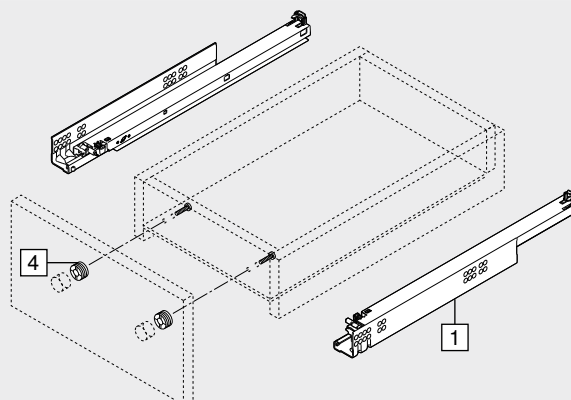

Inner drawer

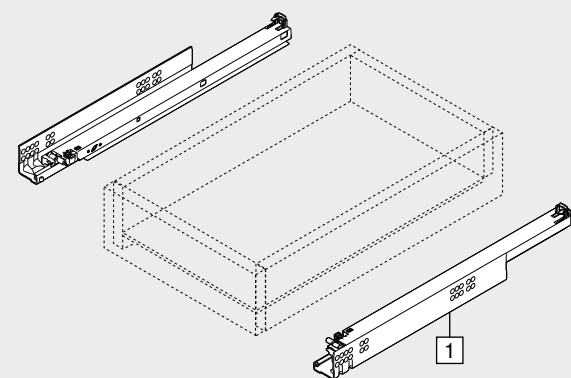

TANDEM plus BLUMOTION 561F

Webcode
DQHNZY

Planning

Space requirement in cabinet	Drawer inner drawer	Drawer	Inner drawer
	SKW Internal drawer width LW Internal cabinet width	SKL Drawer length NL Nominal length	ISKL Inner drawer length SKL Drawer length NL Nominal length X Front thickness

Hole spacing – runners
 Nominal length NL (mm)

260	
310 360	
410	
460	
510	
560	

64 14 32 9 224 37

Drawer assembly

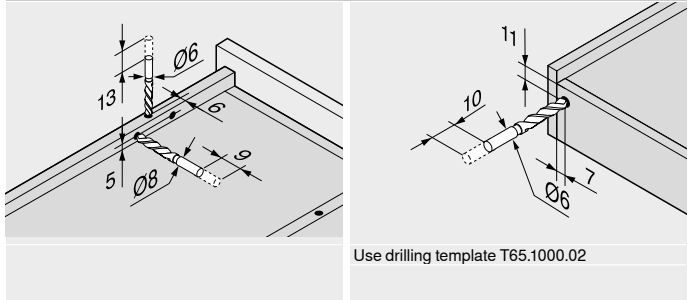

Drawer assembly

Nominal length NL (mm)	Pegs	
	X2 (mm)	X3 (mm)
260	205	185
310	230	242
360	275	287
410	300	344
460	335	379
510	360	436
560	405	481

Page instructions

Overview – TANDEM	409	TANDEM 19 mm
Overview – SERVO-DRIVE for MOVENTO TANDEM	455	
CABLOXX	552	Short-URL
Accessories	444	www.blum.com/i011
Attachment of runners	452	
Overview – assembly devices	561	
More technical details	662	



Assembly, removal and adjustment

Short-URL
www.blum.com/a420



Runner systems



- ▶ TANDEM
- ▶▶ TANDEM 19 mm – hook and peg variant – full extension

TANDEM plus 561F

Webcode
DQHOPA



- Runner for wooden drawers with a panel thickness of 17–19 mm
- Concealed TANDEM full extension with integrated BLUMATIC self-insertion technology
- Suitable for use with TIP-ON – the mechanical opening support system
- Low-friction cylindrical rollers ensure a feather-light glide
- Lift-off stop and height adjustment integrated into runner system
- Tool-free integrated front tilt adjustment

Space requirement

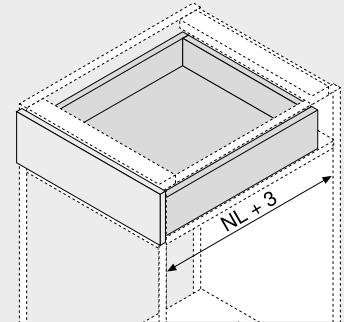

NL Nominal length

Order information

1	Runners left/right	
Nominal length NL (mm)	Dynamic carrying capacity (kg)	
260		561F2601C
310		561F3101C
360		561F3601C
410		561F4101C
460		561F4601C
510		561F5101C
560		561F5601C

The output path can vary depending on the load or the adjustment!

Accessories

4	Front adjuster		
	Colour	Material	Part no.
	Natural	Nylon	295.1000

6a	TIP-ON left/right	
	Dynamic carrying capacity (kg)	Part no.
	30	T55.7150S

Only suitable for TANDEM plus

6b	TIP-ON synchronisation pinion set		
	Colour	Version	Part no.
	RAL 7037 dust grey	Semicircular	T55.000R

6c	TIP-ON synchronisation linkage		
	Cabinet width KB (mm)	Version	Part no.
	Up to 1200	Semicircular	T55.882W

For cutting to size

Starting with cabinet width KB 600 mm

Cutting Internal cabinet width LW – 284 mm

Alternative to 6b | 6c

6d	TIP-ON synchronisation pinion set and shaft		
	Cabinet width KB (mm)	Version	Part no.
	Up to 1400	Round	T55.1089ZR

For cutting to size

Cutting Internal cabinet width LW – 284 mm

Drawer

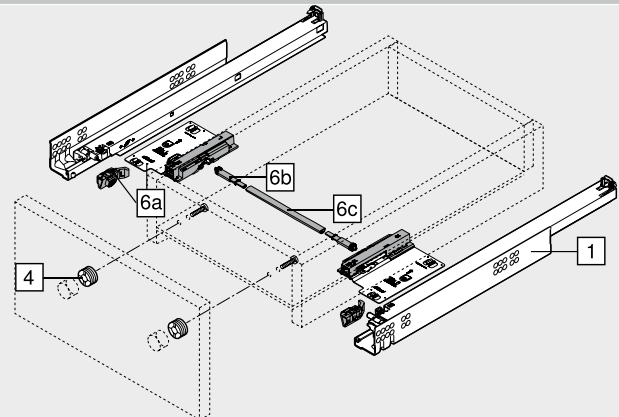

TANDEM plus 561F

Webcode
DQHOPA

Planning

Space requirement in cabinet	Drawer inner drawer	Drawer	Inner drawer
* +1 mm with TIP-ON	SKW Internal drawer width LW Internal cabinet width	SKL Drawer length NL Nominal length	ISKL Inner drawer length SKL Drawer length NL Nominal length X Front thickness * Additional +6 mm with TIP-ON ** Additional +4 mm with TIP-ON

Hole spacing – runners

Nominal length NL (mm)

260	96
310 360	
410	64
460	128
510	
560	

Trigger range

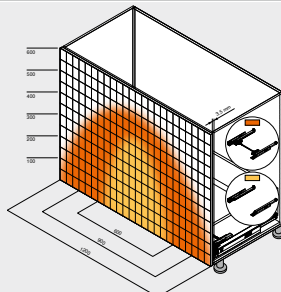

Example for 560F – 30 kg, nominal length NL 500 mm, four sided drawer, with synchronisation

Drawer assembly

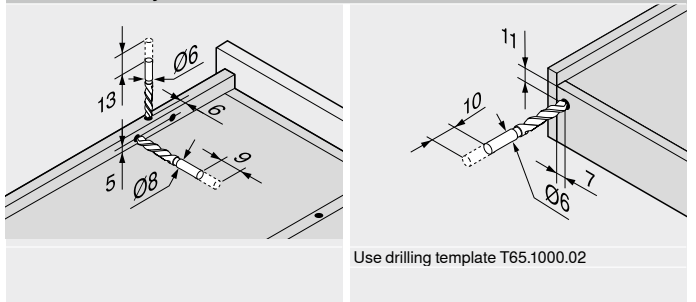

Drawer assembly

Nominal length NL (mm)	Pegs		Lift-off stop X3 (mm)
	X2 (mm)	X3 (mm)	
260	205	185	
310	230	242	
360	275	287	
410	300	344	
460	335	379	
510	360	436	
560	405	481	

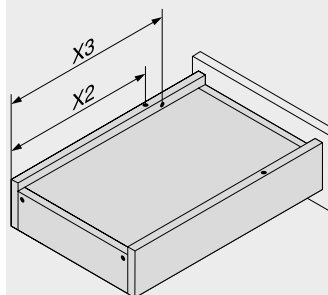

Page instructions

Overview – TANDEM	409	TANDEM 19 mm
CABLOXX	552	
Accessories	444	
Attachment of runners	452	Short-URL
Overview – assembly devices	561	www.blum.com/i011
More technical details	662	



Assembly, removal and adjustment

Short-URL
www.blum.com/a420





- ▶ TANDEM
- ▶▶ TANDEM 19 mm – hook and peg variant – single extension

TANDEM BLUMOTION 551F

Webcode
DQHPEM



- Runner for wooden drawers with a panel thickness of 17–19 mm
- Concealed **TANDEM** single extension with soft end stop when opening and integrated **BLUMOTION** for silent and effortless closing
- Suitable for use with **SERVO-DRIVE** – the electrical opening support system
- Low-friction cylindrical rollers ensure a feather-light glide
- Lift-off stop and height adjustment integrated into runner system

Space requirement

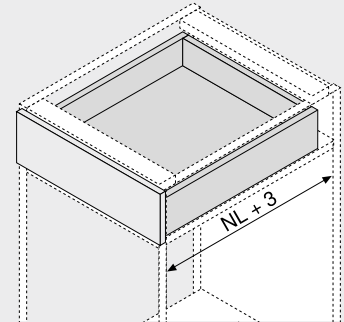

NL Nominal length

Order information

1	Runners left/right	
Nominal length NL (mm)	Dynamic carrying capacity (kg)	
260		551F2601B
310		551F3101B
360		551F3601B
410		551F4101B
460		551F4601B
510		551F5101B
560		551F5601B

Accessories

4	Front adjuster		
	Colour	Material	Part no.
	Natural	Nylon	295.1000

Drawer

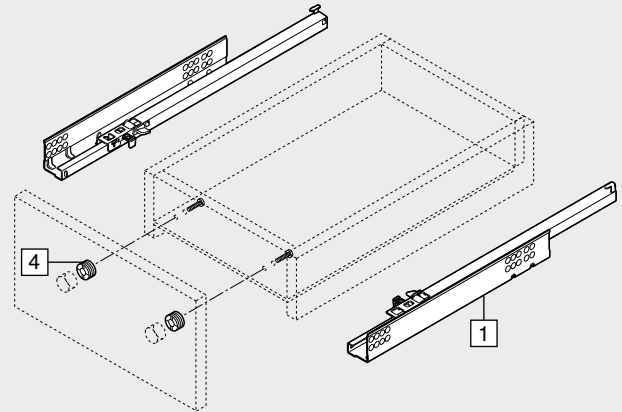

Inner drawer

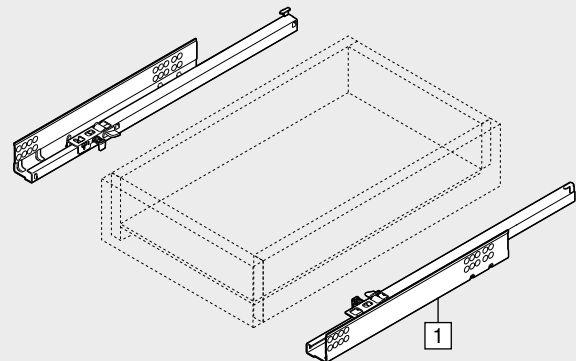

TANDEM BLUMOTION 551F

Webcode
DQHPEM

Planning

Space requirement in cabinet	Drawer inner drawer	Drawer	Inner drawer
A 3 mm distance to interchange with full extension	SKW Internal drawer width LW Internal cabinet width	SKL Drawer length NL Nominal length	ISKL Inner drawer length SKL Drawer length NL Nominal length X Front thickness

Hole spacing – runners

Nominal length NL (mm)

260	
310 360 410	
460	
510	
560	

Drawer assembly

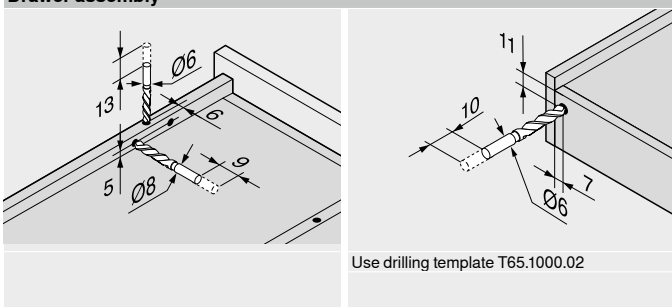

Drawer assembly

Nominal length NL (mm)	Pegs	
	X2 (mm)	X1 (mm)
260	205	185
310	230	210
360	275	255
410	300	280
460	335	315
510	360	340
560	405	385

Page instructions

Overview – TANDEM	409	TANDEM 19 mm
Overview – SERVO-DRIVE for MOVENTO TANDEM	455	
CABLOXX	552	Short-URL
Accessories	444	www.blum.com/i011
Attachment of runners	452	
Overview – assembly devices	561	
More technical details	662	



Assembly, removal and adjustment

Short-URL	www.blum.com/a420
-----------	--



Runner systems



- ▶ TANDEM
- ▶▶ TANDEM 19 mm – hook and peg variant – single extension

TANDEM 551F

Webcode
DQHQ3Y



- Runner for wooden drawers with a panel thickness of **17–19 mm**
- Concealed **TANDEM** single extension with soft end stop when opening and integrated **BLUMATIC** self-insertion technology
- Suitable for use with **TIP-ON** – the mechanical opening support system
- Low-friction cylindrical rollers ensure a feather-light glide
- Lift-off stop and height adjustment integrated into runner system

Space requirement

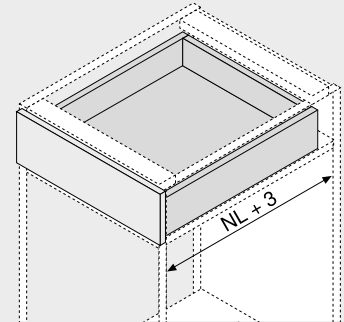

NL Nominal length

Order information

1	Runners left/right	
Nominal length NL (mm)	Dynamic carrying capacity (kg)	
260		551F2601
310		551F3101
360		551F3601
410		551F4101
460		551F4601
510		551F5101
560		551F5601

The output path can vary depending on the load or the adjustment!

Accessories

4	Front adjuster		
	Colour	Material	Part no.
	Natural	Nylon	295.1000

6a	TIP-ON left/right	
	Dynamic carrying capacity (kg)	Part no.
	30	T55.3150S

Only suitable for TANDEM

6b	TIP-ON synchronisation pinion set		
	Colour	Version	Part no.
	RAL 7037 dust grey	Semicircular	T55.000R

6c	TIP-ON synchronisation linkage		
	Cabinet width KB (mm)	Version	Part no.
	Up to 1200	Semicircular	T55.882W

For cutting to size

Starting with cabinet width KB 600 mm

Cutting Internal cabinet width LW – 284 mm

Drawer

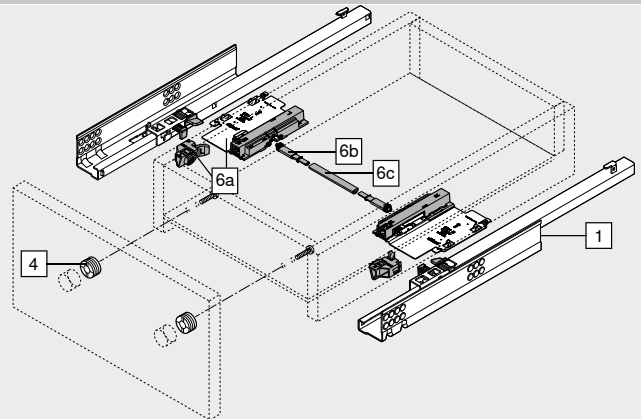

TANDEM 551F

Webcode
DQH3Y

Planning

Space requirement in cabinet

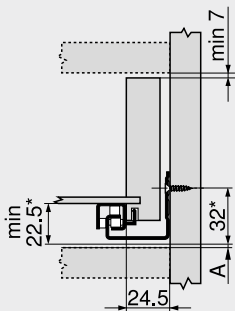

A 5 mm distance to interchange with full extension
* +1 mm with TIP-ON

Drawer | inner drawer

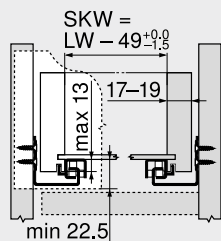

SKW Internal drawer width
LW Internal cabinet width

Drawer

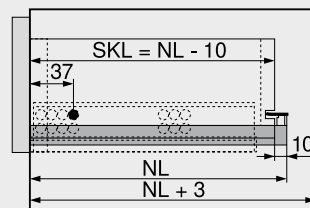

SKL Drawer length
NL Nominal length

Inner drawer

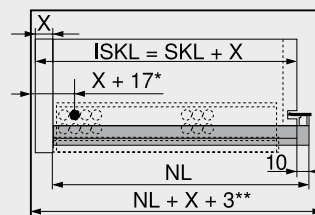

ISKL Inner drawer length
SKL Drawer length
NL Nominal length
X Front thickness
* Additional +6 mm with TIP-ON
** Additional +4 mm with TIP-ON

Hole spacing – runners

Nominal length NL (mm)

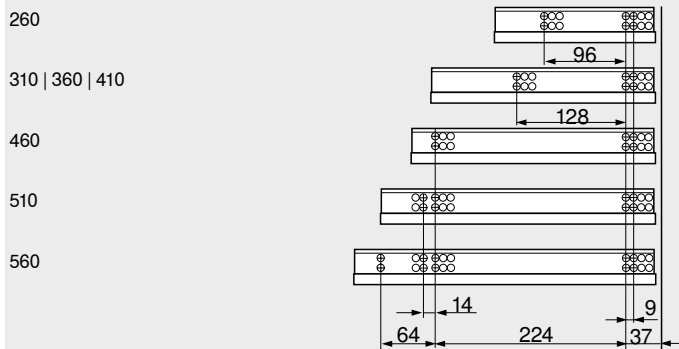

Drawer assembly

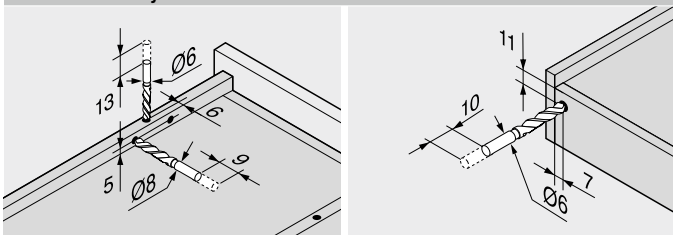

Use drilling template T65.1000.02

Drawer assembly

Nominal length NL (mm)	Pegs		Lift-off stop X1 (mm)
	X2 (mm)	X1 (mm)	
260	205	185	
310	230	210	
360	275	255	
410	300	280	
460	335	315	
510	360	340	
560	405	385	

Trigger range

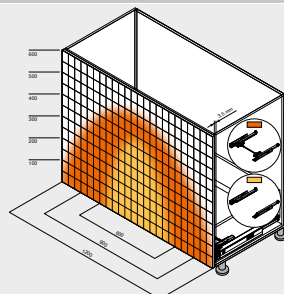

Example for 560F – 30 kg, nominal length NL 500 mm, four sided drawer, with synchronisation

Page instructions

Overview – TANDEM	409	TANDEM 19 mm
CABLOXX	552	
Accessories	444	
Attachment of runners	452	Short-URL
Overview – assembly devices	561	www.blum.com/i011
More technical details	662	



Assembly, removal and adjustment

Short-URL
www.blum.com/a420

