

# TRIOTONE™ CONNEX

## 240V Colour Changeable LED Strip Light



**CODES: SE100390,  
SE100490, SE100590 & SE100690**

### INSTALLATION INSTRUCTIONS

**IMPORTANT:** Please read these instructions before commencing installation and retain for future reference.

#### Components

#### Tools required

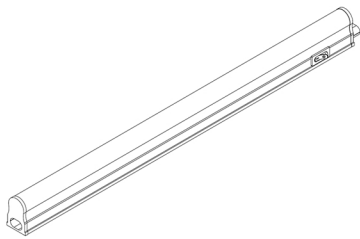

1 x Connex Light

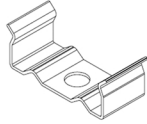

2 x Mounting Brackets

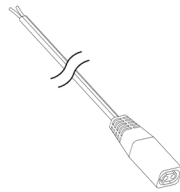

Mains Cable



2 x Screws



1 x Instructions Manual



1 x Pencil



1 x Screwdriver

#### Important Safety Information

Please read these instructions carefully before attempting to install this product. It is advisable to keep these instructions in a safe place for future reference.

We recommend that you consult a qualified electrician. All electrical installation must be carried out in accordance with current IEE wiring regulations (BS7671).

These products must not be modified. If any modification are made, it may invalidate the warranty and may render the product unsafe.

- If in doubt installation must be carried out by a qualified electrician.
- Install on smooth flat surface(s) only.
- Do not exceed or stretch the cable length of each LED wire.
- This product is IP20 Rated.

#### Product Wattage

Product Code	Wattage
SE100390	3W
SE100490	5W
SE100590	9W
SE100690	12W

#### Safety Instructions

1. Before commencing installation or maintenance, isolate the main electrical supply for the appropriate circuit at the fuse board.
2. This product is only suitable for connecting to a 240V 50Hz supply.
3. The lights should be mounted onto a secure surface.
4. Suitable for furniture lighting.

5. When the lamp expires the fitting must be replaced
6. Class III safety extra low voltage (SELV).

#### Waste Electrical & Electronic Equipment (WEEE)

The symbol on the product, or on the document accompanying the product, the crossed out wheellie bin symbol, indicates that this product may not be treated as household waste. Instead it shall be handed over to the applicable collection point for the recycling of electrical and electronic waste.



**RoHS**  
Compliant ✓

