

INSTALLATION
INSTRUCTIONS

TRIOTONE™
COLOUR
SELECTABLE
TRIANGLE LIGHT

CODE: SE21100

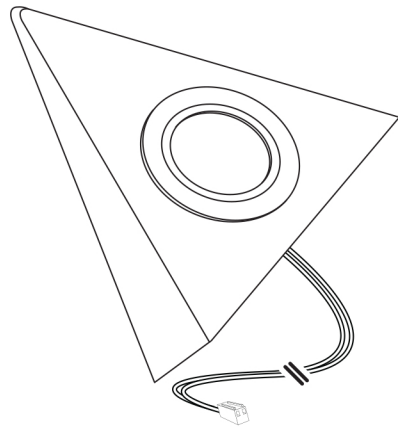

IMPORTANT : please read these instructions before commencing installation and retain for future reference.

Components

Tools required

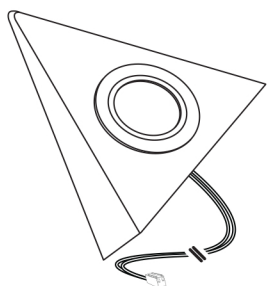

1 x SE21000



2 x Screws

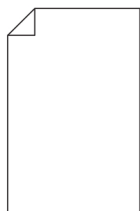

1 x Fitting Instructions



Pencil



10mm
Drill Bit



PZ1 Screw Bit

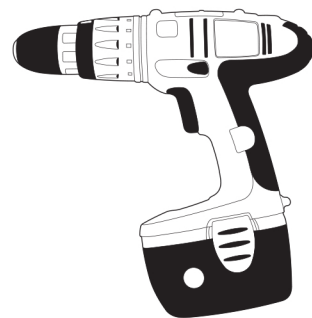

Power Drill

Important safety information

Please read these instructions carefully before attempting to install this product. It is advisable to keep these instructions in a safe place for further reference.

We recommend that you consult a qualified electrician.
All electrical installations must be carried out in accordance with current IEE wiring regulations (BS7671).

These products must not be modified, if any modifications are made, it may invalidate the warranty and may render the product unsafe. These LED lights operate low voltage (24V).

Do not wire the individual LED light fittings directly to the mains. This product is for indoor use only. Keep out of moisture and use only in dry rooms.

- If in doubt installation must be carried out by a qualified electrician.
- Install on smooth flat surface(s) only.
- The Wattage of this product is 1.65W. Make sure that the LED driver used with these fittings has an adequate max wattage.

Safety instructions

1. Before commencing installation or maintenance, isolate the main electrical supply for the appropriate circuit at the fuse board.
2. This product requires a 24V LED driver.
3. The light should be mounted onto a secure surface.

4. Position lights where they will not be exposed to steam or splashes etc.
5. Suitable for furniture lighting.
6. When the lamp expires the fitting must be replaced.
7. Class III safety extra low voltage (SELV).



WW: Warm White (3000K)
NW: Natural White (4000K)
CW: Cool White (5000K)

Note: The fitting is pre-set to warm white (3000K)

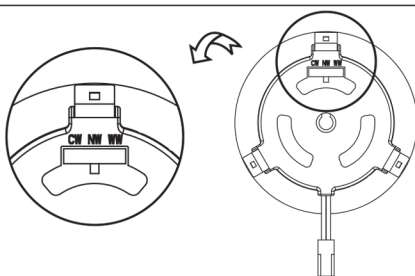

Installation

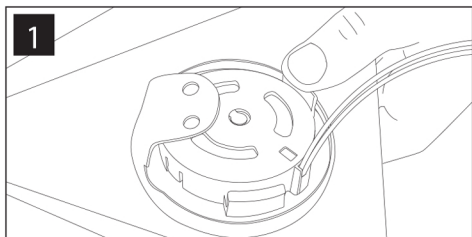

1 Push the clips on the LED light to release the unit from the triangular fitting.

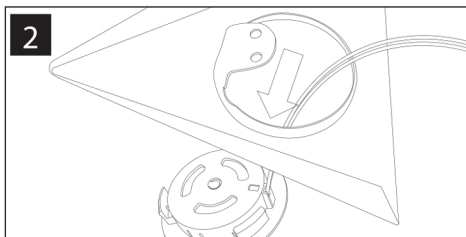

2 Push the LED light through so that the unit and cable are completely free from the triangle casing.

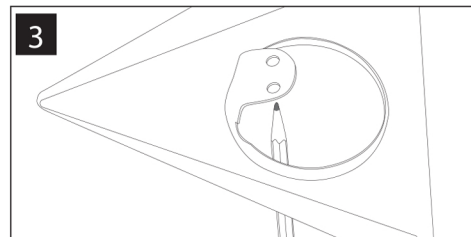

3 Mark the positions of the fixing holes in the desired position underneath the cabinet unit.

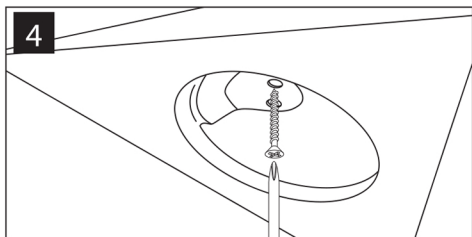

4 Screw the bracket to the bottom of the cabinet.

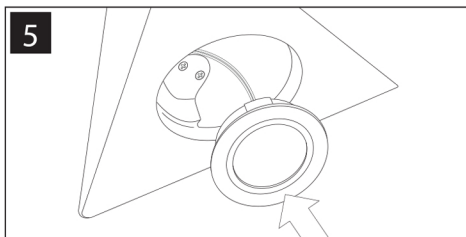

5 When the bracket is secured to the underside of the cabinet unit, re-insert the LED inner unit back into the triangle casing. Push until it clicks into place. Ensure you have selected the required colour temperature before completing this step.

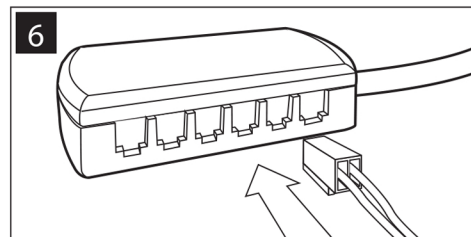

6 Plug the white connector on the end of the cable into the 24V LED driver distributor block. Beware not to exceed the wattage of the LED driver, the max wattage will be displayed on the 24V LED driver and the fitting's wattage requirement will be stated on the item.

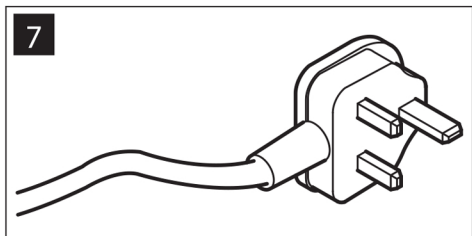

Operation

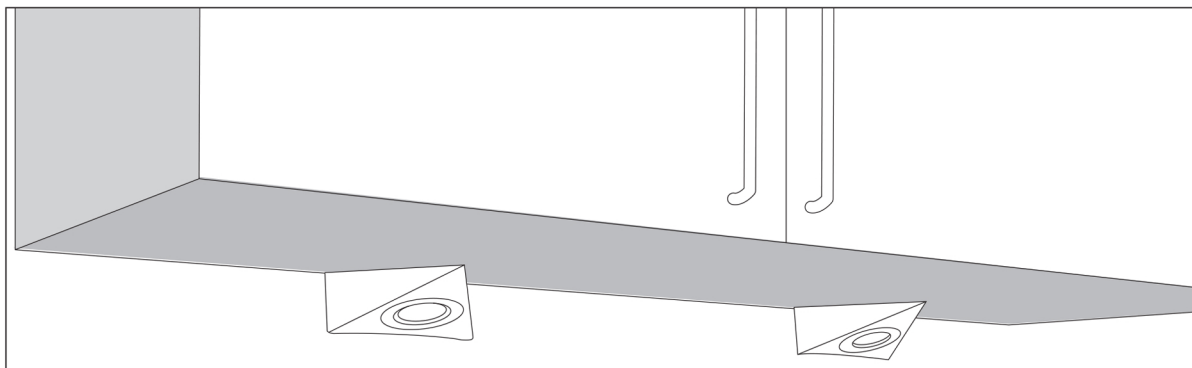

The driver is to be situated at the top of the kitchen wall cabinet and all fittings are to be individually connected back to the distribution ports on the driver.

Maintenance & Care

- Ensure that the power is disconnected prior to cleaning.
- To keep the finish of this product, wipe over with soft cloth periodically.
- Do not use harsh chemical solvents, it may dis-colour or damage the finish.

Sensio House, Unit 7 Speedwell Road, Castleford, West Yorkshire, WF10 5PY.

www.sensio.co.uk

Technical drawings for illustration purposes only, Sensio has the right to change any information without prior notice. Make sure you check all hole cut outs before work commences.