



AVENTOS HK-XS

Small fitting, great convenience

Technical data sheet

www.blum.com

 **blum**[®]

AVENTOS HK-XS



Order specification

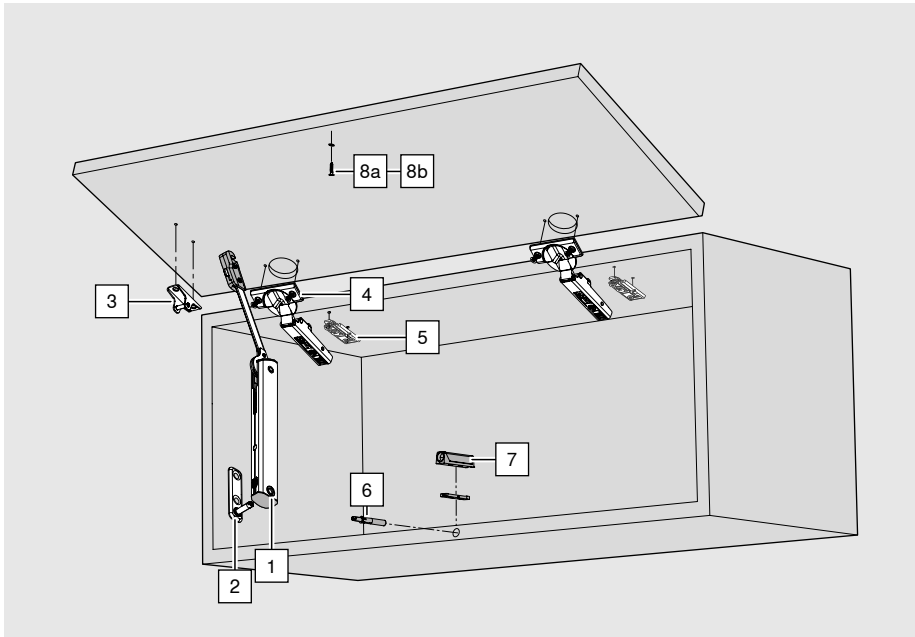

- well suited for wall cabinets and larder units
- cabinet heights of 240 to 600 mm
- Interior depth of 100 mm minimum
- closes silently and effortlessly in conjunction with CLIP top BLUMOTION hinges
- can be combined with TIP-ON to open handle-less fronts
- Well-balanced quality of motion due to light operating forces, a variable stop and BLUMOTION
- Simple and predominantly tool-free assembly and easy adjustment
- Symmetrical lift mechanism – can be used on one or two sides
- High-quality design



Power factor LF = cabinet height KH (mm) x front weight incl. double handle weight (kg)

□ Standard

■ TIP-ON

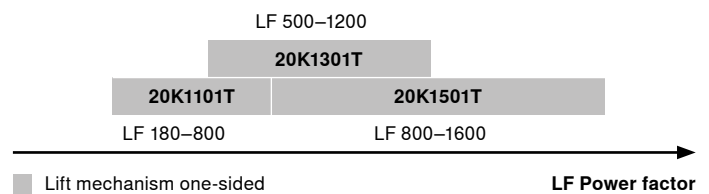
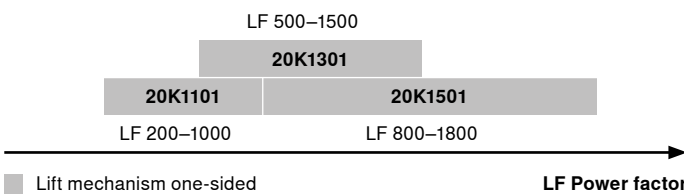

Note: the power factor is doubled when used on two sides

A trial application is recommended when you are in a borderline area of the individual lift mechanism.

□	1	Symmetrical lift mechanism
	Power factor	
	200–1000	20K1101
	500–1500	20K1301
	800–1800	20K1501
	Opening angle 105°*	

■	1	Symmetrical lift mechanism
	Power factor	
	180–800	20K1101T
	500–1200	20K1301T
	800–1600	20K1501T
	Opening angle 105°*	

* For hinges with smaller opening angles, these are limited by the hinges.

AVENTOS HK-XS



Order specification

	2 Cabinet fixing		
	Nickel plated steel		
	Screws		20K5101
	Knock-in		20K5131
	EXPANDO		20K51E1

	3 Front fixing bracket		
	Nickel plated steel		
	Screws ¹⁾		20K4101
	Knock-in		20K4131
	EXPANDO		20K41E1
	Narrow aluminium frames		20K4101A

	4 Recommended hinges²⁾		
	CLIP top BLUMOTION 110°		
	Screws	With spring	2x* 71B3550
	Knock-in	With spring	2x* 71B3580
	INSERTA	With spring	2x* 71B3590
	CLIP top 110° for TIP-ON		
	Screws	Unsprung	2x* 70T3550.TL
	Knock-in	Unsprung	2x* 70T3580.TL
	INSERTA	Unsprung	2x* 70T3590.TL

	5 Recommended mounting plate		
	Standard mounting plates, spacing depends on the top gap		
	Fixing	Spacing	
	Screws	0 mm	2x* 175H3100
	Knock-in	0 mm	2x* 177H3100
	EXPANDO	0 mm	2x* 177H3100E

	6 TIP-ON		
	Nylon		
	SW, PG, TS ³⁾		
	For drilling		
	Short version, length: 50 mm		956.1002

	7 Horizontal adapter plate		
	Nylon, screw-on		
	NI-L, SW, PG, TS ³⁾		
	Short version		956.1201

	8a Screw-on catch plate		
	Steel, nickel plated		
	Ø 15 mm		955.1008S
	For hard surfaces and/or MDF, Ø 2.5 mm pre-drilling and countersinking, if required		

	8b Press-in catch plate⁴⁾		
	Steel, nickel plated		
	Ø 11.5 mm		
	Pre-drilling Ø 5 mm		955.1008D

	Bit PZ cross slot		
	Size 2, length 39 mm		BIT-PZ KS2

Accessories CLIP top BLUMOTION 110°/CLIP top 110°

	Hinge arm cover cap		
	Print/Stamp	Part No.	
	Plain		70.1503
	Stamped	Blum	70.1503.BP

	Hinge boss cover cap		
	CLIP top BLUMOTION		70T3504
	CLIP top		70T3504

	Hinge boss spacing		
	1.5 mm	Screw-on	
	CLIP top BLUMOTION		70T3507.21

	Opening angle stop 86°		
	Nylon	Black	70T3553

	Chipboard screws		
	3.5 x 15 mm		609.1500
	3.5 x 17 mm		609.1700

	Insertion ram		
	Boss	Knock-in	
	Nylon		MZM.0040

¹⁾ Use 2 chipboard screws (609.1x00) for wooden fronts. Use 2 countersunk self tapping screws (660.0950) for wide alu frames

²⁾ As an alternative, you can also use CLIP top BLUMOTION hinges, 95° profile door hinges, 95° aluminium frame hinges or CLIP top 107° or 110° hinges, 95° profile door hinges, 95° aluminium frame hinges combined with clip-on BLUMOTION 973A or unsprung (TIP-ON). See Blum catalogue.

³⁾ NI-L nickel finish, SW silk white, PG platinum grey, TS terra black

⁴⁾ Note: the glue-on catch plate should not be used in combination with TIP-ON for AVENTOS HK-XS.

* Number of hinges, see front assembly

Cabinet positions for lift mechanisms

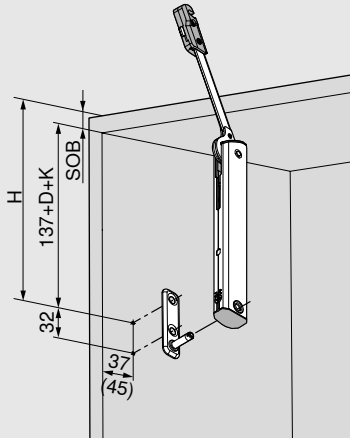

$$H = 137 + D + K + SOB$$

D mounting plate spacing

K Hinge crank

Horizontal hinge arm 0 mm

Cranked hinge arm 9.5 mm

Double cranked hinge arm 18 mm

SOB Top panel thickness

Space requirement

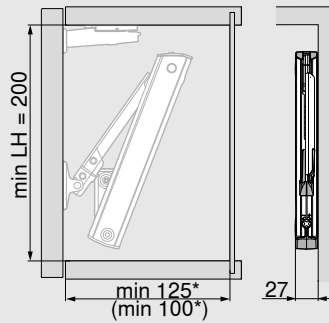

LH Internal cabinet height

* min. 200 mm with visible wall hanging bracket

Space requirement

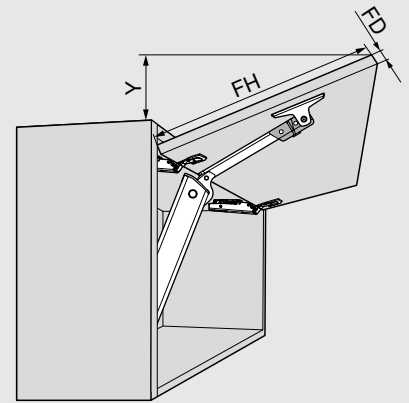

$$Y = (FH - a) \times 0.3$$

FD (mm)	16	19	22	24
a (mm)	45	34	23	15

FD Front thickness

FH Front height

Front assembly

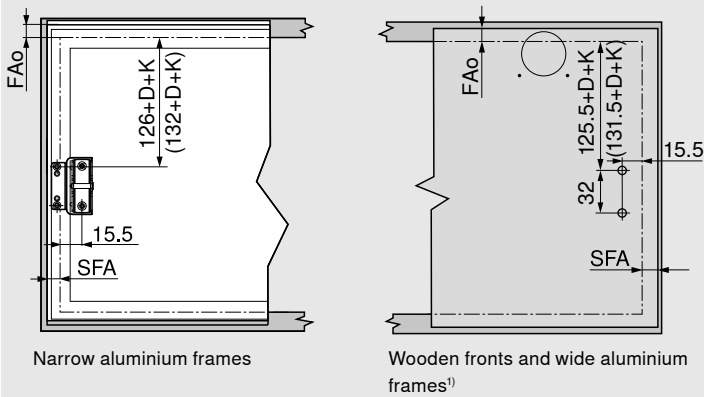

Narrow aluminium frames

Wooden fronts and wide aluminium frames¹⁾

Ø 3.5 x 15 mm

FAo Upper front overlay

SFA Side front overlay

Number of hinges

3 hinges starting at cabinet width 900 mm and/or power factor 1.800

4 hinges starting at cabinet width 1.200 mm and/or power factor 2.700

¹⁾ Use 2 chipboard screws (609.1x00) for wooden fronts. Use 2 countersunk self tapping screws (660.0950) for wide alu frames

Planning for narrow aluminium frames

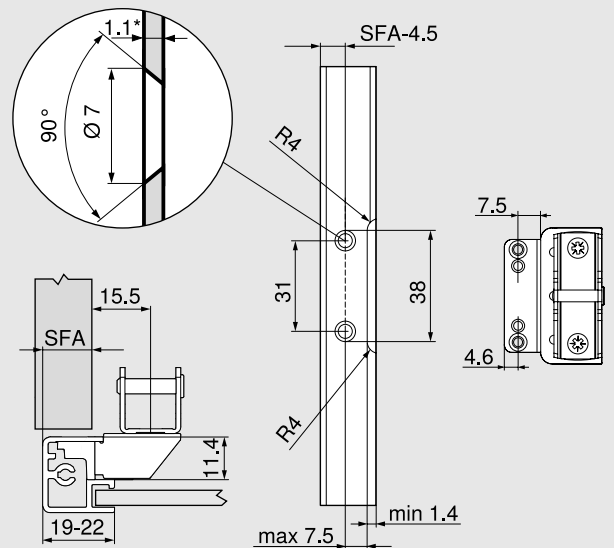

For frame frieze width 19 mm:
SFA of 11-18 mm possible

SFA SFA Side front overlay

R Radius

* When changing material thickness, adjust the assembly dimensions accordingly.

() Special drilling positions for a minimum internal depth of 100 mm

i To ensure optimal motion, use standard drilling positions for a minimum internal depth of 125 mm

AVENTOS HK-XS



Planning

Cornice and crown moulding clearance

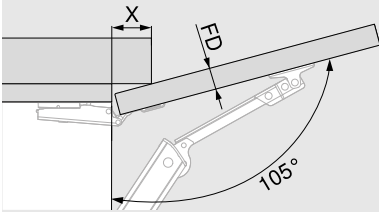

FD (mm)	16	19	22	24
X (mm)	45	34	23	15
FD	Front thickness			

Minimum gap

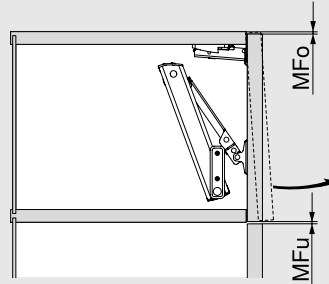

MFu Minimum gap at the bottom (1.5 mm)
 MFo Minimum gap at the top depending on hinge used – see Blum catalogue

CLIP top BLUMOTION 110°/ CLIP top 110°

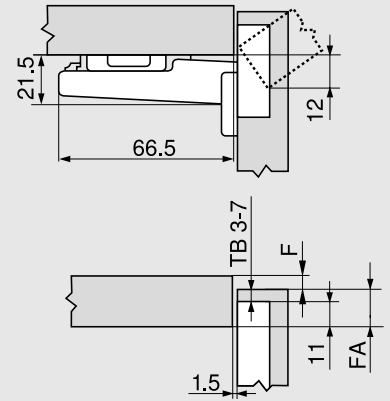

F Gap
 FA Front overlay
 TB Drilling distance

Minimum gap (F) for fronts with a front radius (R = 1 mm) based on the factory setting for CLIP top BLUMOTION 110°/ CLIP top 110°

		Front thickness FD											A trial application is recommended
		16	18	19	20	21	22	23	24	25	26	28	
 Drilling distance TB	3	0.5	0.8	1.0	1.2	1.5	1.8	2.2	2.7	3.5	4.3		
	4	0.5	0.8	1.0	1.2	1.4	1.7	2.0	2.5	3.1	3.8		
	5	0.5	0.8	0.9	1.2	1.4	1.7	2.0	2.4	2.9	3.4		
	6	0.5	0.8	0.9	1.2	1.3	1.6	1.9	2.3	2.7	3.2		
	7	0.5	0.8	0.9	1.1	1.3	1.6	1.9	2.2	2.6	3.0		
		Additional for + 2 mm side adjustment											
		+0.2	+0.4	+0.4	+0.5	+0.5	+0.5	+0.5	+0.5	+0.5	+0.5		

CLIP top BLUMOTION 110°/CLIP top 110°

Drilling distance TB

		Front overlay FA																
		5	6	7	8	9	10	11	12	13	14	15	16	17	18			
0												3	4	5	6	7		
3								3	4	5	6	7						
6				3	4	5	6	7										
9	3	4	5	6	7													
 Mounting plate																		

Fixing position

TIP-ON short version

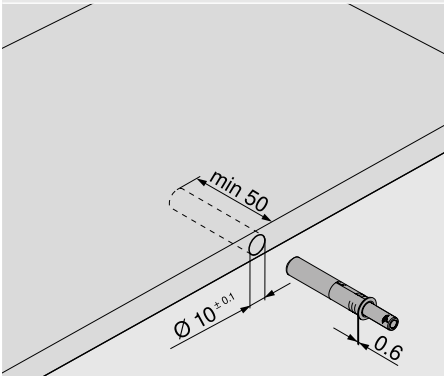

Horizontal adapter plate short

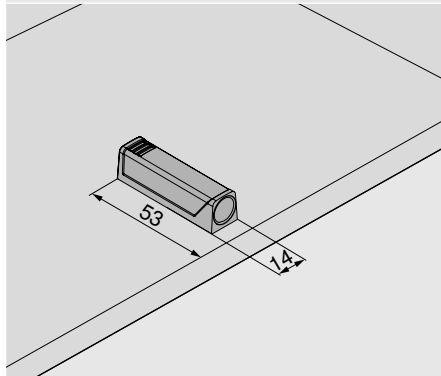

Installation dimensions

TIP-ON Short version

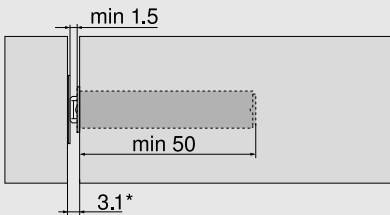

* min. 3.2 mm with press-in catch plate

Horizontal adapter plate short

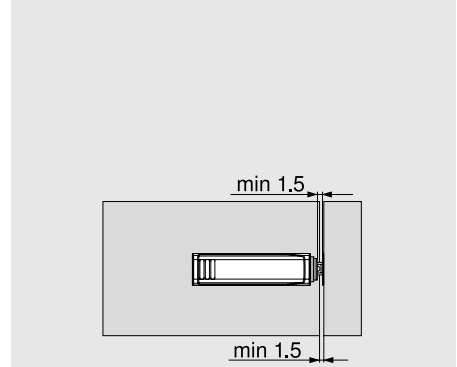
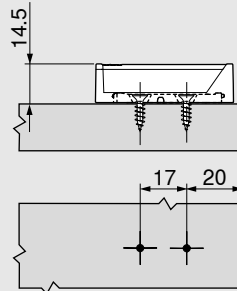

Factory setting = 2 mm

Screw-on catch plate planning

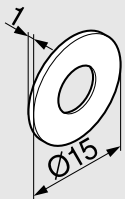

For drilling

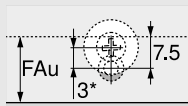

Inline adapter plate

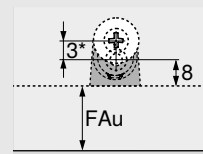

FAu = Lower front overlay

* We recommend setting back the positioning of TIP-ON by 3 mm for the screw-on catch plate.

Note: the glue-on catch plate should not be used in combination with TIP-ON for AVENTOS HK-XS.

Press-in catch plate planning

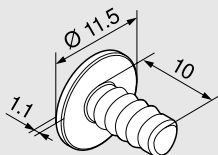

For press-in

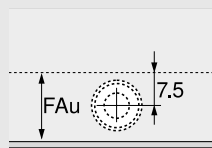

Inline adapter plate

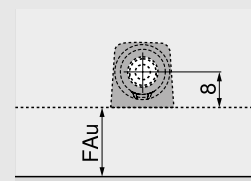

FAu = Lower front overlay

Front assembly

Front fixing bracket

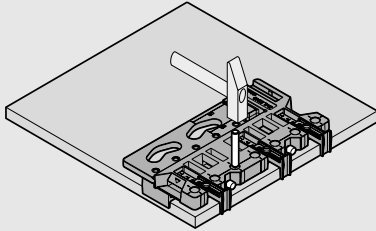

Universal drilling template

ZML.0040

Hinges

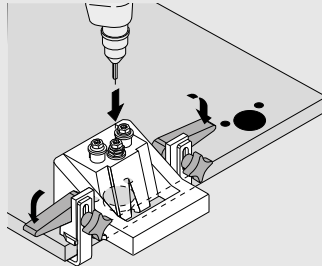

ECODRILL

M31.1000

Hinges

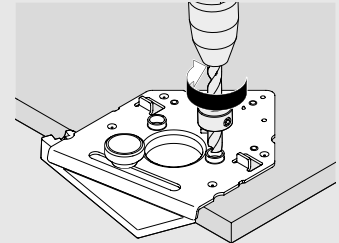

Drilling template for hinges

Ø 8 mm / Ø 2.5 mm

65.059A

Drilling template for hinges

Ø 2.5 mm

65.055A

Cabinet assembly

Cabinet assembly

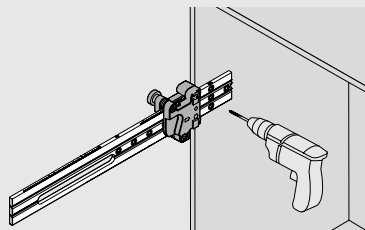

Universal-single template

65.1051.02

Mounting plate

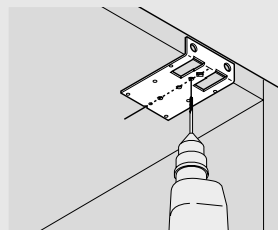

Template

65.5300

Can also be used for cabinet fixing

TIP-ON assembly

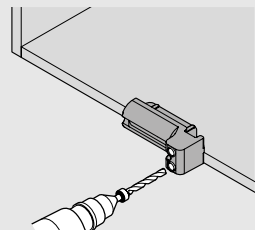

TIP-ON drilling template

For drilling

65.5010

Can also be used for TIP-ON for AVENTOS