

Assembly guide Toughened Splashback

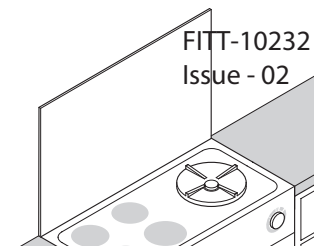

Component parts



2 x Spacers 3 mm thick

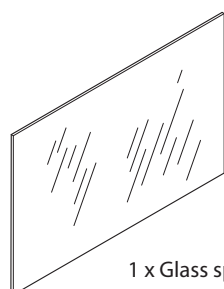

1 x Glass splashback

Please note: Glass is toughened and cannot be cut.

Tools required (Not Supplied)

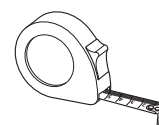
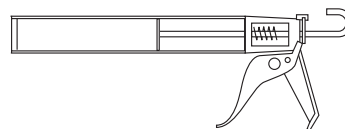

Sealant - only use CLEAR low modular neutral cure silicone (BS 5889A or BS EN ISO 11600)

- Make sure all the components are included before you start.
- The number for technical support is at the bottom of the page.
- Don't rush!
- Read the instructions first.
- Assemble in the stages shown.
- Keep the fittings together to avoid loss.
- Have fun.

Before you start... Check the pack and make sure all the components are included – if not call the Helpline on **01788 548855** and our team will get things sorted. When you are ready to start make sure you have the right tools to hand, plenty of space and a clean dry area for building. Don't rush, read the instructions first and run through the sequence before you begin. Assembly should be done in the stages shown in the following diagrams, keeping fittings together to avoid loss. Do not over tighten screws.

Cleaning - Use mild soap and water only. Do not use abrasive cleaners.

Please note: If this product has been stored or transported in cold conditions, it is essential to ensure that the adhesive backing has been allowed to warm naturally (without the aid of artificial means e.g radiator, blow torch, heat gun or hair dryer) for 4-6 hours prior to fitting and must not be fitted into a room that has an ambient temperature below 10°C/50°F. This ensures that the adhesive pad is giving its maximum amount of adhesion when being fitted. If these steps are not followed this could result in the splashback either coming away from the wall or not fixing to the wall correctly.

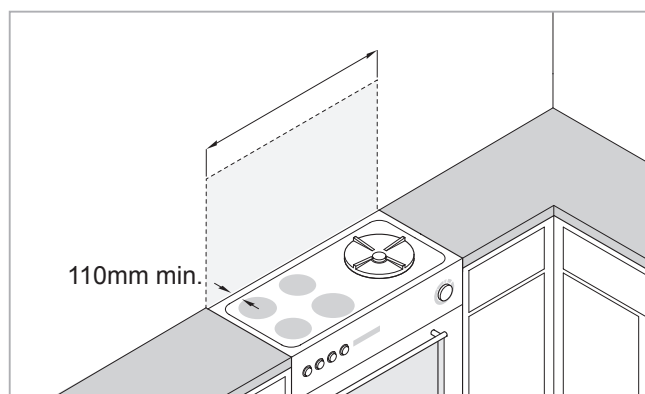

- 1 Firstly check the dimensions. The minimum distance from the back of the rear hobs to the wall should be no less than 110 mm.

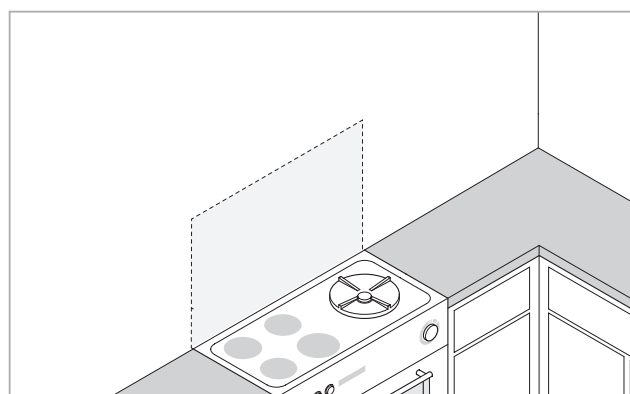

- 2 Ensure that the wall being fixed to is completely flat, non porous, dry, dust and grease free. PLEASE NOTE: This product should not be fitted over any existing tiling or splashbacks.

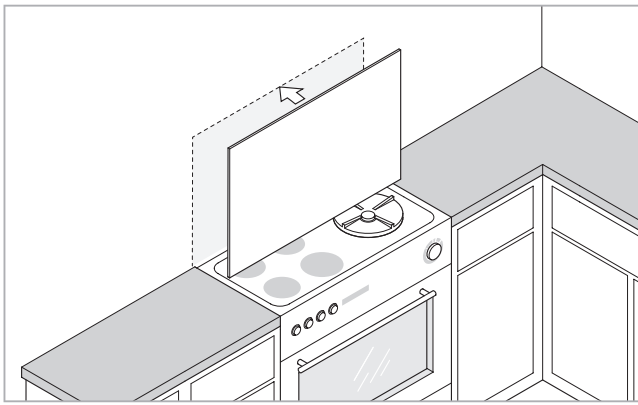

- 3 Firstly offer up the back of the Splashback to the worktop / wall to check the fit. Use the spacers provided to achieve a good fit. There needs to be a gap of 2-3 mm around all 4 sides.

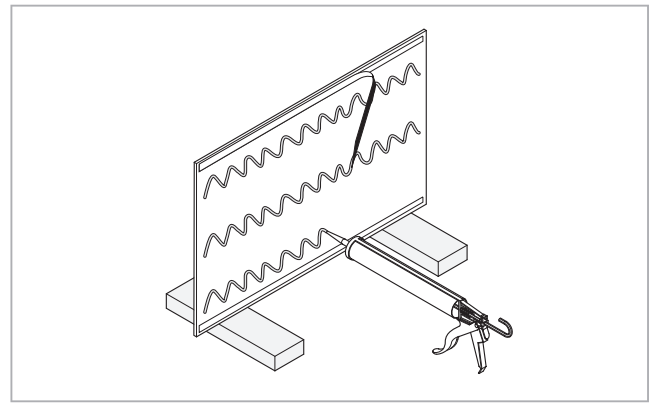

- 4 Take the Splashback away from the wall making sure to keep all corners safe from hard surfaces. Apply a generous amount of silicone to the back of the splashback, making sure not to go too near the edges. Remove the covering from the self adhesive backing.

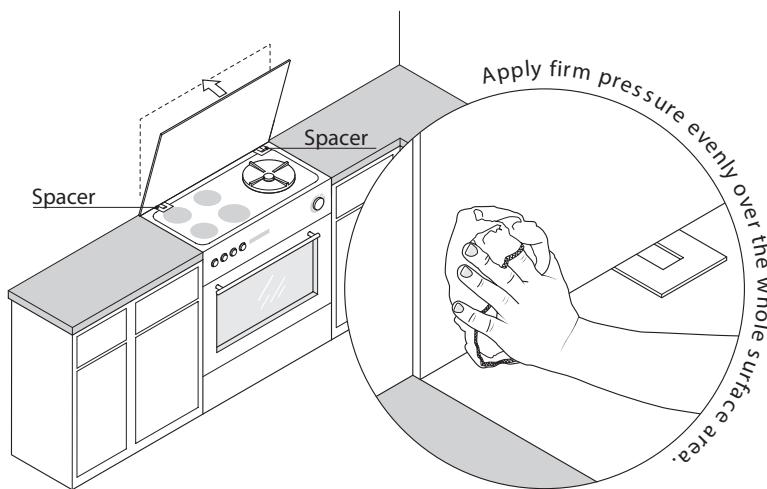

- 5 Place the bottom edge of the splashback to the back lip of the worktop / wall on the spacers provided then push the splashback to the wall and apply firm pressure evenly over the whole surface area. Ensure that the 3mm spacers are left while the sealant bonds to the wall. Finally after 2-3 hours remove the spacers.

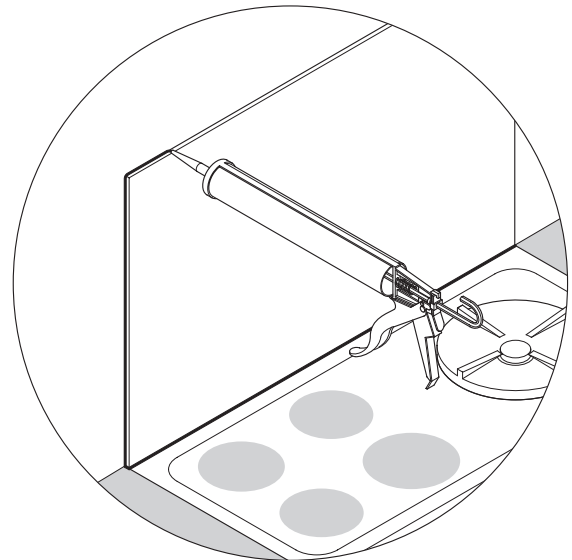

- 6 The 4 exposed edges of the Splashback must be sealed with a bead of silicone sealant no less than 2-3 mm in thickness.

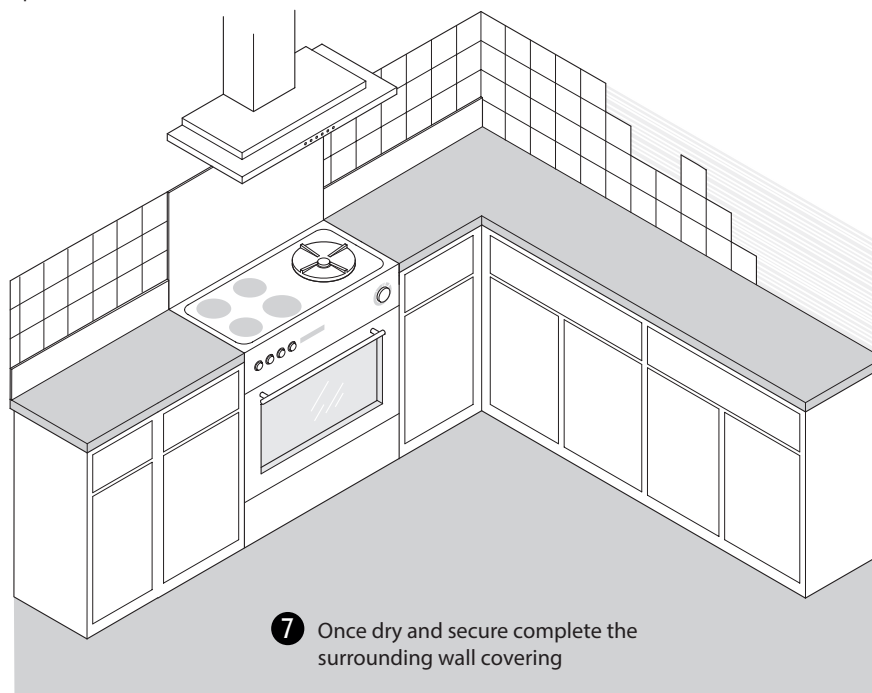

- 7 Once dry and secure complete the surrounding wall covering